

Quick Inch

Economy Task Light

T5 Fluorescent

Q100/200 Series

Project

Type

Project Location

Catalog #

Description

The Quick Inch is priced comparable to "commodity" grade undercabinet fixtures, yet offers the superior quality and value you expect from Philips Day-Brite. Durable and attractive extruded aluminum construction is combined with quick installation features. A single Quick Inch installs in less the 5 minutes, vs 1/2 hour for traditional undercabinet fixtures.

Additional Features:

- Sleek, curved profile visually integrates with cabinetry.
- Removable rear access cover, external mounting ears and factory pre-lamping allow installation without opening the wireway or lamp compartment.
- Supplied with push-in ROMEX® connector. 7/8" rear and side knockouts also accept standard trade-size electrical fittings for direct-wiring with flexible metal conduit.
- Acrylic diffusers remain pliable and resist discoloration.
- On-off rocker switch provided as standard equipment.
- Cordset accessory field-converts fixture for portable, plug-in installation.
- 3000K pre-heat T5 lamps provided.



Specifications

Construction .060" extruded aluminum housing with injection molded poly-carbonate end-caps.

Electrical/Lamps Fully electronic 8W and/or 13W class "P" ballast. Rocker switch is supplied as standard equipment. 120V only. Not available for 277 or 347V applications.

F8T5 or F13T5 warm white 3000K lamps installed in each fixture. 7,500 hour rated life.

Diffuser Translucent opal, extruded from acrylic. Warranted to remain pliable and not to discolor.

Finish White polyester resin powder coat with minimum reflectivity of 87%. End caps are molded in white.

Installation Features Removeable rear access door allows wiring without removing the wireway. Push-in fitting for non-metallic cable and push-in electrical connectors for supply wires are provided. 7/8" knockouts on end and in rear also accept standard trade size electrical fittings for use with flexible metal conduit.

Labels cULus Listed for use in damp locations.

Ordering Information

CATALOG #	LAMPS	WIDTH	DEPTH	LENGTH*
Q108-RSW-L-ECB	1/F8T5	4 5/8"	1 9/16"	12 1/2"
Q113-RSW-L-ECB	1/F13T5	4 5/8"	1 9/16"	21 1/2"
Q116-RSW-L-ECB	2/F8T5	4 5/8"	1 9/16"	24 3/4"
Q138-RSW-L-ECB	1/F8T5, 1/F13T5	4 5/8"	1 9/16"	33 3/4"
Q213-RSW-L-ECB	2/F13T5	4 5/8"	1 9/16"	42 3/4"

PHILIPS
Day-Brite

PHILIPS
CFI

Quick Inch

Economy Task Light

T5 Fluorescent

Q100/200 Series

Project

Type

Dimensional Data

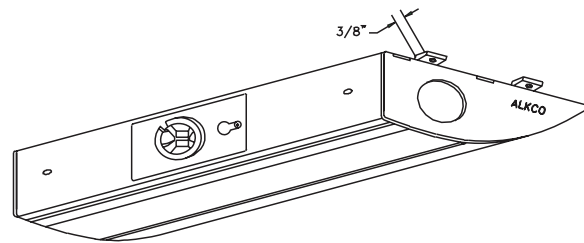
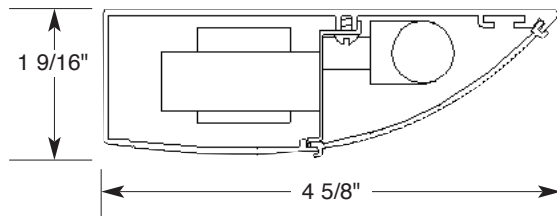

Photometrics

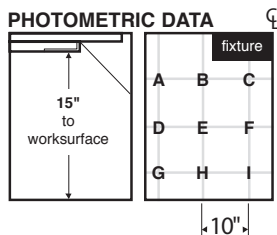

CATALOG#	FOOTCANDLES ONWORKSURFACE								
	A	B	C	D	E	F	G	H	I
Q108RSWL	5	12	26	4	8	12	1	4	5
Q113RSWL	11	31	50	8	17	22	3	8	10
Q116RSWL	13	31	46	8	16	21	3	6	9
Q138RSWL	23	51	62	13	27	30	5	10	13
Q213RSWL	40	70	73	21	36	36	8	14	17

 Some luminaires use fluorescent or high intensity discharge (HID) lamps that contain small amounts of mercury. Such lamps are labeled "Contains Mercury" and/or with the symbol "Hg". Lamps that contain mercury must be disposed of in accordance with local requirements. Information regarding lamp recycling and disposal can be found at www.lamprecycle.org



© 2014 Koninklijke Philips N.V. All rights reserved.
Specifications are subject to change without notice.
www.philips.com/luminaires

A8-0 07/14 page 2 of 2

Philips Lighting
North America Corporation
200 Franklin Square Drive
Somerset, NJ 08873
Tel. 855-486-2216

Imported by: Philips Lighting,
A division of Philips Electronics Ltd.
281 Hillmount Rd,
Markham, ON Canada L6C 2S3
Tel. 800-668-9008