

Universal Wall LWBW Series

Page 1 of 2

Wall Mounted Fluorescent, 7-5/8" Width, 24", 36", 48" Lengths
Uplight/Downlight or Downlight Only, 1 or 2 Lamp T8

Features

- Universal luminaire that has uplight/downlight or downlight only capabilities on the same fixture
- Low brightness controlled uplighting/downlighting
- Low brightness linear prismatic virgin acrylic refractor
- Slim 3-1/16" depth
- Nominal 2', 3' and 4' lengths
- 65.2% efficient (T8 lamps, uplight/downlight)
- 62.4% efficient (T8 lamps, downlight only)
- Invisible steel latches align refractor to housing
- Individual or continuous rows
- For over mirror, over bed, corridor, stairwell and bulletin board applications

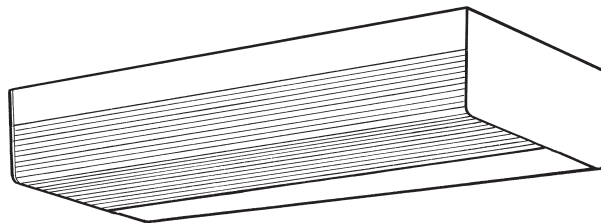

Dimensions

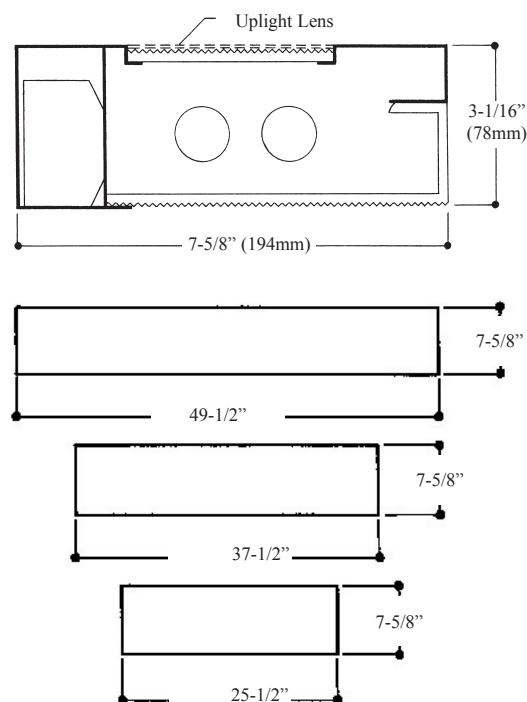
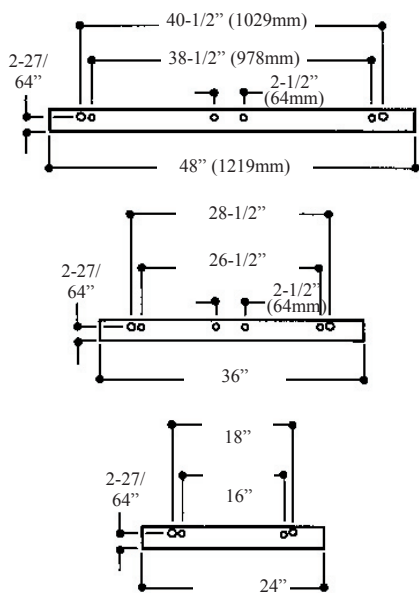

Features

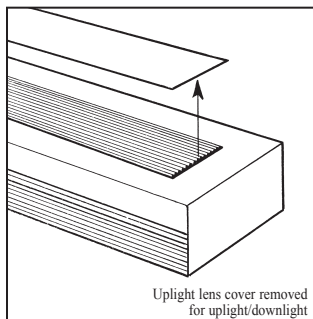
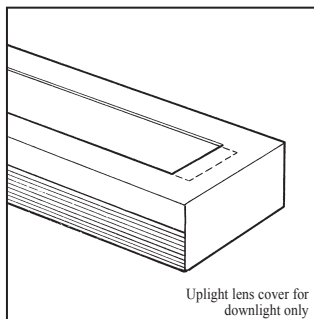

Job Information

Type:

Job Name:

Cat. No.:

Lamp(s):

Volts/Ballast:

CFI Fluorescent - A Division of Canlyte

www.canlyte.com

Technical Information: (613) 938-6221 • Fax (613) 938-9576

525 Education Road, Cornwall, ON K6H 6C7

We reserve the right to change details of design, materials and finish.

Copyright 2003 Lightolier

Folio U-I20-17-04

CFI FLUORESCENT

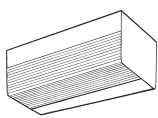

Universal Wall LWBU Series

Page 2 of 2

Wall Mounted Fluorescent, 7-5/8" Width, 24", 36", 48" Lengths
Uplight/Downlight or Downlight Only, 1 or 2 Lamp T8

Photometry Model No. LWBU232UNVSO (Uplight/Downlight)

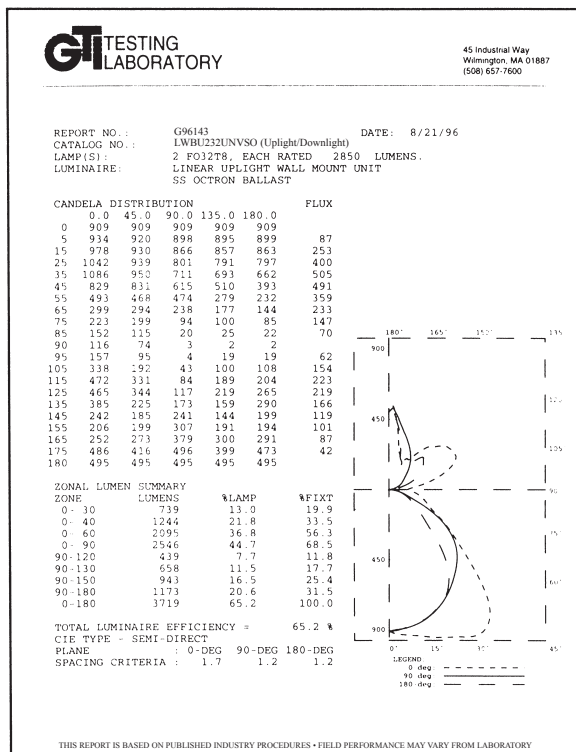

Photometry Model No. LWBU232UNVSO (Downlight)

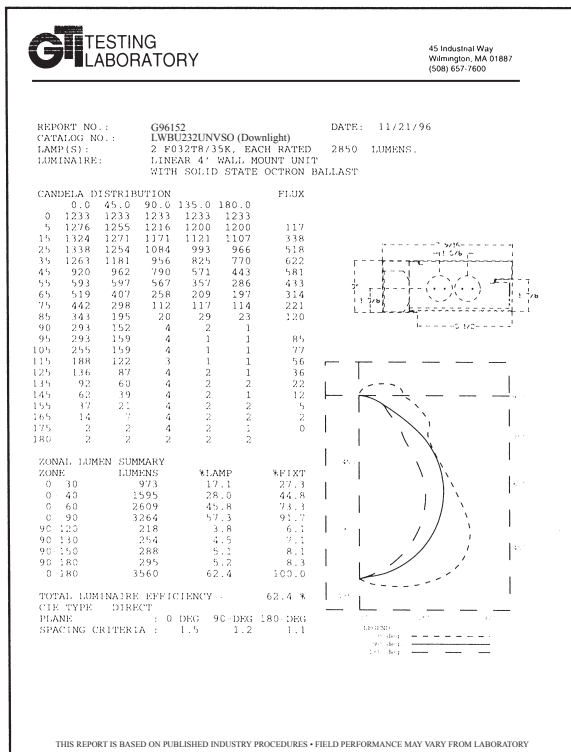

Ordering Information

Explanation of Catalog Number. Example: LWBU232120SO

| | | | | | |
|--|--|--|-------------------------------|--|---|
| LWBU | 2 | 32 | 120 | SO | |
| LWBU Universal Wall Mounted White Body Fluorescent Uplight/Downlight or Downlight Only | Lamp Quantity: 1 = 1 Lamp 2 = 2 Lamp | Lamp Fixture Length: 17=T8, 2' Length 25=T8, 3' Length 32=T8, 4' Length | Voltage: 120 277 347 | Ballast Type: <20THD <10THD 1 & 2 Lamp Elec. (T8) SO* HI* LOL T8 Dimming PS - *Instant Start Standard Other dimming options. Consult factory. | Options: Add appropriate suffix to catalog no, ie: (O) |

Options/Accessories

Radio Interference Filter: 120 or 277 volt, 50 or 60 Hz. One per fixture. Suffix: R.

Emergency Power Pack: Factory installed emergency power pack includes charger and inverter concealed in fixture channel. Upon loss of AC power, operates one lamp at reduce light. Suffix: O.

Electrical Wiring Options: Consult factory.

Note: Consult factory for availability of options for nominal 2' long fixtures.

Specifications

Materials: Chassis parts are die-formed code gauge cold rolled steel.

Refractor—one-piece virgin acrylic.

Finish: Chassis exterior—white baked acrylic enamel. Cavity—white baked acrylic enamel minimum 86% reflectance. Phosphate undercoating.

Refractor (downlight): One-piece injection-molded, low brightness linear prismatic virgin acrylic refractor.

Specifications (continued)

Electrical: Thermally protected class "P" ballast C.B.M. approved, non PCB. If K.O. is within 3" of ballast, use wire suitable for at least 90°.

Labels: I.B.E.W./UL and ULc Listed.

Job Information

Type:

CFI Fluorescent - A Division of Canlyte
www.canlyte.com

Technical Information: (613) 938-6221 • Fax (613) 938-9576
525 Education Road, Cornwall, ON K6H 6C7

We reserve the right to change details of design, materials and finish.

Copyright 2003 Lightolier

Folio U-120-17-04

CFI FLUORESCENT