

# CM8S

## 8" Metal Slope Ceiling Plaster Frame



Catalog Number: \_\_\_\_\_

Type: \_\_\_\_\_

Project: \_\_\_\_\_

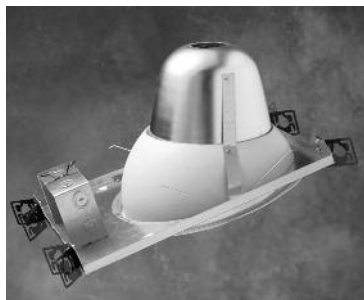

Shown with sloped ceiling cone and trim

### Features

- Precision die-stamped plaster frame of 20 gauge galvanized steel (aperture ring is constructed from 18 gauge galvanized steel).
- Frames can be installed before lamp source or wattage has been determined.
- Plaster frame contains an integral large 47 cubic inch junction box constructed of .063" galvanized steel.
- The frame is secured by use of new adjustable spring steel butterfly brackets that accommodate CH24 or CH48 channel bar hangers, BH3 flat bar hangers or 1/2" EMT conduit.
- Sloped Ceiling frame will not work with Emergency Compact Fluorescent or HID electrical systems.
- Frame is vertically adjustable to accommodate various mounting heights.
- Frame can be supported with aircraft cable where required.
- Suitable for installation in air-handling systems.
- For use with C1 Slope Ceiling Reflectors only, i.e. V85SR10.
- Rated for use in Non-IC applications.

## C1 SYSTEM

There are three components to the Capri One (C1) System. The first component is the plaster frame, the second is an electrical system, and the third is a trim. Use this specification sheet to order the CM8S metal plaster frame only. Use the CM8 series specification sheets to order a complete fixture. Bar hangers are ordered separately.

### Sloped Ceiling Frames

Metal sloped frames can be ordered for 8" or 10" apertures. The C1 system is unique. C1 plaster frames can be installed even before a choice of electrical system is made.

### Electrical Systems

A wide variety of electrical systems are available for use on all C1 plaster frames. Capri One electrical systems are completely interchangeable between all frame sizes, apart from a few wattage restrictions. Electrical connections are made through a single junction box door, which allows all electrical systems to snap easily into place on the frame. All Capri One electrical systems come with pre-installed quick connectors for fast and simple electrical splices. Electrical systems may be ordered separately, or together with a frame.

### Trims

Trims are low iridescent semi-specular aluminum, and come standard with a separate, white polycarbonate trim ring. A wide selection of trims can be ordered with lenses or baffles, or lensed and baffled inserts can be purchased as accessories for installation at a later time if desired. Many C1 trims are listed for use in wet location areas. Trims are held in place with expandable torsion springs to ensure a flush finish along the ceiling. Trims may be oriented 180° horizontally on the CM8S frame.

### ORDERING EXAMPLE:

#### FRAME

**CM8S\***  
C1 Sloped Ceiling Metal Plaster Frame  
Suitable for use in air-handling spaces.

#### ELECTRICAL SYSTEM

**FV26/32/42U**  
Operates 1-26W, 1-32W or 1-42W compact fluorescent vertical unit with 120V-277V electronic ballast.

#### TRIMS

**V85SR10**  
Vertical, 8" low iridescent clear reflector and white baffle.  
Accommodates 5°-15° Slope

\*not suitable for HID or emergency compact fluorescent

## DIMENSIONS

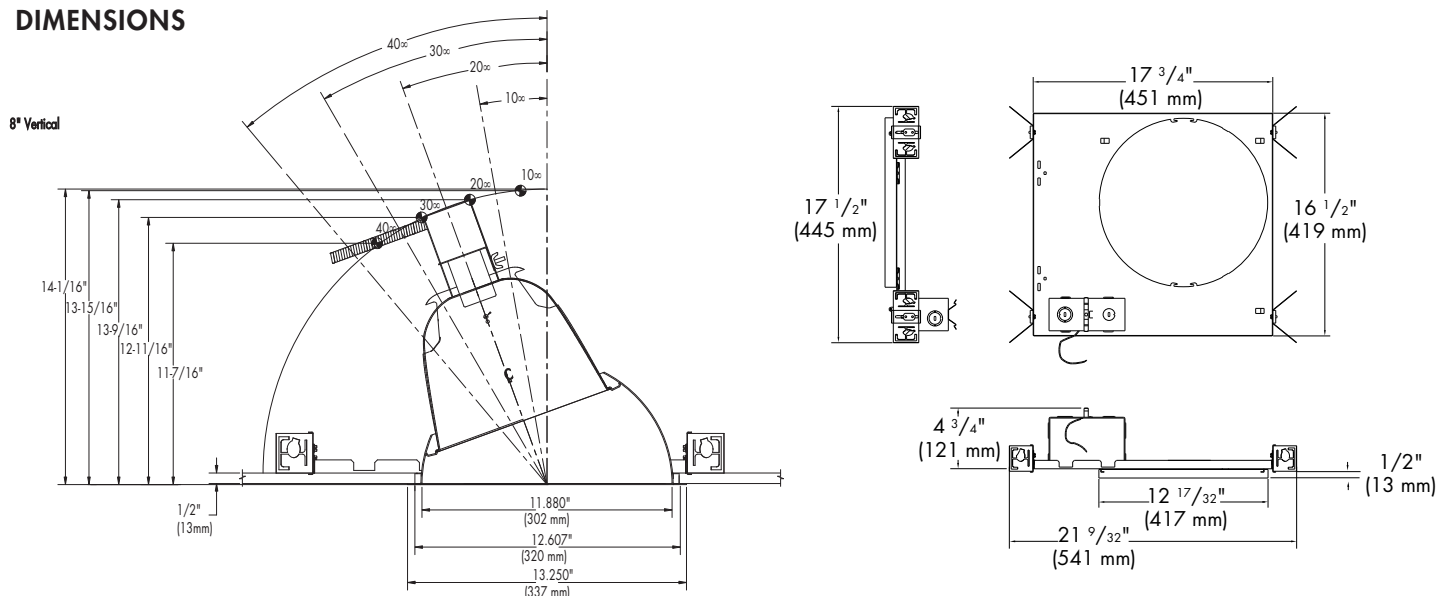

REV. 02/05

Capri Lighting reserves the right to make changes without notice.©2005

**COF-6**

**CAPRI LIGHTING:**  
776 South Green St., Tupelo, MS 38804  
Phone 662.842.7212 FAX 662.841.5501  
[www.caprilighting.com](http://www.caprilighting.com)

**THOMAS LIGHTING CANADA:**  
189 Bullock Drive, Markham, Ontario, Canada L3P 1W4  
Phone 905.294.9570 FAX 800.268.0003  
[www.thomaslightingcanada.com](http://www.thomaslightingcanada.com)

**capri**  
LIGHTING