

CP5-1

Recessed Downlight

C-Plus PRL6K

6" LED Recessed
New Construction/
Retrofit Downlight



Specifier's Reference

Project

Type

Model No.

Comments

application

- The Philips Lightolier PRL6K provides the best overall balance of performance and value featuring state-of-the-art solid state LED technology. The integrated design is ideal for both residential and many light commercial applications, and provides equivalent performance compared to lower efficacy sources that it replaces. The PRL6K is cUL listed for use in Capri and many competitor's cans maximizing overall retrofit potential.

light engine

- The LED light engine is specifically designed to provide equivalent performance compared to a 65W BR30 incandescent or an 18W compact fluorescent lamp.
- Consumes less than 12W of input power.
- Exceptional longevity providing over 50,000 hours of 70% lumen maintenance (L70).
- LED PCBA – Printed circuit board assembly features multiple LED's providing consistent color temperature between luminaires. Available in 3000K CCT, and minimum 80 CRI.
- LED Driver – Integrated solid state driver is 120V, 50/60Hz, >0.90 power factor. Verified to be compliant to FCC 47CFR part 15 class B. Class A noise rating. Dimmable to 15% on triac (forward phase) control devices (see dimmer list below).

construction

- Completely integrated module for ease of assembly and handling.
- Proprietary heat sink ensures overall longevity by convecting heat away from the vital components in the driver and LED array into the ambient air or into housing materials.
- Precision spun aluminum passive lower optic provides exceptional glare control with high efficiency. Painted white with self-lipped flange is standard.

- Integrated mixing chamber with high efficiency finish collimates light from LED's to optimize overall luminaire efficacy.
- Ultra transmissive non-metallic diffuser providing unpixilated glare control.
- Torsion springs allow for positive retention to the ceiling eliminating potential for gaps.
- Integrated E26 socket adapter allows for easy handling while affixing sockets from incandescent cans.

listings

- cUL listed for use in IC and non-IC applications up to 35C ambient temperatures, damp rated
- Warranty – 5 year warranty applicable to both IC and non-IC applications up to a 35C ambient temperature



Green Choice: PRL6K-G1-6-30K

housing

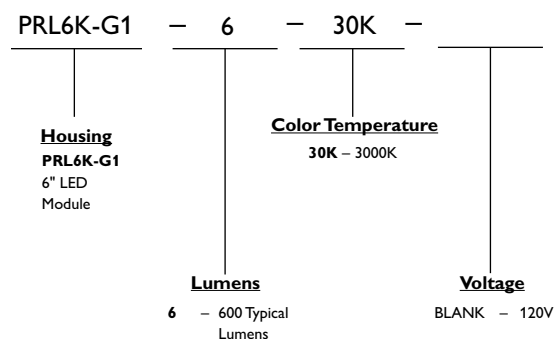

dimensions

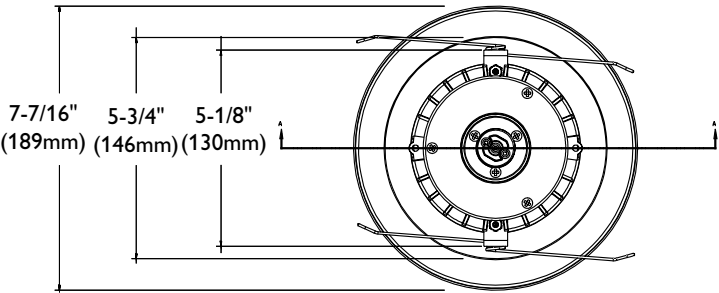
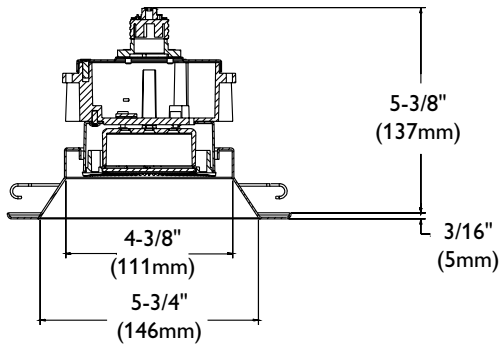

photometrics

PRL6K-G1-6-30K

Tested to LM-79 standards.

Clear Specular Reflector		Candle Power				Average Luminance			
Test No.	31089	Angle	End	45	Cross	Zone	End	45	Cross
S/MH	(0 degree plane) 1.1	0	333	333	333	45	12361	12616	12972
Lamp Type	11W LED	5	330	330	331	55	9610	10185	10800
Total Fixture Lumens	646	15	308	309	311	65	3643	4096	4624
IES File	31089.ies	25	266	269	272	75	1750	1805	1847
Input Watts	11	35	214	216	221	85	1458	1659	1816
Luminaire Efficacy	59 LPW	45	160	163	167	Coefficients of Utilization			
Comp Yearly Energy Cost at \$0.08/KWh = \$4.07		55	101	107	113	pcc	80		
		65	28	32	36	pw	70	50	30
		75	8	9	9	RCR	70	50	30
		85	2	3	3	0	119	119	119
						1	111	107	104
						2	103	96	91
						3	95	86	80
						4	88	78	70
						5	82	70	63
						6	76	64	56
						7	71	59	51
						8	66	54	46
						9	62	50	42
						10	58	46	39

C-Plus 6" PRL6K Housing Compatibility Chart

Manufacturer	SKU	Manufacturer	SKU	Manufacturer	SKU
Philips Lightolier	R150ASIC QL6QP CRR1QP CR1QP PR75ASIC	Thomas	PS1 PS1RM PS3QC PS71C	Commercial Electric (Home Depot)	CAT71CATA CAT71CRM CAT71CR CAT71CRAT
Halo	H7T H7RT H7ICT H7RICT H7ICAT H7RICAT	Elco	EL7IC EL7ICA EL7RICA R10 RR10H	Utilitech (Lowe's)	CR06RICAT Y1-RICT Y7ICAT UAR700T CR604W CR6041W
Cooper - All Pro	EI700 EI700RAT EI700R EI700AT ET700 ET700R	Juno	IC22 IC22W IC22S IC2 IC2W TC2/TC2S TC2W TC2R IC22R IC2 TC2 TC2R		

Following is a list of standard leading edge Triac dimmers recommended for use with the PRL6K-G1:*

Leviton, IPI06 -1LM Slide Dimmer 600W
 Leviton, RPI06 - 1LW Rotary Dimmer 600W
 Leviton, 6161-W 500W
 Leviton, VPI06-1LW - DECORA 600W
 Lutron S-600PR-LA 600W
 Lutron, MAW-600H-WH-Lutron Digital Fade
 Lutron, DVW-603PGH-LA
 Lutron, LG-600PH-WH
 Pass & Seymour, DR703PLAV 700W
 Pass & Seymour, LSLV603PVV

* Compatible dimmers list is subject to change without notice.



© 2013 Koninklijke Philips Electronics N.V. All rights reserved.
 Specifications are subject to change without notice.
www.philips.com/luminaires

CP5-1 07/13

Philips Lighting Company
 200 Franklin Square Drive
 Somerset, NJ 08873
 Phone: 855-486-2216

Philips Lighting Company
 281 Hillmount Road
 Markham ON, Canada L6C 2S3
 Phone: 800-668-9008