

application

- Recessed compact fluorescent sloped housings for ceiling slopes from 2/12 to 12/12. Furnished with pre-installed BH1 adjustable bar hangers. Extra large junction box is provided with 4 Romex knockouts with strain relief. Fixture is c/ETL Listed for through branch wiring and damp location use. AirSeal™ housing meets all WSEC requirements and is tested to ASTM E238.

construction

- Housing** - Formed 20 gauge housing. Mounting frame is lightweight and easy to install. Housing is IC, non-IC and AirSeal™ rated. The neck is adjustable to accept a wide variety of ceiling thicknesses from 1/2" to 1-1/4". The junction box is accessible from below the ceiling.
- Ballast** - Electronic ballast (U) is universal voltage (120 through 277), total harmonic distortion (THD) less than 10%, and high power factor (+98%). NE1 electronic ballast is 120 volt normal power factor electronic ballast. Downlights with normal power factor electronic (NE1) ballast are Energy Star approved and Title 24 compliant.
- Socket** - Dedicated four-pin compact fluorescent socket for 13 watt through 32 watt lamps.
- Adjustable Socket Bracket** - The versatile socket bracket allows for aiming of the lamp in ceiling pitches from 2/12 to 12/12. The socket can be easily positioned prior to installation due to the clearly marked pitch positions. Once aimed, the bracket locks in place with a single wing nut.
- Bar Hangers** - Furnished with BH1 bar hangers that telescope from 10-1/2" to 25". Vertical design of interlocking bar hangers prevents sagging even at full 24" extension. Bar hangers can be locked into position.
- Junction Box** - Large 32 cubic inch 16 gauge galvanized steel with two snap on covers and grounding pig tail. Knockouts for 1/2" and 3/4" conduit and 4 Romex knockouts with strain relief. Meets all safety requirements of c/ETL and the N.E.C.

- Thermal Protection** - Standard thermal protection with class P electronic ballast. Minimum starting temp is 0° F.
- AirSeal™** - Luminaire is AirSeal™ rated, and tested per ASTM E283, limiting the passage of air through the housing to no more than 2.0 CFM at 75 Pascals. AirSeal™ housing meets restricted airflow requirements of Washington State Energy Code (W.S.E.C.) and International Energy Conservation Code (I.E.C.C.).
- c/ETL Listed - for damp locations and through branch wiring, 3 in/3 out.

accessories (ordered separately)

- 27" Flat Bar Hanger BH3



Recessed CFL VS6PL13/18/26/32

6" Versatile Slope CFL Recessed Sloped Ceiling Housing



Specifier's Reference

Project

Type

Model No.

Comments

Green Choice: VS6PL26/32U-VS640CLR

VS6	PL				
Housing		Wattage		Trim Type	
VS6 Versatile slope 6 inch		13 – 13 watt CFL		VS640 – Open Reflector	
		18 – 18 watt CFL		VS630 – Baffle ²	
		26 – 26 watt CFL			
		32 – 32 watt CFL			
	Lamp Type	26/32 – 26 or 32 watt CFL ⁵	Options		Finish
	PL – Compact Fluorescent		U – Universal 120-277V CFL HPF Ballast		CLR – Clear Specular
			NE1 – Energy Star Listed, 120V CFL NPF Ballast ³		GLD – Gold Specular
			DX1 – 120V Advance Mark X Dimming HPF Ballast ¹		BLK – Black
			DX2 – 277V Advance Mark X Dimming HPF Ballast ¹		WHT – White
			DL1 – 120V Lutron Dimming HPF Ballast ^{1,4}		
			DL2 – 277V Lutron Dimming HPF Ballast ^{1,4}		

Foot Notes

- Non-IC applications only.
- Baffle available in white or black only.
- 13W and 18W only.
- Lutron ECO System® ballast.
- Not for use with dimming ballast options. Must specify exact wattage for dimming.

trims



VS630 (Shown)

Black Baffle

VS630WHT

White Baffle

7-3/4" O.D. (197 mm)



VS640CLR (Shown)

Specular Reflector

VS640GLD Gold Reflector

VS640BLK Black Reflector

VS640WHT White Reflector

7-3/4" O.D. (197 mm)

dimensions

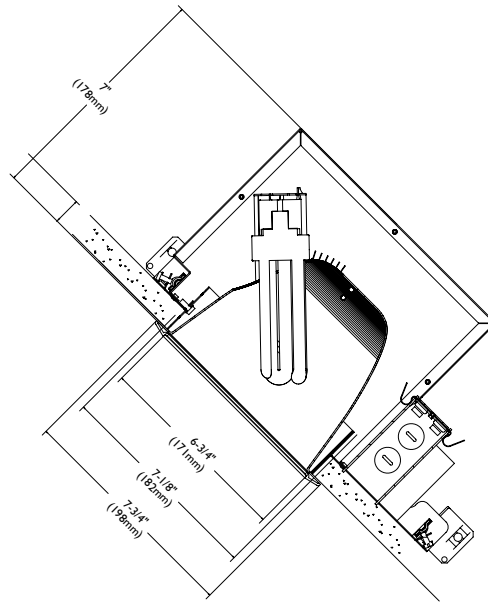
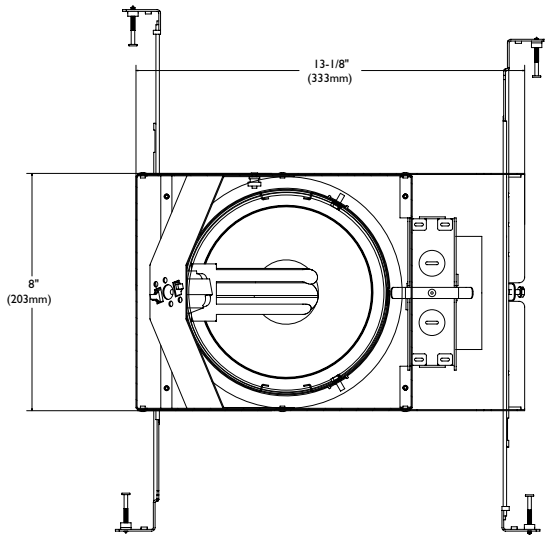

operating characteristics

HOUSING	LAMP	LINE AMPS	INPUT WATTS	POWER FACTOR	MIN. STARTING TEMP
VS6PL13NE1	CFQ13W/G24q	0.26	15	>50%	0°
VS6PL13U (120VAC)	CFQ13W/G24q	0.15	16	98%	0°
VS6PL13U (277VAC)	CFQ13W/G24q	0.07	18	98%	0°
VS6PL18NE1	CFQ18W/G24Q	0.34	22	>50%	0°
VS6PL18U (120VAC)	CFQ18W/G24Q	0.19	22	98%	0°
VS6PL18U (277VAC)	CFQ18W/G24Q	0.08	22	98%	0°
VS6PL26/32U (120VAC)	CFQ26W/G24Q	0.32	28	98%	0°
VS6PL26/32U (277VAC)	CFQ26W/G24Q	0.14	28	98%	0°
VS6PL26/32U (120VAC)	CFM32W/G24Q	0.31	36	98%	0°
VS6PL26/32U (277VAC)	CFM32W/G24Q	0.13	36	98%	0°

photometrics

VS6PL26/32U-VS630WHT

VS6PL26/32U
6/12 pitch - CFL
Report number: 29240
Lamp: (1) CFT26W
S/MH Ratio : 1.3
IES file: 29240.IES
Input Watts: 30
Fixture Efficiency: 86.8%

Candle Power			
	CANDELA		FOOT- LAMBERTS
DEGREES	AT 0°	AT 90°	
0	658	658	658
5	651	655	660
15	618	627	633
25	571	588	596
35	513	522	533
45	388	384	398
55	236	241	245
65	130	129	130
75	61	61	62
85	18	17	17

Average Luminance

ZONE	END	45	CROSS
45	30081	29771	30856
55	22556	23034	23416
65	16863	16733	16863
75	12920	12920	13132
85	11322	10693	10693

Light Distribution			
DEGREES	LUMENS	%LAMP	%FIXTURE
(0-30)	510	28.3	32.6
(0-40)	833	46.3	53.4
(0-60)	1350	75.0	86.4
(0-90)	1562	86.8	100.0

Coefficients of Utilization

RC	80			50		
RW	50	30	10	30	50	10
1	94	92	88	93	90	86
2	88	81	76	84	80	75
3	81	71	66	79	70	65
4	73	65	57	71	64	56
5	68	57	51	67	56	50
6	64	53	45	61	52	45
7	58	47	40	57	46	40
8	55	44	36	54	42	36
9	52	40	34	50	40	33
10	47	36	30	46	36	30

VS6PL26/32U-VS630WHT

VS6PL26/32U
12/12 pitch - CFL
Report number: 29241
Lamp: (1) CFT26W
S/MH Ratio: 1.2
IES file: 29241.IES
Input Watts: 30
Fixture Efficiency: 82.5%

Candle Power			
	CANDELA		FOOT- LAMBERTS
DEGREES	AT 0°	AT 90°	
0	668	668	668
5	667	663	661
15	621	619	619
25	541	552	569
35	450	496	496
45	361	377	378
55	228	225	230
65	123	121	123
75	58	59	59
85	16	17	17

Average Luminance

ZONE	END	45	CROSS
45	27987	29228	29305
55	21791	21505	21982
65	15955	15696	15955
75	12285	12497	12497
85	10064	10693	10693

Light Distribution			
DEGREES	LUMENS	%LAMP	%FIXTURE
(0-30)	493	27.4	33.2
(0-40)	795	44.2	53.6
(0-60)	1282	71.2	86.4
(0-90)	1484	82.4	100.0

Coefficients of Utilization

RC	80			50		
RW	50	30	10	30	50	10
0	97	97	97	95	95	95
1	91	86	83	89	84	82
2	82	77	71	81	76	70
3	77	68	63	75	67	61
4	70	61	55	68	59	54
5	65	55	48	64	55	47
6	60	50	42	58	50	42
7	56	46	39	55	45	39
8	53	41	34	51	40	34
9	48	39	32	47	38	32
10	46	35	29	45	34	28



©2011 Philips Omega
All rights reserved.

776 South Green Street • Tupelo, MS 38804
p. 800.234.1890 • f. 662.841.5501
www.omegalighting.com
Canadian Division
189 Bullock Drive • Markham, Ontario L3P 1W4
p. 905.294.9570 • f. 905.294.9811

Contact Factory for Additional Configurations.
Specifications are subject to change without notice.

Some luminaires use fluorescent or high intensity discharge (HID) lamps that contain small amounts of mercury. Such lamps are labeled, "Contain Mercury" and/or the symbol "HG". Lamps that contain mercury must be disposed of in accordance with local requirements. Information regarding lamp recycling and disposal can be found at www.lamprecycle.org

