

CMHR4GX with Square Trims

4" Non-IC Recessed Ceramic Metal Halide Housings

Remodel Construction

Catalog Number: _____

Type: _____

Project: _____



Description

For remodel construction. Thermally protected, ceramic metal halide remodel housing. Miniature frame-in housing with electronic ballast for use with GX10 lamps up to 39 watts. Junction box is provided with 1/2" conduit and 4 Romex knockouts with a strain relief. For fast installation in existing plaster or mechanical ceilings from 1/2" to 1-1/2" thick. Remodel clips are easily retractable for fixture removal if necessary.

Features

- Electronic ballast ensures properly controlled voltage to lamps maximizing lamp life.
- For remodel construction, has pre-installed spring clips which secure the housing firmly into ceiling and accommodate ceiling thickness from 1/2" to 1-1/2". No tools required.
- Thermal protection standard.
- cETL listed for through-branch circuit wiring and damp locations.

CATALOG SYSTEM AND OPTIONS

SAMPLE CATALOG NUMBER: CMHR4GX39EB1-LC132

Housing	Wattage	Voltage	Trims (choose one)
CMHR4GX	20 20W GX10 39 39W GX10	EB1 120V EB2 277V	<p>LC131 – square adjustable gimbal, black baffle w/white trim</p> <p>LC131W – square adjustable gimbal white baffle w/white trim</p> <p>LC132 – square adjustable gimbal clear cone w/white trim</p> <p>LC133 – square adjustable gimbal gold cone w/white trim</p> <p>LC134 – square adjustable gimbal black cone w/white trim</p> <p>LC134M1 – square adjustable gimbal black cone w/brushed nickel trim</p> <p>LC134M2 – square adjustable gimbal black cone w/chrome trim</p> <p>LC136 – square adjustable gimbal white cone w/white trim</p> <p>LC136M1 – square adjustable gimbal white cone w/brushed nickel trim</p> <p>LC136M2 – square adjustable gimbal white cone w/chrome trim</p> <p>LC137SL – square adjustable gimbal brushed nickel cone w/brushed nickel trim</p>

General Notes:

See back of sheet for housing, lamp and louver compatibility.
Custom colors are available on select trims. Please visit www.caprilighting.com for further details.

SPECIFICATIONS

Specifications

- Housing** - Deep drawn single piece housing, painted black. Pre-installed spring clips secures the housing into the ceiling. Accommodates PAR20 ceramic metal halide lamp. Ceiling opening 4-1/4".
- Ballast** - High power factor electronic ballast offers constant lumen output over wide input voltage range. Output regulation insures consistent fixture to fixture color uniformity of lamp. Ballast features auto shut down feature for lamp abnormalities and end of lamp life detection. Minimum starting temperature of 30°C and total harmonic distortion <10%.
- Square Trims** - Trims are die-cast aluminum for superior durability and heat dissipation. Adjustable lamp aiming up to 37°. Durable powder coat and plated finishes will not fade or discolor.

4. **Installation** - For installation from below finished ceiling. Will accommodate ceiling thickness from 1/2" to 1-1/2".

5. **Socket** - Porcelain GX10 socket with twist and lock action holds lamp securely in place.

6. **Junction Box** - 17 cubic inch 20 gauge steel with snap-on cover and grounding pigtail. Knockouts for 1/2" conduit. Meets all safety requirements of cETL and the N.E.C.

7. **Thermal Protection** - Standard probe style thermal protector mounted to junction box knock out automatically takes fixture out of service if temperature becomes excessive from contact with insulation, overlampping or wrong lamp/trim combination.

8. **cETL listed** for damp locations and through-branch circuit wiring, 3 in/3 out.

DIMENSIONS

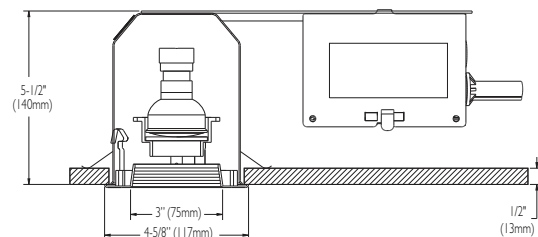
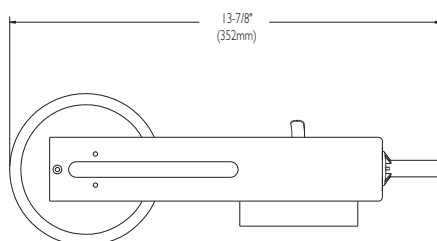

CMHR4GX Square Trims



LCI31
Adjustable gimbal white trim
w/black baffle
4-5/8" sq. (117 mm)

Housing	Lamp	Wattage
CMHR4GX	GX10	20W
	GX10	39W



LCI31W
Adjustable gimbal white trim
w/white baffle
4-5/8" sq. (117 mm)

Housing	Lamp	Wattage
CMHR4GX	GX10	20W
	GX10	39W



LCI32
Adjustable gimbal white trim
w/ clear cone
4-5/8" sq. (117 mm)

Housing	Lamp	Wattage
CMHR4GX	GX10	20W
	GX10	39W



LCI33
Adjustable gimbal white trim
w/ gold cone
4-5/8" sq. (117 mm)

Housing	Lamp	Wattage
CMHR4GX	GX10	20W
	GX10	39W



LCI34
Adjustable gimbal white trim
w/ black cone
4-5/8" sq. (117 mm)

Housing	Lamp	Wattage
CMHR4GX	GX10	20W
	GX10	39W



LCI34M1
Adjustable gimbal brushed nickel
trim w/black cone
4-5/8" sq. (117 mm)

Housing	Lamp	Wattage
CMHR4GX	GX10	20W
	GX10	39W



LCI34M2
Adjustable gimbal chrome trim
w/black cone
4-5/8" sq. (117 mm)

Housing	Lamp	Wattage
CMHR4GX	GX10	20W
	GX10	39W



LCI36
Adjustable gimbal white trim
w/white cone
4-5/8" sq. (117 mm)

Housing	Lamp	Wattage
CMHR4GX	GX10	20W
	GX10	39W



LCI36M1
Adjustable gimbal brushed nickel
trim w/white cone
4-5/8" sq. (117 mm)

Housing	Lamp	Wattage
CMHR4GX	GX10	20W
	GX10	39W



LCI36M2
Adjustable gimbal chrome trim
w/white cone
4-5/8" sq. (117 mm)

Housing	Lamp	Wattage
CMHR4GX	GX10	20W
	GX10	39W



LCI37SL
Adjustable gimbal brushed nickel
trim w/brushed nickel cone
4-5/8" sq. (117 mm)

Housing	Lamp	Wattage
CMHR4GX	GX10	20W
	GX10	39W

Philips Capri reserves the right to make changes without notice.©2009