

Recessed Downlight

R4QP-LED-G1

4" LED Recessed New Construction Downlight



labels

- Labeled for maximum 13W input power. Ideal for compliance to lighting power density(w/ft)applications and CA Title 24.

listings

- IC - Housing is UL Listed for use in direct contact with insulation.
- AirSeal™ - Fixture is AirSeal™ rated preventing the passage of no more than two cubic feet of air per minute through housing. AirSeal™ rated to ASTM E283.
- c/ETL listed for damp locations and through branch circuit wiring, 4 in/4 out.



Housing is intended for use with CRL4K LED Module. (See spec sheet RC5-8)



application

- The Philips Capri R4QP-LED-G1 housing allows the latest in LED technology to be easily installed into the luminaire, and is UL Listed for use with the CRL4K trim modules. Electrical connection is quick and easy with the integral quick plugs that accept the primary leads from the module driver.

construction

- Housing - Deep drawn 20 gauge steel single piece housing. Adjusts vertically in frame to accommodate variations in ceiling thickness. Ceiling opening 4-1/4". Plaster Frame is stamped 22 gauge galvanized steel.
- Bar Hangers - Pre-installed BH1 bar hangers telescope from 16 to 24 inches. Alignment holes provided to center fixture on 14, 16 and 24 inch centers. Bar hangers are equipped with heavy duty fluted rails. Interlocking support tabs provide smooth adjustment of bar hanger.
- Junction Box - Large 16 gauge galvanized steel with snap-on cover and grounding pigtail. Knock-outs for 1/2" and 3/4" conduit. Integral cable clamp permits attachment of non-metallic Romex without the need of additional connectors. Meets all safety requirements of U.L. and N.E.C.
- Electrical Connection - Driver leads can be quickly and easily connected to quick plugs provided with the R4QP-LED-G1. Edison socket adapter on CRL4K-G1 module is easily removed via two wire nuts for high efficacy installation with R4QP-LED-G1 housing.

Specifier's Reference

Project

Type

Model No.

Comments

Green Choice: R4QP-LED-G1

housing

R4QP-LED-G1

Housing
R4QP-LED-G1
LED R4 housing

dimensions

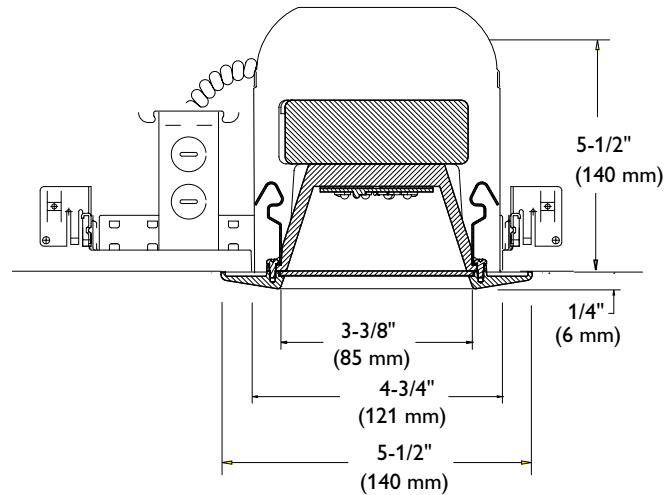
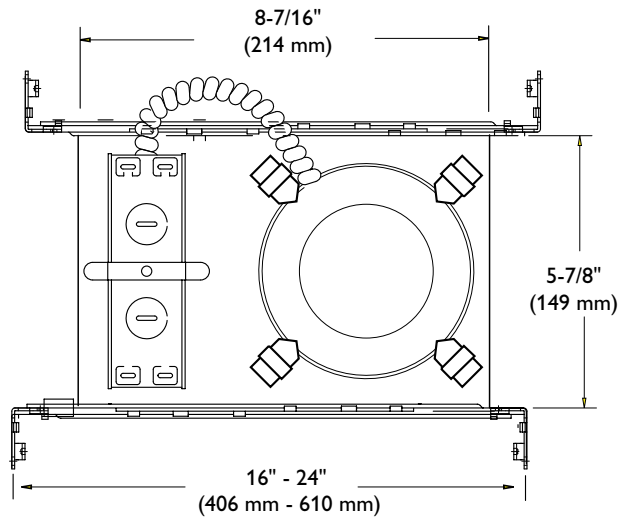

*Dimensions shown with CRL4K module (sold separately).



©2011 Philips Omega
All rights reserved.

776 South Green Street • Tupelo, MS 38804
p. 800.234.1890 • f. 662.841.5501
www.omegalighting.com
Canadian Division
189 Bullock Drive • Markham, Ontario L3P 1W4
p. 905.294.9570 • f. 905.294.9811

Contact Factory for Additional Configurations.
Specifications are subject to change without notice.
Consult website for latest version of this spec sheet.

Some luminaires use fluorescent or high intensity discharge (HID) lamps that contain small amounts of mercury. Such lamps are labeled, "Contain Mercury" and/or the symbol "Hg". Lamps that contain mercury must be disposed of in accordance with local requirements. Information regarding lamp recycling and disposal can be found at www.lamprecycle.org

