

Surface and Wall

FRD10IC, FRD12IC

Compact Fluorescent IC Rated

Ceiling Drum



Specifier's Reference

Project
Type
Model No.
Comments

application

- Philips Capri ceiling drums feature acrylic diffusers for uniform light distribution. Canopies are die-formed steel with a white enamel finish. cUL listed for damp locations. 13 watt lamp, 120 volt normal power factor electronic ballast.

Green Choice: FRD10ICEB1

Housing

FRD10ICEB1
(2) CFQ213W/GX24q

FRD12ICEB1
(3) CFQ213W/GX24q

General Notes

Available lamps and wattages listed below housings.

dimensions

FRD10ICEB1

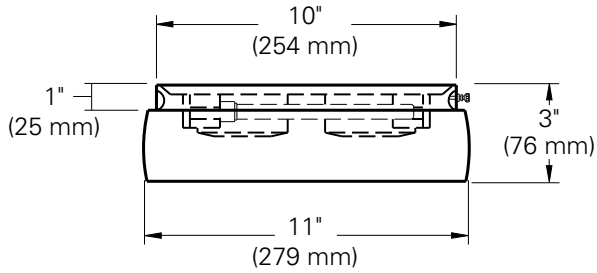

FRD12ICEB1

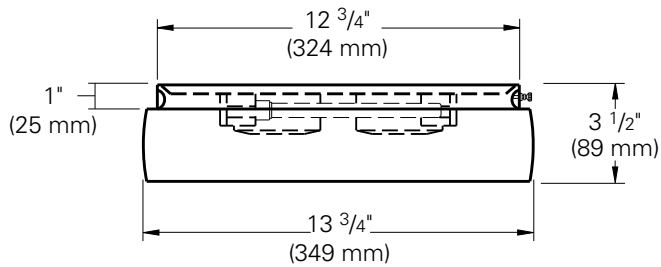

©2011 Philips Omega
All rights reserved.

776 South Green Street • Tupelo, MS 38804
p. 800.234.1890 • f. 662.841.5501
www.omegalighting.com
Canadian Division
189 Bullock Drive • Markham, Ontario L3P 1W4
p. 905.294.9570 • f. 905.294.9811

Contact Factory for Additional Configurations.
Specifications are subject to change without notice.



Some luminaires use fluorescent or high intensity discharge (HID) lamps that contain small amounts of mercury. Such lamps are labeled, "Contain Mercury" and/or the symbol "HG". Lamps that contain mercury must be disposed of in accordance with local requirements. Information regarding lamp recycling and disposal can be found at www.lamprecycle.org