

PHILIPS Stonco

Special Purpose

Defiant II

Vandal resistant
15" round, HID



Project: _____
Location: _____
Cat.No: _____
Type: _____
Quantity: _____
Notes: _____

Philips Stonco Defiant II vandal resistant wall mount is a specification grade luminaire designed for durability and performance to withstand today's toughest environments. It is ideal for schools, parking garages, office complexes, or any application prone to vandalism.

Ordering guide

Example: DFII-DBR-WO-70MH-O-MT-BK

Series	Mounting Plate	Lens	Lamps	Front Accents	Voltage	Finish	Options
DFII -	DBR -	<input type="text"/> -	<input type="text"/> -	<input type="text"/> -	<input type="text"/> -	<input type="text"/> -	<input type="text"/>
DFII Decorative Wall Mount	DBR Deep back box, recessed	CL Clear WO White opal	50HPS 1-50W HPS 70HPS 1-70W HPS 100HPS 1-100W HPS 150HPS 1-150W HPS 50MH 1-50W MH 70MH 1-70W MH 100MH 1-100W MH	O Open E¹ Eyelid C Cross	MT Multi-Tap (120/208/247/277V) TT² Tri-Tap (120/277/347V)	BK Black BZ Dark Bronze WT White	Q Quartz restrrike GLR HLR/GLR Fusing LP Lamp included

1. Not available in 150HPS

2. Not available in 50WMH

DFII Defiant II vandal resistant wall mount

15" round, HID

Standards

- ETL (US/Canada) Wet Location.
- ADA compliant.

Construction/Finish

- Marine grade die cast aluminum semi-recessed housing (not suitable for concrete-pour applications).
- One piece injection molded, UV-stabilized polycarbonate guards with color molded throughout are available in four styles: Open, Cross, Eyelid, and Slotted Eyelid. Guards are permanently mounted to fixture.
- UV-stabilized, polycarbonate locking ring holds lens to back mounting plate or deep box. Locking ring has keyed slots for correct alignment.
- Symmetrical white reflector standard. Asymmetric specular hammer-tone aluminum reflector for eyelid with HID lamps for forward throw (up to 100W HID).
- Stainless steel center-pin reject Allen Head fasteners standard.
- Housing finish is textured black polyester powder coat standard. White and Dark Bronze also available

Lens

- UV-stabilized, polycarbonate injection molded lens, 0.180" minimum thickness available in clear or translucent white, both with radial prisms to provide superior illumination.

Electrical

- Ballast is high reactance, high power factor, with starting temperature of -20°F (-30°C) for metal halide, and -40°F for high pressure sodium.

Installation

- Luminaire may be wall mounted four point mounting must be used for maximum vandal resistance.

Dimensions

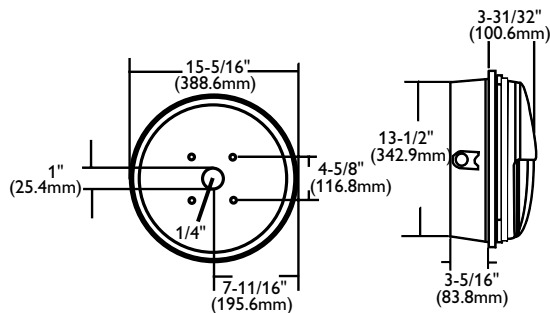

Some luminaires use fluorescent or high intensity discharge (HID) lamps that contain small amounts of mercury. Such lamps are labeled, "Contain Mercury" and/or the symbol "HG". Lamps that contain mercury must be disposed of in accordance with local requirements. Information regarding lamp recycling and disposal can be found at www.lamprecycle.org

© 2015 Koninklijke Philips N.V. All rights reserved.
Philips reserves the right to make changes in specifications and/or to discontinue any product at any time without notice or obligation and will not be liable for any consequences resulting from the use of this publication.
philips.com/luminaires



Philips Lighting, North America Corporation
200 Franklin Square Drive, Somerset, NJ 08873
Tel. 855-486-2216

Philips Lighting Canada Ltd.
281 Hillmount Rd, Markham, ON, Canada L6C 2S3
Tel. 800-668-9008