

Job:
Type:
Notes:

Featuring CosmoPolis and
MasterColor Elite Electronic HID Systems

Ecoround

Arm Mount, Wall Mount and Post Top

The Ecoround ERA Arm Mount, ERW Wall Mount and ERP Post Top Mount are tapered cylindrical area luminaires. The precision segmented optical systems provide required light levels, even illumination, wide pole spacings and glare control. The housing is one-piece, seamless spun aluminum with two (2) integral reveals. The door frame is single-piece cast aluminum and the lens is clear tempered flat or sag glass. The luminaire is completely sealed and gasketed to prevent intrusion from moisture, dust, insects and contaminants. The Ecoround may be specified with factory applied color accents which nest in the twin reveals at the lower end of the housing.

Flat glass lens luminaires provide full cutoff performance. Sag lens Luminaires using 3V/QV optics set to lower socket position or Mallmaster optics provide semi-cutoff performance. Other sag lens luminaires provide cutoff performance.

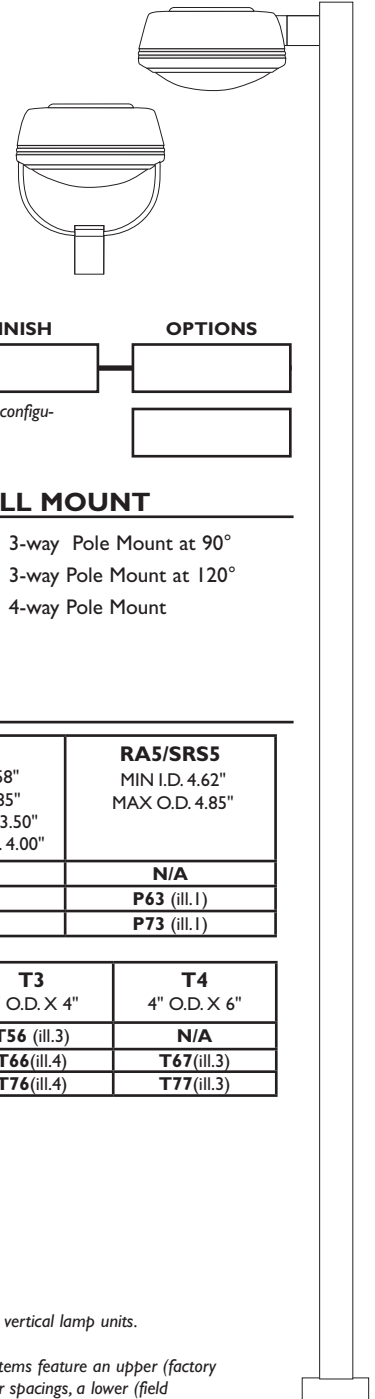

PREFIX	MOUNTING	DISTRIBUTION	WATTAGE	VOLTAGE	FINISH	OPTIONS
<input type="text"/>	<input type="text"/>	<input type="text"/>	<input type="text"/>	<input type="text"/>	<input type="text"/>	<input type="text"/>

Enter the order code into the appropriate box above. Note: Philips Gardco reserves the right to refuse a configuration. Not all combinations and configurations are valid. Refer to notes below for exclusions and limitations. For questions or concerns, please consult the factory.

PREFIX

Ecoround		
Arm Mount to Pole*	ERA20	20" Round Luminaire
	ERA25	25" Round Luminaire
	ERA30	30" Round Luminaire
Wall Mount with Arm	ERW20	20" Round Luminaire
	ERW25	25" Round Luminaire
Post Top Mount	ERP20	20" Round Luminaire
	ERP25	25" Round Luminaire
	ERP30	30" Round Luminaire

*Arm mounting on round poles is designed to mount to poles measuring 3.5" OD or larger only.

MOUNTING - ARM MOUNT AND WALL MOUNT

1	Single Assembly	3	3-way Pole Mount at 90°
2	Twin Pole Mount at 180°	3@120°	3-way Pole Mount at 120°
2@90°	Twin Pole Mount at 90°	4	4-way Pole Mount

Use "1" for wall mounted units.

MOUNTING - POST TOP MOUNT¹

POLES	SRS3	RA4/SRS4	RA5/SRS5
	MIN O.D. 2.88" MAX O.D. 3.00"	ERP20 MIN O.D. 3.58" ERP20 MAX O.D. 3.85" ERP25/30 MIN O.D. 3.50" ERP25/30 MAX O.D. 4.00"	MIN I.D. 4.62" MAX O.D. 4.85"
ERP20	P51 (ill.3)	P52 (ill.1)	N/A
ERP25	P61 (ill.5)	P62 (ill.2)	P63 (ill.1)
ERP30	P71 (ill.5)	P72 (ill.2)	P73 (ill.1)

DISTRIBUTION

Horizontal Lamp

2H	Type II
3H	Type III
FH	Type IV Forward Throw
BLC	Backlight Control (25" only, 400MH/PSMH requires BT28/E28 lamp.)
QH	Type V

Vertical Lamp

3V^{2,3}	Type III Vertical Lamp
FV²	Type IV Forward Throw Vertical Lamp
QV^{2,3}	Type V Vertical Lamp

3V-RNC^{1,2} Type III Vertical Lamp, Reduced Nadir Candlepower (30" only)
QV-RNC^{1,2} Type V Vertical Lamp, Reduced Nadir Candlepower (30" only)

RNC (Reduced Nadir Candlepower) optics should be specified only in applications requiring extreme maximum to minimum uniformity ratios (5 to 1 or lower). Reduced luminaire efficiency with RNC optics will result in lower average footcandle levels.

3SV¹	Type III Vertical Lamp Mallmaster Semi-cutoff (30" only)
QSV¹	Type V Vertical Lamp Mallmaster Semi-cutoff (30" only)

TENONS

	T2	T3	T3	T4
	2 3/8" O.D. X 4"	2 7/8" O.D. X 4"	3" O.D. X 4"	4" O.D. X 6"
ERP20	T54 (ill.3)	T55 (ill.3)	T56 (ill.3)	N/A
ERP25	T64 (ill.4)	T65 (ill.4)	T66 (ill.4)	T67 (ill.3)
ERP30	T74 (ill.4)	T75 (ill.4)	T76 (ill.4)	T77 (ill.3)

1. See mounting illustrations on Page 3.

2. Sag glass is supplied standard or all vertical lamp units. Polycarbonate is NOT available.

3. 25" and 30" 3V and QV optical systems feature an upper (factory set) cutoff socket position. For wider spacings, a lower (field adjustable) semi-cutoff socket position may be set.

WATTAGE

	20"	25"	30"
Pulse Start MH Magnetic Ballast	100MH ^{4,5,8} 150MH ^{4,8} 175PSMH ⁴ E 200MH ^{4,8} E	250PSMH E 250PS90***E 320PSMH ¹⁰ E 350PSMH ¹⁰ E 400PSMH E 450PSMH ⁹ E	750PSMH ⁹ 775PSMH ⁹ 875PSMH ⁹ 1000PSMH ⁹
CosmoPolis Electronic System	60CMPE ¹¹ 90CMPE ¹¹ 140CMPE ¹¹	60CMPE ¹¹ 90CMPE ¹¹ 140CMPE ¹¹	
MasterColor Elite Electronic System		210MCE-3K ¹¹ E 210MCE-4K ¹¹ E 315MCE-3K ¹¹ E 315MCE-4K ¹¹ E	
Standard MH Magnetic Ballast***	175MH ^{5,6} 250MH ^{7,6}	250MH ⁶ 400MH ⁶	1000MH
High Pressure Sodium Magnetic Ballast	70HPS ^{4,5} 100HPS ^{4,5} 150HPS ^{4,5}	250HPS 400HPS	400HPS 750HPS 1000HPS
** 175MH, 250MH and 400MH not available for sale in the United States.			
*** 250PS90 includes a 90% efficient magnetic PSMH ballast, meeting the requirements of California Title 20, effective 1/1/2010.			
E Wattages marked with circle "E" meet federal energy efficiency standards applicable to 150 watt through 500 watt metal halide luminaires only.			

VOLTAGE

120
208
240
277
347
480

QUAD

120/208/240/277
factory tied to 277V.

200-277

CMPE and MCE
types only.

- Requires mogul base lamp in horizontal optics and medium base lamp in vertical optics.
- Not Available in 480V.
- Requires medium base lamp.
- Available with horizontal lamp optics only.
- All 200MH and all MH 150W and below are pulse start by design.
- Available with vertical lamp optics only.
- Requires BT28 / E28 lamp.
- CMPE and MCE types available in 120V, 200-277V, 347V, or 480V.
- 120V, 347V and 480V require and include an auxiliary transformer.
- For MCE types, "-3K" indicates a 3,000°K lamp, "-4K" indicates a 4,000°K lamp.

FINISH

BRP Bronze Paint
BLP Black Paint
WP White Paint
NP Natural Aluminum Paint
OC Optional Color Paint
Specify Optional Color or
RAL ex: OC-LGP or OC-RAL7024.
SC Special Paint
Specify. Must supply color chip.

OPTIONS

HS ¹²	Internal House Side Shield	QS ¹⁷	Quartz Standby
F	Fusing	QST ¹⁷	Quartz Standby - Timed Delay
LF ¹³	In-Pole/In-Line Fusing	Q924 ¹⁷	Quartz Emergency
PCT ¹⁴	Locking Type Photocontrol Receptacle with Photocontrol	QT924 ¹⁷	Quartz Emergency - Timed Delay
PCR	Locking Type Photocontrol Receptacle	GMR ¹⁸	Provision for Gardco Motion Response
PCB ¹⁴	Button Photocontrol	L6 ¹⁹	LumiStep Ballast 6 hour
MF ¹⁵	Mast Arm Fitter	L8 ¹⁹	LumiStep Ballast 8 hour
PTF2 ¹⁶	Pole Top Fitter 2 3/8" X 4"	L10 ¹⁹	LumiStep Ballast 10 hour
PTF3 ¹⁶	Pole Top Fitter 3 - 3 1/2" X 6"		
PTF4 ¹⁶	Pole Top Fitter 3 1/2 - 4" X 6"		
CR ²⁰	Colored Reveals		
GRC ²¹	Clear Glow Ring		
GRY ²¹	Yellow Glow Ring		
GRG ²¹	Green Glow Ring		
GRR ²¹	Red Glow Ring		

- Supplied standard for FH/IFV.
- Kit includes In-Line Fuses.
- Not Available in 480V.
- ERA only, 20" or 25" units only. Requires 2 3/8" O.D. Mast Arm.
- For mounting ERA luminaires only.
- See QS/Q924 Table.
- Available only with 14" 175PSMH or 150HPS and 18" 250PSMH through 400PSMH or 250HPS through 400HPS wattages. Includes dual-level capacitor and wiring to connect to Gardco Motion Response System.
- Available with CosmoPolis system only. See submittal sheet GE200-005 for complete information on LumiStep ballasts.
- Specify color. Contact factory for availability.
- Available with ERP Post Top Mount units only.

(Note 17) QS / Q924 Table	
HID Lamp Watts	Maximum Quartz Lamp Watts
175 watts or less	100 Watts
Above 175 watts up to 400 watts	150 Watts
QS, QST, Q924 and QT924 options are not available in luminaires above 400 watt HID.	

DIMENSIONS AND EPA

ARM MOUNT

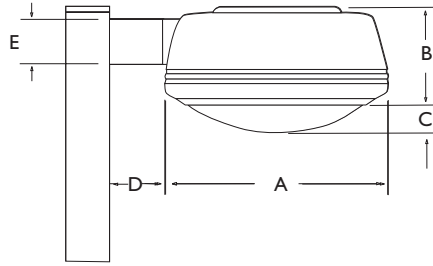

WALL MOUNT

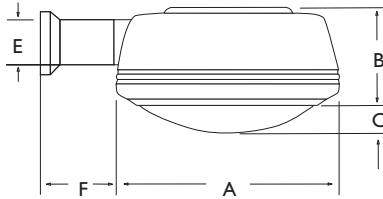

ERA / ERW SINGLE LUMINAIRE WEIGHT (lbs. / kg)			
	20"	25"	30"
ER Flat Glass	26 / 11.794	45 / 20.412	75 / 34.02
ER Sag Glass	28 / 12.71	47 / 21.319	79 / 35.834

DIMENSIONS (In. / cm)			
	20"	25"	30"
A	20 / 50.8	25 / 63.5	30 / 76.2
B	9.25 / 23.495	10.75 / 27.305	15 / 38.1
C Drop Lens	2 / 5.08	3.25 / 8.255	4.75 / 12.065
D Arm Length	4.38 / 11.1252	6.25 / 15.875	8.38 / 21.2852
E Arm Height	5 / 12.7	5 / 12.7	6 / 15.24
F Arm Length	6.38 / 16.2052	8.25 / 20.955	8.38 / 21.2852

EPA - ARM MOUNT (ft ² / m ²)			
Flat Lens Luminaires	20"	25"	30"
Single, Flat Lens	.75 / .070	1.2 / .112	1.9 / .177
Twin, Flat Lens	1.5 / .140	2.3 / .214	3.7 / .344
Quad, Flat Lens	2.0 / .186	3.2 / .298	4.2 / .391
Sag Lens Luminaires	20"	25"	30"
Single, Sag Lens	.85 / .079	1.3 / .121	2.1 / .196
Twin, Sag Lens	1.8 / .168	2.6 / .242	4.2 / .391
Quad, Sag Lens	2.5 / .233	3.7 / .344	5.0 / .465

POST TOP MOUNT

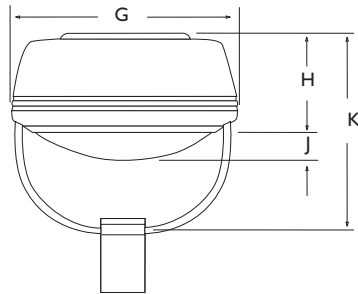

Mounting Illustrations

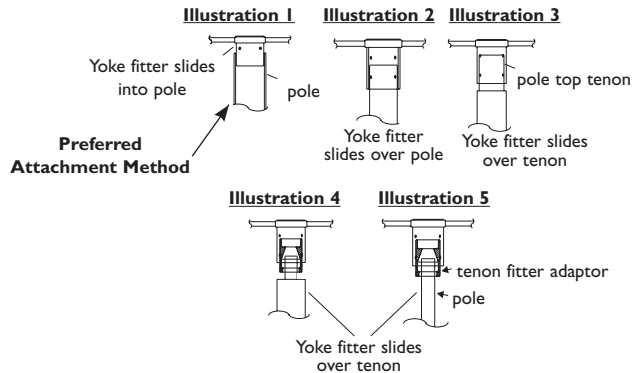

DIMENSIONS (In. / cm)			
	20"	25"	30"
G	20 / 50.8	25 / 63.5	30 / 76.2
H	9.25 / 23.495	10.75 / 27.305	15 / 38.1
J Drop Lens	2 / 5.08	3.25 / 8.255	4.75 / 12.065
K Overall with Yoke	18.38 / 46.6852	21.38 / 54.3052	28.63 / 72.7202

EPA - YOKE MOUNT (ft ² / m ²)			
	20"	25"	30"
Single, Flat Lens	.61 / .057	1.1 / .103	1.6 / .149
Single, Sag Lens	.65 / .061	1.6 / .149	1.9 / .177

SINGLE LUMINAIRE WEIGHT (lbs. / kg)			
	20"	25"	30"
ERP Flat Glass	31 / 14.062	52 / 23.587	83 / 37.649
ERP Sag Glass	33 / 14.969	54 / 24.494	87 / 39.463

SPECIFICATIONS

GENERAL DESCRIPTION: The Ecoround ERA Arm Mount, ERW Wall Mount and ERP Post Top Mount are tapered cylindrical area luminaires. The precision segmented optical systems provide required illumination levels, even illumination, wide pole spacings and glare control. The housing is one-piece, seamless spun aluminum with two (2) integral reveals. The door frame is single piece cast aluminum and the lens is clear tempered flat or sag glass. The luminaire is completely sealed and gasketed to prevent intrusion from moisture, dust, insects and contaminants.

HOUSING: The luminaire consists of a one-piece seamless spun aluminum housing (20"-100", 25"-125", 30"-125") with two (2) integral reveals. A cast aluminum heat sink accommodates the ballast mounting.

LENS ASSEMBLY: A single-piece diecast aluminum door frame retains an optically clear, heat and impact resistant, tempered flat or sag glass lens. The lens is gasketed to the door frame and the door frame is gasketed to the housing with hollow section, high compliance, memory retentive extruded silicone rubber. A concealed stainless steel hinge and two (20"/25") or four (30") #10 stainless steel captive screws secure the lens assembly to the housing.

IP RATING: Luminaires are rated IP65.

OPTICAL SYSTEM: The Ecoround segmented reflector system consists of two levels of specular, clear-anodized aluminum facets precisely aligned to achieve IES Types II, II, IV and Type V distributions. The entire optical system is field rotatable in 90° increments. All mogul base horizontally positioned metal halide units feature a position-oriented lampholder and lamp stabilizer. All optical systems meet provide cutoff performance except 3SV and QSV which are designed to provide semi-cutoff performance. Vertical lamp units can be field-adjusted to achieve wider luminaire spacing semi-cutoff performance.

ARM MOUNTING: A one-piece extruded aluminum arm conceals two steel tie rods and all mounting hardware. No fasteners or welds are visible. For pole installation, a reinforcing plate and wire strain relief are provided.

WALL MOUNTING: The luminaire is supported by a 10 gauge galvanized steel mounting plate. A diecast aluminum canopy is provided which completely conceals the mounting assembly.

POST TOP MOUNTING : The twin parallel yokes are high strength steel tubing (5/8" diameter on 20" units and 3/4" diameter on 25" and 30") which provide luminaire support without obstruction of light distribution. Welds and fasteners are not visible at the luminaire or point of pole attachment. The yoke is electrogalvanized and finished with a polyester powdercoat to match the door frame and luminaire housing.

ELECTRICAL: All electrical components are UL recognized, factory installed and tested and mounted on a unitized plate. High power factor ballasts are rated for -20°F starting temperatures. The lampholder is glazed porcelain with a nickel plated screw shell. Quick disconnects are supplied on the reflector assembly.

FINISH: Each luminaire receives a fade and abrasion resistant, electrostatically applied, thermally cured, triglycidal isocyanurate (TGIC) powdercoat finish. Standard finishes are textured powdercoat. Optional finishes may vary.

COLOR BANDS: Ecoround may be specified with factory-applied color accents which nest in the twin reveals at the lower perimeter of the housing. Consult factory for custom colors.

GLOW RINGS: Ecoround Post Top luminaires may be specified with optional glow rings. The optional color glow ring module features a clear top cap, enabling the optical system to illuminate the acrylic rings.

LABELS: All luminaires bear UL or CUL (where applicable) Wet Location labels.

WARRANTY: EcoRound luminaires feature a 1 year limited warranty. See Warranty Information for complete details and exclusions.

FULL CUTOFF PERFORMANCE: Full cutoff performance means a luminaire distribution where zero candela intensity occurs at an angle at or above 90° above nadir. Additionally, the candela per 1000 lamp lumens does not numerically exceed 100 (10 percent) at a vertical angle of 80° above nadir. This applies to all lateral angles around the luminaire.

CUTOFF PERFORMANCE: Cutoff performance means a luminaire distribution where the candela per 1000 lamp lumens does not numerically exceed 25 (2.5 percent) at an angle at or above 90° above nadir, and 100 (10 percent) at a vertical angle of 80° above nadir. This applies to all lateral angles around the luminaire.

SEMI-CUTOFF PERFORMANCE: Semi-Cutoff performance means a luminaire distribution where the candela per 1000 lamp lumens does not numerically exceed 50 (5.0 percent) at an angle at or above 90° above nadir, and 200 (20 percent) at a vertical angle of 80° above nadir. This applies to all lateral angles around the luminaire.

