

# PHILIPS LIGHTOLIER

## Track

### Alcyon LED

Vertical cylinder,  
LLAV11, 15W/1000lm



Project: \_\_\_\_\_  
 Location: \_\_\_\_\_  
 Cat.No: \_\_\_\_\_  
 Type: \_\_\_\_\_  
 Lamps: \_\_\_\_\_ Qty: \_\_\_\_\_  
 Notes: \_\_\_\_\_

Alcyon LED Vertical Cylinders are ideal for display, accent and task lighting and offer higher efficiency than incandescent or halogen sources leading to energy savings with no ultraviolet or infrared radiation. Alcyon provides concentrated light which dramatically draws interest to objects and elements in a space.

#### Fixture

example: LLAV1130AL

Series	Lumens	CRI/CCT*	Adapter	Finish	Options
<b>LLAV</b>	<b>11</b>				
<b>LLAV</b> Alcyon LED vertical cylinder	<b>11</b> 15W 1000lm	<b>27</b> 80CRI/2700K <b>30</b> 80CRI/3000K <b>40</b> 80CRI/4000K <b>927</b> 90CRI/2700K <b>930</b> 90CRI/3000K <sup>1</sup>	— Lightolier <b>H</b> Halo <b>J</b> Juno <b>P</b> Prospec <sup>2</sup>	<b>WH</b> White <b>AL</b> Alum. <b>BK</b> Black	— no options <b>CW</b> CrispWhite <sup>1</sup>

#### Accessories

example: LLA11SNBK

Series	Finish
<b>LLAV11AH</b> Accessory holder with spring	<b>WH</b> White <b>AL</b> Aluminum <b>BK</b> Black
<b>LLA11SN</b> Compatible snoot	<b>WH</b> White <b>BK</b> Black
<b>LLAV11</b> Compatible diffusion filters	<b>LS</b> Linear Spread <b>SY</b> Symmetrical Spread <b>SF</b> Soft Focus <b>FR</b> Frosted Etched

Compatible color filters/gels provided by others

**LLAHCA11** Compatible hex cell louver  
(matte black)

- CrispWhite (CW) is only available with 90CRI / 3000K CCT (930).
- Prospec is only offered in White (WH) and Black (BK).

#### Reflector

example: LLAV11RS

Series	Lumens	Reflector
<b>LLAV</b>	<b>11</b>	
<b>LLAV</b> Alcyon LED cylinder	<b>11</b> Compatible with 10W/600lm, 15W/1000lm & 28W/2000lm	<b>RNS</b> 10° Narrow Spot <b>RS</b> 18° Spot <b>RNF</b> 24° Narrow flood <b>RF</b> 36° Flood

#### Features

- LED board:** COB LED.
- Integrated housing heat sink:** die-cast aluminum maintains LED junction temperature for minimum 50,000 hr lifetime at 70% lumen maintenance.
- Track attachment fitting:** Integral color in gray, black or white. Molded polycarbonate. Rotates into track and locks into place with the use of push tabs. Located at center of mass to allow for fixture to hang vertically straight on track and with extensions wands and other track accessories.
- Push tab:** Molded polycarbonate. Locks and detaches unit.
- Track adapter housing:** Die-cast aluminum.
- Movable brass contact:** Brass extends for connection to 2nd circuit (Advent track only).
- Pivot mounts:** Allows for 350° horizontal. Vertical rotation of +/- 90° from vertical aim to the floor.
- Driver housing:** Extruded aluminum housing with die-cast aluminum covers.
- Interchangeable optics:** High efficiency metalized coating providing up to 98% total reflectivity for optimal light quality, beam control and punch. Reflector has lens attached which protects reflector finish and LEDs from contamination. Tool-less installation. Reflector sold separately to allow field replaceability.
- Finishes:** Painted with a baked enamel. Contains some powder coated finishes.

#### Dimming

**Trailing edge (ELV) dimming compatible**  
**ZP425QE** Philips Controls (100 - 30%)  
**SELV-300P** Lutron Skylark (100 - 10%)  
**IPE04-ILX** Leviton Decora (100 - 23%)

#### Mounting

Compatible with all Monopoint, Multipoint, recessed track, suspension track, suspension stems, sloped ceiling adapters as well as Basic, Advent and Radius track systems. Ceiling and horizontal or vertical wall mounted (adapters available for Prospec, Halo, Juno and ConTech).

#### Electrical

**Electronic power supply**  
 Input voltage: 120V, 60Hz  
 Input power: 15W  
 Efficacy: 78lm/W (nominal) @ 3000K  
 High power factor: >0.9  
 CRI: 80-85 (typical)

#### Labels

cULus Listed.  
 5 year warranty.  
 ENERGY STAR® certified  
 (without accessories).



# LLAV11 Alcyon LED

Vertical Cylinder, 15 W/1000 lm

## Dimensions

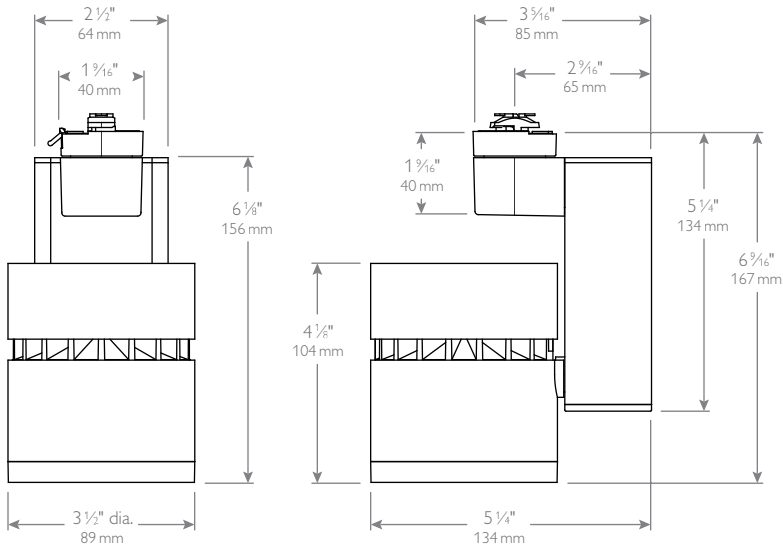

## Accessories







Alcyon LED track lighting offers a full range of high performance accessories for tinting, coloring and shaping of the light beam. All accessories are designed to attach easily. A complete accessory consists of a size and series suffix.

### Components

1. Housing
2. Reflector
3. Accessory holder
4. Accessory spring
5. Diffusion filters
6. Hex cell louver
7. Snoot
8. Aperture ring

## Diffusion/special filters

LLAV11 = 3-1/8" dia.

-  **LS** Linear spread lens
-  **FR** Frosted etched lens
-  **SF** Solite soft focus lens
-  **SY** Soft Focus lens

## Hex cell louvers

LLAHCA11 = 3-1/8" dia..



Only available in matte black

# LLAV11 Alcyon LED

Vertical Cylinder, 15W/1000lm

## Aiming angles

L and W are the outer points where the candle power drops to 50% of the maximum. FC are the initial footcandles at the center of the beam. Data shown is for 3000K, for 2700K multiply FC by 1.0 and for 4000K multiply FC by 1.07.

L Beam length  
D Distance  
W Beam Width  
A Aiming Angle  
FC Footcandles  
C Distance to center beam

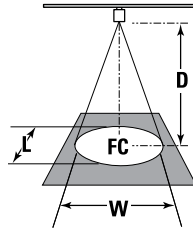

0° horizontal aiming angle

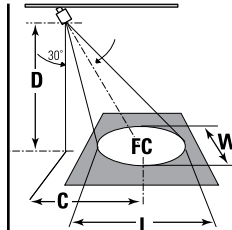

30° horizontal aiming angle

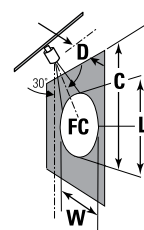

30° vertical aiming angle

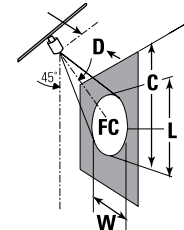

45° vertical aiming angle

	Beam spread (To 50% CBCP)	CBCP	Rated Life (Hrs.)	0° horizontal aiming angle					30° horizontal aiming angle					30° vertical aiming angle					45° vertical aiming angle				
				D	C	FC	L	W	D	C	FC	L	W	D	C	FC	L	W	D	C	FC	L	W
LLAV11RNS Narrow Spot	10°	20,762	50,000	12' 0.0'	0.0'	144	2.1'	2.1'	10' 5.8'	5.8'	135	2.3'	2.0'	4' 6.9'	6.9'	162	2.9'	1.4'	6' 6.0'	6.0'	204	2.1'	1.5'
				14' 0.0'	0.0'	106	2.4'	2.4'	12' 6.9'	6.9'	94	2.8'	2.4'	6' 10.4'	10.4'	72	4.3'	2.1'	8' 8.0'	8.0'	115	2.8'	2.0'
				16' 0.0'	0.0'	81	2.8'	2.8'	14' 8.1'	8.1'	69	3.3'	2.8'	8' 13.9'	13.9'	41	5.7'	2.8'	10' 10.0'	10.0'	73	3.5'	2.5'
				18' 0.0'	0.0'	64	3.1'	3.1'	16' 9.2'	9.2'	53	3.7'	3.2'	10' 17.3'	17.3'	26	7.2'	3.5'	12' 12.0'	12.0'	51	4.2'	3.0'
LLAV11RS Spot	18°	8,134	50,000	8' 0.0'	0.0'	127	2.5'	2.5'	8' 4.6'	4.6'	83	3.4'	2.9'	4' 6.9'	6.9'	64	5.5'	2.5'	5' 5.0'	5.0'	115	3.2'	2.2'
				10' 0.0'	0.0'	81	3.2'	3.2'	10' 5.8'	5.8'	53	4.3'	3.7'	5' 8.7'	8.7'	41	6.9'	3.2'	6' 6.0'	6.0'	80	3.9'	2.7'
				12' 0.0'	0.0'	56	3.8'	3.8'	12' 6.9'	6.9'	37	5.1'	4.4'	6' 10.4'	10.4'	28	8.2'	3.8'	7' 7.0'	7.0'	59	4.5'	3.1'
				14' 0.0'	0.0'	42	4.4'	4.4'	14' 8.1'	8.1'	27	6.0'	5.1'	7' 12.1'	12.1'	21	9.6'	4.4'	8' 8.0'	8.0'	45	5.2'	3.6'
LLAV11RNF Narrow Flood	24°	5,052	50,000	8' 0.0'	0.0'	79	3.4'	3.4'	8' 4.6'	4.6'	51	4.6'	3.9'	3' 5.2'	5.2'	70	5.9'	2.6'	4' 4.0'	4.0'	112	3.6'	2.4'
				10' 0.0'	0.0'	51	4.3'	4.3'	10' 5.8'	5.8'	33	5.8'	4.9'	4' 6.9'	6.9'	39	7.9'	3.4'	5' 5.0'	5.0'	71	4.5'	3.0'
				12' 0.0'	0.0'	35	5.1'	5.1'	12' 6.9'	6.9'	23	6.9'	5.9'	5' 8.7'	8.7'	25	9.8'	4.3'	6' 6.0'	6.0'	50	5.3'	3.6'
				14' 0.0'	0.0'	26	6.0'	6.0'	14' 8.1'	8.1'	17	8.1'	6.9'	6' 10.4'	10.4'	18	11.8'	5.1'	7' 7.0'	7.0'	36	6.2'	4.2'
LLAV11RF Flood	36°	2,924	50,000	6' 0.0'	0.0'	81	3.9'	3.9'	6' 3.5'	3.5'	53	5.4'	4.5'	2' 3.5'	3.5'	91	7.6'	2.6'	3' 3.0'	3.0'	115	4.4'	2.8'
				8' 0.0'	0.0'	46	5.2'	5.2'	8' 4.6'	4.6'	30	7.2'	6.0'	3' 5.2'	5.2'	41	11.4'	3.9'	4' 4.0'	4.0'	65	5.8'	3.7'
				10' 0.0'	0.0'	29	6.5'	6.5'	10' 5.8'	5.8'	19	9.0'	7.5'	4' 6.9'	6.9'	23	15.2'	5.2'	5' 5.0'	5.0'	41	7.3'	4.6'
				12' 0.0'	0.0'	20	7.8'	7.8'	12' 6.9'	6.9'	13	10.8'	9.0'	5' 8.7'	8.7'	15	19.0'	6.5'	6' 6.0'	6.0'	29	8.7'	5.5'

CBCP = Center Beam Candle Power.

© 2015 Koninklijke Philips N.V. All rights reserved.  
Philips reserves the right to make changes in specifications and/or to discontinue any product at any time without notice or obligation and will not be liable for any consequences resulting from the use of this publication.



Philips Lighting, North America Corporation  
200 Franklin Square Drive, Somerset, NJ 08873  
Tel. 855-486-2216

Philips Lighting Canada Ltd.  
281 Hillmount Road, Markham, ON, Canada L6C 2S3  
Tel. 800-668-9008