

Make the switch to LED.

C6LRDL CALCULITE LED 6" RETROFIT KIT

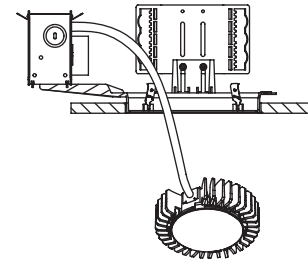

C6L15RR Series
Complete product =
light engine + retrofit kit

PHILIPS LIGHTOLIER, CALCULITE, PROFESSIONAL-GRADE DOWNLIGHTING, LED 6" RETROFIT KITS, A & B SERIES, C6LRDL

Calculite LED 6" retrofit kits are a viable solution that empower lighting professionals to change a legacy installation to today's latest LED technology. This retrofit kit provides a convenient path to the latest technology, an energy efficient solution, and provides architectural grade reflector optics and shielding from the source.

Project: _____

Location: _____

Catalog No: _____

Fixture Type: _____

Mfg: _____ Lamps: _____ Qty: _____

Notes: _____

Light Engine

Series	Dimming
C6L15RR35K	<input type="checkbox"/>
C6L15RR35K Calculite LED 6" 3500K light engine	1ELV 120V input, ELV dimmable 2 277V input, non-dimming

Retrofit Compatibility

example: C6LRDLACCLP

Series	Retrofit Series	Trim Finish	Trim Flange
C6LRDL	<input type="checkbox"/>	<input type="checkbox"/>	<input type="checkbox"/>
C6LRDL Calculite LED 6" Retrofit kit	A Compatible with Lightolier frame-in kits S6118, S6126, S6132, S6142, S6218, S6226 Series 6113, 6132, 6213, 6218, 6226 Series Compatible with Cooper frame-in kits C6042, C6142 Series B Compatible with Gotham frame-in kits 6" AF, 6" AFV Series	CCZ Bronze CL Clear CCL Comfort Clear CCD Comfort Clear Diffuse WH White	P Polished* (anodized only) W White

* Not available with **WH** Trim Finish.

Features

- Reflectors:** Series A aperture is 5 3/8" (137 mm) I.D., 7 1/4" (184mm) O.D. Series B aperture is 6 1/8" (156 mm) I.D.; 7 1/2" (190mm) O.D.
- Input Wattage:** 23.8 (1399 Lumens for A Series Clear finish, 1437 Lumens for B Series Clear Finish)
- Reflector Cone:** Aluminum. Provides 50° cutoff to source & source image. Self-flanged.
- Depth:** (not including Frame-in kit) 5 5/16" (135mm). Frame not included, varies by manufacturer.
- Power Connection:** Retro Fit kit installs by removing fluorescent ballast and wiring directly into retro fit kit leads. See instruction sheets C6L_RR Series and C6LRDL Series for more details.
- Optical mixing chamber:** Designed to provide a spacing ratio of 1.3 (A Series) and 1.2 (B Series)
- Lens:** Convex plastic lens has high transmission value with slight diffusion to provide a smooth consistent beam distribution.
- LED board:** Utilizes Philips Lumileds LED's.
- Thermal management:** Proprietary heat sink was developed using the latest in Computational Fluid Dynamics Software. This optimized thermal design provides a 50,000 hour lifetime at 70% lumen maintenance.
- Power supply:** Factory wired electronic LED driver (see Electrical section for specifications).
- Thermal protector:** Meets NEC and UL requirements. Do not install insulation above or within 3" (76mm) of any part of the luminaire.

Electrical

Electronic power supply: RoHS compliant Class 2 power unit for use in a damp or dry location. Unit tolerates sustained open circuit and short circuit output conditions without damage.

Dimming: All 120V luminaires are intended for use with TRIAC type dimmers. See LED-DIM spec sheet for latest dimming switch compatibility.

Input volts	Input freq.	Max. input current	Max. input power	Max. THD power
120VAC 277VAC	60Hz	250mA	25.5W	< 20%
Power Factor		Min. operating temp		Dimming signal
>.9		-40° C		TRIAC

Labels

UL (suitable for damp locations). 5 year warranty.



C6LRDL CALCULITE LED 6" RETROFIT KIT

Dimensions

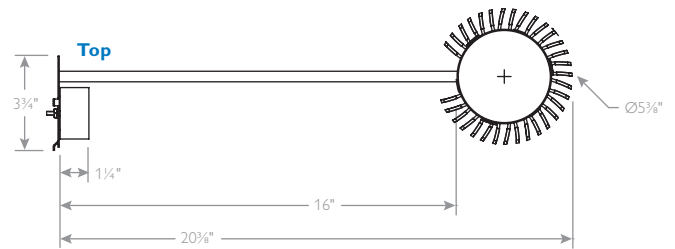

A Series

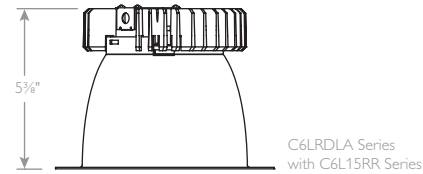
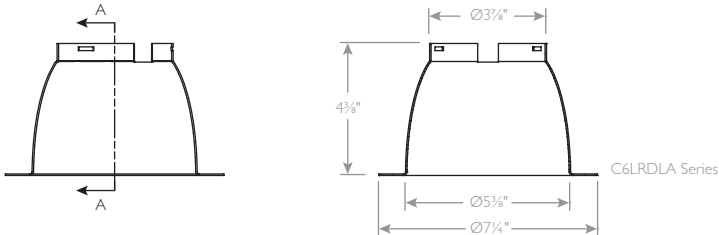

B Series

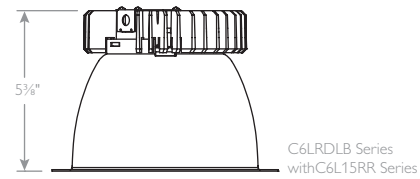
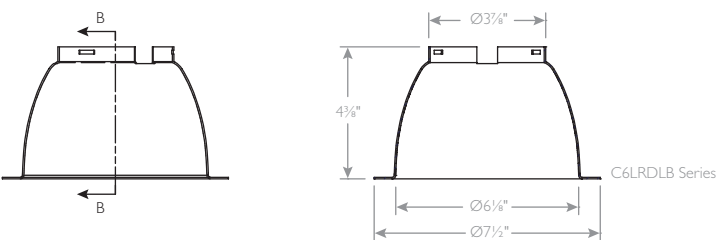

20W LED, 3500K, CCL finish trim (A Series)

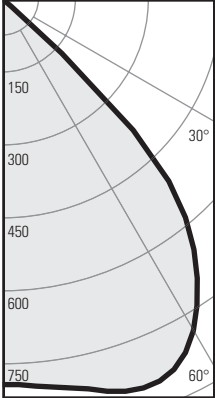
Candella Curves	Trim: C6LRDLACLCP	Angle	Mean CP	Lumens																
	Report number ³ :	69GFR	0	789																
			5	796	78															
	Output lumens:	1399 lms	10	809																
	CCT ¹ :	3500K	15	832	236															
	Input Watts ² :	23.8 W	20	848																
	Efficacy:	58.8 lm/w	25	837	383															
	CRI ⁴ :	80CRI	30	787																
	Spacing Criterion:	1.3	35	700	433															
			40	587																
			45	382	256															
Zonal lumens and percentages		50	28																	
		55	7	8																
		60	4																	
		65	2	3																
		70	2																	
		75	1	1																
		80	1																	
		85	0	1																
		90	0																	
<table><tr><th>Zone</th><th>Lumens</th><th>%Luminaire</th></tr><tr><td>0-30</td><td>696</td><td>49.8</td></tr><tr><td>0-40</td><td>1130</td><td>80.8</td></tr><tr><td>0-60</td><td>1394</td><td>99.7</td></tr><tr><td>0-90</td><td>1399</td><td>100</td></tr></table>		Zone	Lumens	%Luminaire	0-30	696	49.8	0-40	1130	80.8	0-60	1394	99.7	0-90	1399	100				
Zone	Lumens	%Luminaire																		
0-30	696	49.8																		
0-40	1130	80.8																		
0-60	1394	99.7																		
0-90	1399	100																		

20W LED, 3500K, CCL finish trim (B Series)

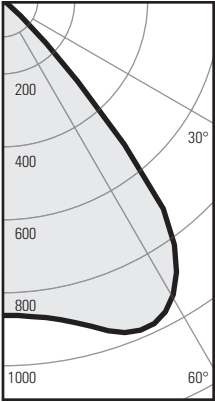
Candella Curves		Trim: C6LRDLBCLP		Angle	Mean CP	Lumens														
		Report number ³ :	71GFR	0	861															
				5	869	85														
		Output lumens:	1437 lms	10	888															
		CCT ¹ :	3500K	15	925	264														
		Input Watts ² :	23.8 W	20	968															
		Efficacy:	60.4 lm/w	25	977	446														
		CRI ⁴ :	80CRI	30	931															
		Spacing Criterion:	1.2	35	818	488														
				40	517															
				45	163	147														
Zonal lumens and percentages				50	16															
				55	3	4														
				60	2															
				65	1	1														
				70	1															
				75	1	1														
				80	1															
				85	1	1														
				90	0															
<table><tr><th>Zone</th><th>Lumens</th><th>%Luminaire</th></tr><tr><td>0-30</td><td>795</td><td>55.3</td></tr><tr><td>0-40</td><td>1283</td><td>49.3</td></tr><tr><td>0-60</td><td>1434</td><td>99.8</td></tr><tr><td>0-90</td><td>1437</td><td>100</td></tr></table>		Zone	Lumens	%Luminaire	0-30	795	55.3	0-40	1283	49.3	0-60	1434	99.8	0-90	1437	100				
Zone	Lumens	%Luminaire																		
0-30	795	55.3																		
0-40	1283	49.3																		
0-60	1434	99.8																		
0-90	1437	100																		

Tested using absolute photometry as specified in LM79: IESNA Approved Method for the Electrical and Photometric Measurements of Solid-State Lighting Products.

1. Correlated Color Temperature within specs as defined in ANSI_NEMA_ANSI C78.377-2008: Specifications for the Chromaticity of Solid-State Lighting Products.
2. Wattage controlled to within 5%.
3. Tested using absolute photometry as specified in LM79: IESNA Approved Method for the Electrical and Photometric Measurements of Solid-State Lighting Products.
4. Color Rendering Index within +/- 2%.



© 2013 Koninklijke Philips Electronics N.V. All rights reserved.
Specifications are subject to change without notice.
www.philips.com/luminaires

Philips Lighting Company
200 Franklin Square Drive
Somerset, NJ 08873
Phone: 855-486-2216

Philips Lighting Company
281 Hillmount Road
Markham ON, Canada L6C 2S3
Phone: 800-668-9008