

# Opalescent

## Recessed 1'X4' Luminaire, LED

Page 1 of 3

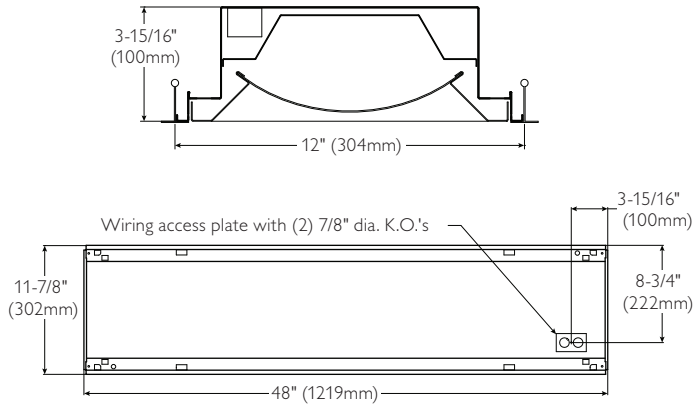

### Ordering Information

Opalescent	Body Style	Fixture Size	Ceiling Type	Lens	Lumen Category	Color Temp.	Voltage	Driver Type	Options
<b>OP</b> Direct Recessed Luminaire	<b>S</b> S = Static	<b>14</b> 14 = 1' X 4' (Nominal size)	<b>G</b> G = Standard Grid	<b>PW</b> PW = High light transmission frost white acrylic lens.	26A = 2600 lumens 34A = 3400 lumens 39A = 3900 lumens 43A = 4300 lumens (Approximate delivered values. Consult IES file)	<b>40</b> 40 = 4000K Consult representative for other color temperature options. (Approximate values. Consult IES file)	<b>U</b> U = Universal 120-277v	<b>LAG</b> LAG = LED Driver Consult representative for dimming options	- Add appropriate suffix to catalog no., i.e.: (C)

### Features

- Bold but simple 1-3/8" regressed frame with contoured lens.
- High light transmission frost white acrylic lens.
- Can provide 49 initial footcandles at 0.56 watts per square foot.
- Delivers 3910 lumens with just 45 input watts.
- Field replaceable LED array and drivers accessible from below.
- Integrated thermal management system conducts heat away from LEDs and transfers it to the surrounding environment.
- Intelligent driver technology, our LitePlane platform, is a factory calibrated system providing the customer multiple lumen outputs to balance energy savings with lighting application needs.
- High efficiency LEDs have 50,000 hour rated life at L<sub>70</sub>.
- Predicted L70 lifetime is based on LED manufacturer's supplied LM-80 data and in-situ laboratory testing.
- Door jamb finished black on four sides for positive light stop.
- Spring loaded rooster head latches.
- 18 gauge steel hinges.
- 3-15/16" deep body.
- Black body to dissipate heat from LEDs.
- Earthquake/Hold-down clips.
- Construction to meet NYC Code Requirements or Chicago Plenum is available.
- Suitable for continuous row mounting.
- Five-year warranty on luminaire, LED boards and driver.

Job Information	Type:
Job Name:	
Cat. No.:	
Notes:	

**PHILIPS**  
**LIGHTOLIER**

# Opalescent

## Recessed 1'X4' Luminaire, LED

Page 2 of 3

### Specifications

**Materials:** Chassis parts are die-formed code gauge cold rolled steel. Housing ends turned-in for safe handling

**Finish: Chassis exterior**—black baked polyester enamel.

**Cavity**—white baked polyester enamel minimum 95% reflectance. Rust preventative undercoating.

**Lens: PW**—High light transmission frost white acrylic lens.

**Electrical:** LED boards and drivers are RoHS (Restriction of Hazardous Substances) compliant. For dimming options consult factory.

**Labels:** I.B.E.W. UL and ULc Listed.

### Options/Accessories

**Electrical Wiring Options:** Consult factory.

**Drywall Kit:** Order Catalog Number: **FK91X4**.

**Fusing:** Internal fast blow fusing: Suffix: **A**.  
Internal slow blow fusing: Suffix: **C**.

**Chicago Plenum:** Suffix: **C**.

### Mounting Methods

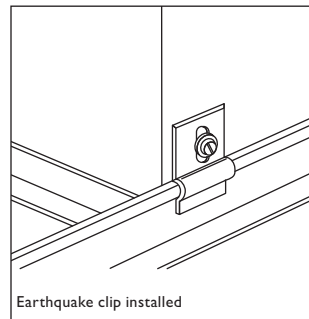
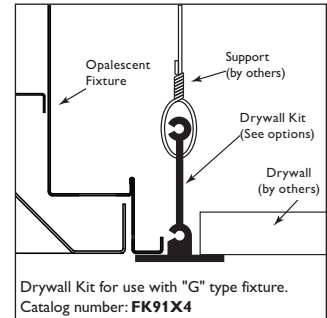
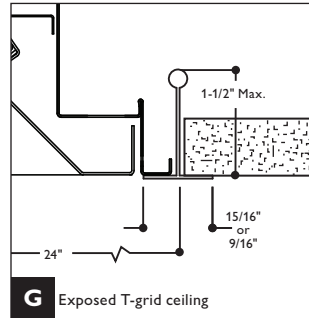

Job Information Type:

**PHILIPS**  
**LIGHTOLIER**

# Opalescent

## Recessed 1'X4' Luminaire, LED

Page 3 of 3

### Photometry

Report Number<sup>1</sup>: G2011042  
 Catalog Number: OPS14GPW39A40ULAG  
 Delivered Lumens: 3910  
 Correlated Color Temp.<sup>2</sup>: 3948K  
 Input Watts: 44.8  
 Efficacy: 87.3 lm/w  
 CRI: 84.5  
 Lamp: LED  
 Luminaire: Opalescent Recessed LED 1' x 4' fixture with contoured lens frame.  
 CIE Type: Direct/Indirect  
 Plane: 0-Deg. 90-Deg.  
 Shielding Angles: 90 90  
 Plane: 0-Deg. 90-Deg.  
 Luminous Length: 45.4800 9.480

### Candela Distribution

Vertical Angle	Horizontal Angle			Zonal Lumens
	0	45	90	
0	1697	1697	1697	
5	1673	1684	1698	145
15	1585	1603	1622	408
25	1418	1447	1471	600
35	1187	1224	1240	689
45	914	953	943	664
55	640	657	591	541
65	395	371	309	360
75	200	157	128	177
85	52	28	20	36
90	6	5	5	

<sup>1</sup> Tested using absolute photometry as specified in LM79: IESNA Approved Method for the Electrical and Photometric Measurements of Solid-State Lighting Products.

<sup>2</sup> Correlated Color Temperature within specs as defined in ANSI\_NEMA\_ANSI C78.377-2008: Specifications for the Chromaticity of Solid State Lighting Products.

### Coefficients of Utilization

Ceiling	80%			50%			30%		
	70	50	30	50	30	10	50	30	10
RC	Zonal Cavity Method								
RW	Effective Floor Reflectance = 20%								
1	110	106	102	99	96	94	95	93	91
2	101	93	87	88	83	79	85	81	77
3	93	83	75	78	72	68	76	71	66
4	85	74	66	70	64	58	68	62	58
5	79	67	58	63	56	51	62	55	51
6	73	60	52	58	51	45	56	50	45
7	68	55	47	53	46	40	51	45	40
8	63	50	42	48	41	36	47	41	36
9	59	46	38	45	38	33	44	37	33
10	56	43	35	41	35	30	40	34	30

### Average Luminance data in candela / sq. meter

Angle	0°	45°	90°
45	4645.	4843.	4793.
55	4010.	4116.	3703.
65	3359.	3155.	2628.
75	2777.	2180.	1777.
85	2144.	1155.	825.

### Zonal Lumen Summary\*

Zone	Lumens	% Lamp	% Fixt.
0-30	1280	32.7	32.7
0-40	2043	52.2	52.2
0-60	3336	85.3	85.3
0-90	3910	100.0	100.0
0-180	3619	100.0	100.0

\*Total Efficiency

### Additional Ordering Information

Catalog Number	Delivered Lumens	Input Watts	Lumens per Watt	Average initial 8'X8' footcandles	8'X8' Watts per sq. foot	Average initial 8'X10' footcandles	8'X10' Watts per sq. foot
OPS14GPW26A40ULAG	2636	30.1	87.6	41.2	0.47	33.0	0.38
OPS14GPW34A40ULAG	3416	38.1	89.7	53.4	0.60	42.7	0.48
OPS14GPW39A40ULAG	3910	44.8	87.3	61.1	0.70	48.9	0.56
OPS14GPW43A40ULAG	4306	52.9	81.4	67.3	0.83	53.8	0.66



Philips Lightolier  
 e: [lol.webmaster@philips.com](mailto:lol.webmaster@philips.com)  
 t: (508) 679-8131, Technical info. (978) 657-7600  
 w: [www.lightolier.com](http://www.lightolier.com)

OPS14GPW March 7, 2012

Specifications are subject to change without notice.  
 © Koninklijke Philips Electronics N.V., 2012. All rights reserved.

Job Information Type: