

Module Ordering Information

Family	Lamps	Lamp Type	Shielding	Voltage	Length	Options	Options (Cont'd.)
PTS5	2						
	2 = 2 Lamps	S = Standard H = HO	O = Open L = Lens S = Straight Blade Louver	1 = 120V 2 = 277V 3 = 347V D1 = 120V Dim. D2 = 277V Dim. E1 = 120V Emerg. E2 = 277V Emerg.	2 = Two-Foot 3 = Three-Foot 4 = Four-Foot 6 = Six-Foot 8 = Eight-Foot	Blank = No Options A = Adjustable* AS = Adjustable Staggered* S = Staggered X4 = 4 thru wires X5 = 5 thru wires	A4 = Adjustable 4 thru wires* A5 = Adjustable 5 thru wires* S4 = Staggered 4 thru wires S5 = Staggered 5 thru wires B4 = Adjustable Staggered 4 thru wires* B5 = Adjustable Staggered 5 thru wires*

* only available on Two-Foot, Three-Foot and Four-Foot versions. See length variations of adjustable fixtures on page 2.

Features

- Housing:** Die-formed 20 gauge pre-painted steel. Integral heavy gauge bulkheads support housing and trim, permitting modules to be bolted together in continuous runs and facilitate suspension.
- Lamping:** Cross-sectional two linear T5 fluorescent lamps. Provided by others.
- Reflector:** Precision parabolic roll-formed semi-specular aluminum.
- Louvers:** Lift and shift straight blade louvers constructed from die-formed aluminum and painted to match housing. Louver blades are 1" (2.54cm) high on 1-1/8" (2.86cm) centers. (Optional)

Mounting

"J" Rail is first mounted to the wall and the modules connect to the rail for 1/4" (0.64cm) wall adjustment. Modules are hung from suspension wires attached to the fixture bulkheads and the structure above.

Electrical

Electronic Ballast: Programmed start, 3 conductor, 12 gauge wire. Color-coded quick connectors allow easy connection for modular fixtures. Factory installed ballast disconnect allows the ballast to be disconnected from and reconnected to incoming power under load without turning the entire circuit off.

Dimming: T5 lamp uses PowerSpec® HDF. Use PowerSpec® HDF compatible three-wire control (extra control lead required).

T5 HO lamp uses Advance Mark X. Use Advance compatible two-wire control (no extra control lead required).

Emergency Battery Pack: 450 Lumens @ 90 minimum.

Ordering Instructions

Individual Fixtures:

- Order number of MODULES required.
- Order one END SET per MODULE.

Continuous Rows:

- Determine run length.
- Order the appropriate number of MODULES for the complete ROW.
- Stagger rows must be completed with an adjustable module. (2-light only)
- Non-stagger rows must be completed with an adjustable module unless row lengths are in precise 1 foot (30.48cm) intervals.
- Order one END SET per ROW.

Labels

UL, cUL and IBEW

Job Information

Type:

Job Name:

Cat. No.:

Lamp(s):

Notes:

631 Airport Road, Fall River, MA 02720 • (508) 679-8131 • Fax (508) 674-4710
We reserve the right to change details of design, materials and finish.
www.lightolier.com © 2008 Philips Group • C0908

Performance & Quick Calculators

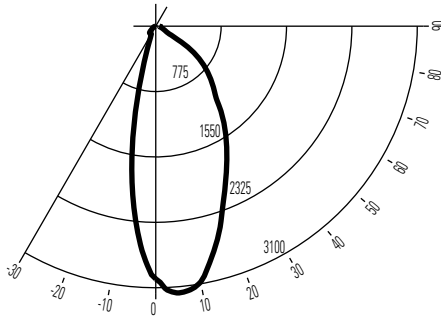

Report No: ITL53560
Cat No: PTS52HS14
Lamps: 2 F54T5
Lumens: 5000
Efficiency: 30.3%

ZONE DEG.	CANDLEPOWER				
	0	45	90	135	180
180	0	0	0	0	0
175	0	0	0	0	0
165	0	0	0	0	0
155	0	0	0	0	0
145	0	0	0	0	0
135	0	0	0	0	0
125	0	0	0	0	0
115	0	0	0	0	0
105	0	0	0	0	0
95	0	0	0	0	0
90	41	49	0	0	0
85	51	68	23	17	0
75	67	13	89	73	16
65	122	368	179	146	32
55	565	476	287	203	51
45	942	780	619	225	101
35	1411	1304	1298	217	106
25	1974	1998	1967	391	150
15	2715	3769	2529	1341	775
5	3174	3119	2922	2601	2457
0	2996	2996	2996	2996	2996

ROOM CAVITY RATIO	COEFFICIENTS OF UTILIZATION								
	% EFFECTIVE CEILING CAVITY REFLECTANCE								
	80			70			50		
	% WALL REFLECTANCE								
	70			50			30		
0	36	36	36	35	35	35	34	34	34
1	34	32	31	33	32	31	31	30	29
2	31	29	28	31	29	27	28	26	25
3	29	27	25	28	26	24	25	24	22
4	27	24	22	27	24	22	23	21	20
5	25	22	20	25	22	20	21	20	18
6	24	21	18	23	20	18	20	18	17
7	23	19	17	22	19	17	18	17	15
8	21	18	16	21	18	16	17	15	14
9	20	17	15	20	16	14	16	14	13
10	19	16	14	19	15	13	15	13	12

Floor cavity reflectance = 20%

ZONAL LUMEN SUMMARY

ZONE	LUMENS	% BARELAMP	% LUMINAIRE
0-90	3026	30.3	100.0
90-180	0.0	0.0	0.0
0-180	3026	30.3	100.0

Sample Run

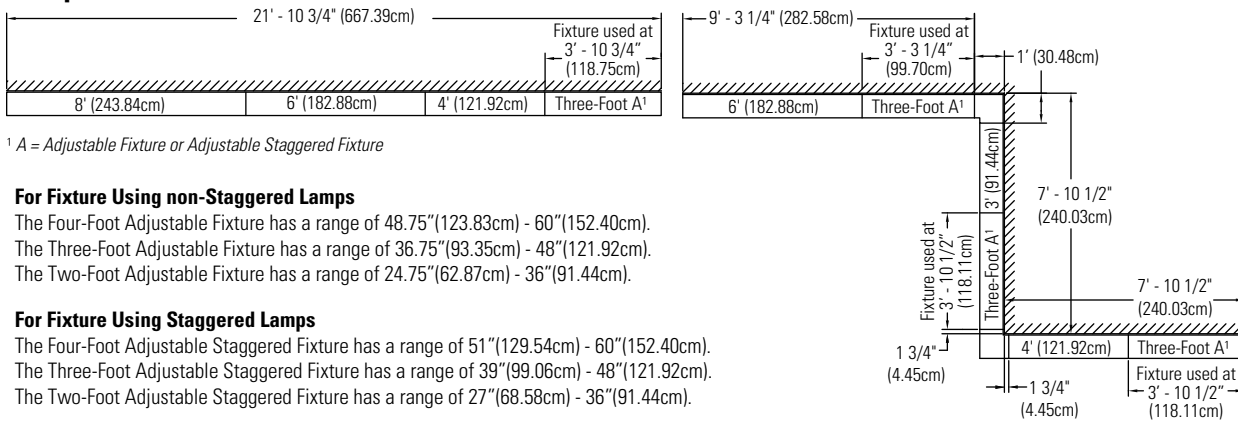

¹ A = Adjustable Fixture or Adjustable Staggered Fixture

For Fixture Using non-Staggered Lamps

The Four-Foot Adjustable Fixture has a range of 48.75"(123.83cm) - 60"(152.40cm).
 The Three-Foot Adjustable Fixture has a range of 36.75"(93.35cm) - 48"(121.92cm).
 The Two-Foot Adjustable Fixture has a range of 24.75"(62.87cm) - 36"(91.44cm).

For Fixture Using Staggered Lamps

The Four-Foot Adjustable Staggered Fixture has a range of 51"(129.54cm) - 60"(152.40cm).
 The Three-Foot Adjustable Staggered Fixture has a range of 39"(99.06cm) - 48"(121.92cm).
 The Two-Foot Adjustable Staggered Fixture has a range of 27"(68.58cm) - 36"(91.44cm).

End Plate and Corner Block Accessories

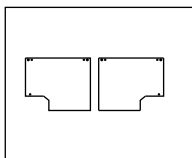

End Cap Set:
PTSEP

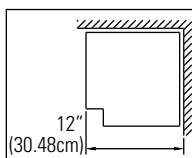

90° Inside Corner:
 PTS90INCO - Open
 PTS90INCL - Lens
 PTS90INCS - Straight
 Blade Louver

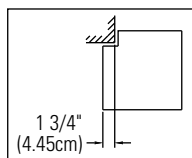

90° Outside Corner:
 PTS90OTCO - Open
 PTS90OTCL - Lens
 PTS90OTCS - Straight
 Blade Louver

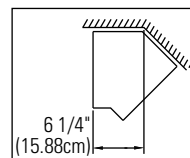

135° Inside Corner:
 PTS135INCO - Open
 PTS135INCL - Lens
 PTS135INCS - Straight
 Blade Louver

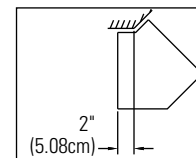

135° Outside Corner:
 PTS135OTCO - Open
 PTS135OTCL - Lens
 PTS135OTCS - Straight
 Blade Louver

Job Information	Type:
-----------------	-------

631 Airport Road, Fall River, MA 02720 • (508) 679-8131 • Fax (508) 674-4710
 We reserve the right to change details of design, materials and finish.
 www.lightolier.com © 2008 Philips Group • C0908