

### Module Ordering Information

Family	Lamps	Shielding	Voltage	Length	Options
<b>PTS8</b>	<b>1</b> 1 = 1 Lamp	<input type="checkbox"/> O = Open L = Lens S = Straight Blade Louver	<input type="checkbox"/> 1 = 120V 2 = 277V 3 = 347V D1 = 120V Dim. D2 = 277V Dim. E1 = 120V Emerg. E2 = 277V Emerg.	<input type="checkbox"/> 2 = Two-Foot 3 = Three-Foot 4 = Four-Foot 6 = Six-Foot 8 = Eight-Foot	<input type="checkbox"/> Blank = No Options A = Adjustable* X4 = 4 thru wires X5 = 5 thru wires A4 = Adjustable 4 thru wires* A5 = Adjustable 5 thru wires*

\* only available on Two-Foot, Three-Foot and Four-Foot versions. See length variations of adjustable fixtures on page 2.

### Features

- Housing:** Die-formed 20 gauge pre-painted steel. Integral heavy gauge bulkheads support housing and trim, permitting modules to be bolted together in continuous runs and facilitate suspension.
- Lamping:** Cross-sectional one linear T8 fluorescent lamp. Provided by others.
- Reflector:** Precision parabolic roll-formed semi-specular aluminum.
- Louver:** Lift and shift straight blade louver constructed from die-formed aluminum and painted to match housing. Louver blades are 1" (2.54cm) high on 1-1/8" (2.86cm) centers. (Optional)

### Mounting

"J" Rail is first mounted to the wall and the modules connect to the rail for 1/4" (0.64cm) wall adjustment. Modules are hung from suspension wires attached to the fixture bulkheads and the structure above.

### Electrical

**Electronic Ballast:** Programmed start, 3 conductor, 12 gauge wire. Color-coded quick connectors allow easy connection for modular fixtures. Factory installed ballast disconnect allows the ballast to be disconnected from and reconnected to incoming power under load without turning the entire circuit off.

**Dimming:** Advance Mark X, use Advance compatible two-wire control (no extra control lead required).

**Emergency Battery Pack:** 450 Lumens @ 90 minimum.

### Ordering Instructions

#### Individual Fixtures:

- Order number of MODULES required.
- Order one END SET per MODULE.

#### Continuous Rows:

- Determine run length.
- Order the appropriate number of MODULES for the complete ROW.
- Stagger rows must be completed with an adjustable module. (2-light only)
- Non-stagger rows must be completed with an adjustable module unless row lengths are in precise 1 foot (30.48cm) intervals.
- Order one END SET per ROW.

### Labels

UL, cUL and IBEW

Job Information	Type:
<b>Job Name:</b>	
<b>Cat. No.:</b>	
<b>Lamp(s):</b>	
<b>Notes:</b>	

631 Airport Road, Fall River, MA 02720 • (508) 679-8131 • Fax (508) 674-4710  
 We reserve the right to change details of design, materials and finish.  
 www.lightolier.com © 2008 Philips Group • D1008

### Performance & Quick Calculators

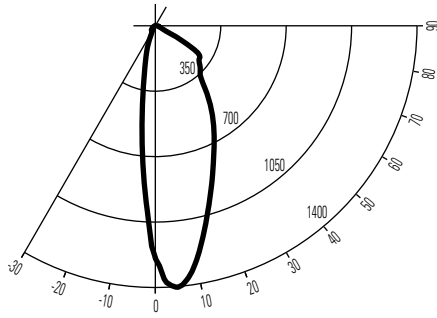

**Report No:** ITL53557  
**Cat No:** PTS81S14  
**Lamps:** 1 F32T8  
**Lumens:** 2900  
**Efficiency:** 39.4%

ZONE DEG.	CANDLEPOWER				
	0	45	90	135	180
180	0	0	0	0	0
175	0	0	0	0	0
165	0	0	0	0	0
155	0	0	0	0	0
145	0	0	0	0	0
135	0	0	0	0	0
125	0	0	0	0	0
115	0	0	0	0	0
105	0	0	0	0	0
95	0	0	0	0	0
90	12	22	0	0	0
85	16	27	7	9	0
75	21	52	33	33	6
65	43	162	65	59	12
55	297	171	110	85	19
45	340	280	243	86	31
35	509	478	527	89	31
25	742	770	800	159	64
15	1064	1145	1040	346	215
5	1604	1398	1208	927	763
0	1244	1244	1244	1244	1244

### COEFFICIENTS OF UTILIZATION

ROOM CAVITY RATIO	% EFFECTIVE CEILING CAVITY REFLECTANCE								
	80			70			50		
	% WALL REFLECTANCE								
	70	50	30	70	50	30	50	30	10
0	47	47	47	46	46	43	44	44	44
1	44	42	41	43	41	40	40	39	38
2	41	38	36	40	37	35	36	34	33
3	38	34	32	37	34	31	33	31	29
4	35	31	29	35	31	28	30	28	26
5	33	29	26	32	28	26	28	25	23
6	31	27	24	30	26	24	26	23	21
7	29	25	22	29	24	22	24	21	20
8	28	23	20	27	23	20	22	20	18
9	26	22	19	26	21	19	21	19	17
10	25	20	18	24	20	17	20	17	16

Floor cavity reflectance = 20%

### ZONAL LUMEN SUMMARY

ZONE	LUMENS	% BARELAMP	% LUMINAIRE
0-90	1162	39.4	100.0
90-180	0	0.0	0.0
0-180	1162	39.4	100.0

### Sample Run

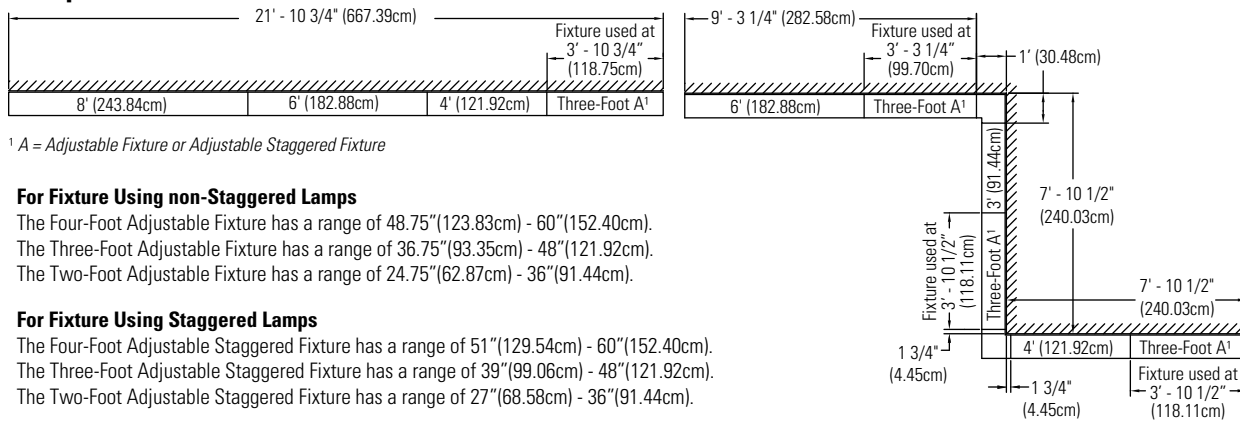

¹ A = Adjustable Fixture or Adjustable Staggered Fixture

#### For Fixture Using non-Staggered Lamps

The Four-Foot Adjustable Fixture has a range of 48.75" (123.83cm) - 60" (152.40cm).  
 The Three-Foot Adjustable Fixture has a range of 36.75" (93.35cm) - 48" (121.92cm).  
 The Two-Foot Adjustable Fixture has a range of 24.75" (62.87cm) - 36" (91.44cm).

#### For Fixture Using Staggered Lamps

The Four-Foot Adjustable Staggered Fixture has a range of 51" (129.54cm) - 60" (152.40cm).  
 The Three-Foot Adjustable Staggered Fixture has a range of 39" (99.06cm) - 48" (121.92cm).  
 The Two-Foot Adjustable Staggered Fixture has a range of 27" (68.58cm) - 36" (91.44cm).

### End Plate and Corner Block Accessories

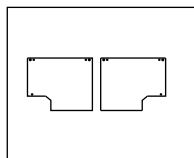

**End Cap Set:**  
PTSEP

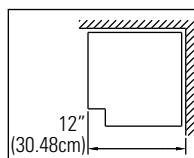

**90° Inside Corner:**  
 PTS90INCO - Open  
 PTS90INCL - Lens  
 PTS90INCS - Straight Blade Louver

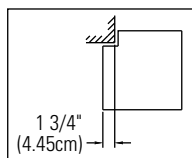

**90° Outside Corner:**  
 PTS90OTCO - Open  
 PTS90OTCL - Lens  
 PTS90OTCS - Straight Blade Louver

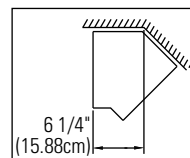

**135° Inside Corner:**  
 PTS135INCO - Open  
 PTS135INCL - Lens  
 PTS135INCS - Straight Blade Louver

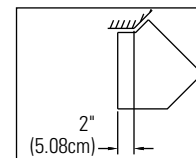

**135° Outside Corner:**  
 PTS135OTCO - Open  
 PTS135OTCL - Lens  
 PTS135OTCS - Straight Blade Louver

### Job Information Type:

631 Airport Road, Fall River, MA 02720 • (508) 679-8131 • Fax (508) 674-4710  
 We reserve the right to change details of design, materials and finish.  
 www.lightolier.com © 2008 Philips Group • D1008