

### Module Ordering Information

Family	Lamps	Shielding	Voltage	Length	Options	
<b>PTS8</b>	<b>2</b> 2 = 2 Lamps	<input type="checkbox"/> O = Open L = Lens S = Straight Blade Louver	<input type="checkbox"/> 1 = 120V 2 = 277V 3 = 347V D1 = 120V Dim. D2 = 277V Dim. E1 = 120V Emerg. E2 = 277V Emerg.	<input type="checkbox"/> 2 = Two-Foot 3 = Three-Foot 4 = Four-Foot 6 = Six-Foot 8 = Eight-Foot	<input type="checkbox"/> Blank = No Options A = Adjustable* AS = Adjustable Staggered* S = Staggered X4 = 4 thru wires X5 = 5 thru wires	<input type="checkbox"/> A4 = Adjustable 4 thru wires* A5 = Adjustable 5 thru wires* S4 = Staggered 4 thru wires S5 = Staggered 5 thru wires B4 = Adjustable Staggered 4 thru wires* B5 = Adjustable Staggered 5 thru wires*

\* only available on Two-Foot, Three-Foot and Four-Foot versions. See length variations of adjustable fixtures on page 2.

### Features

- Housing:** Die-formed 20 gauge pre-painted steel. Integral heavy gauge bulkheads support housing and trim, permitting modules to be bolted together in continuous runs and facilitate suspension.
- Lamping:** Cross-sectional two linear T8 fluorescent lamps. Provided by others.
- Reflector:** Precision parabolic roll-formed semi-specular aluminum.
- Louver:** Lift and shift straight blade louver constructed from die-formed aluminum and painted to match housing. Louver blades are 1" (2.54cm) high on 1-1/8" (2.86cm) centers. (Optional)

### Mounting

"J" Rail is first mounted to the wall and the modules connect to the rail for 1/4" (0.64cm) wall adjustment. Modules are hung from suspension wires attached to the fixture bulkheads and the structure above.

### Electrical

**Electronic Ballast:** Programmed start, 3 conductor, 12 gauge wire. Color-coded quick connectors allow easy connection for modular fixtures. Factory installed ballast disconnect allows the ballast to be disconnected from and reconnected to incoming power under load without turning the entire circuit off.

**Dimming:** Advance Mark X, use Advance compatible two-wire control (no extra control lead required).

**Emergency Battery Pack:** 450 Lumens @ 90 minimum.

### Ordering Instructions

#### Individual Fixtures:

- Order number of MODULES required.
- Order one END SET per MODULE.

#### Continuous Rows:

- Determine run length.
- Order the appropriate number of MODULES for the complete ROW.
- Stagger rows must be completed with an adjustable module. (2-light only)
- Non-stagger rows must be completed with an adjustable module unless row lengths are in precise 1 foot (30.48cm) intervals.
- Order one END SET per ROW.

### Labels

UL, cUL and IBEW

### Job Information

### Type:

**Job Name:**

**Cat. No.:**

**Lamp(s):**

**Notes:**

631 Airport Road, Fall River, MA 02720 • (508) 679-8131 • Fax (508) 674-4710  
We reserve the right to change details of design, materials and finish.  
www.lightolier.com © 2008 Philips Group • D1008

## Performance & Quick Calculators

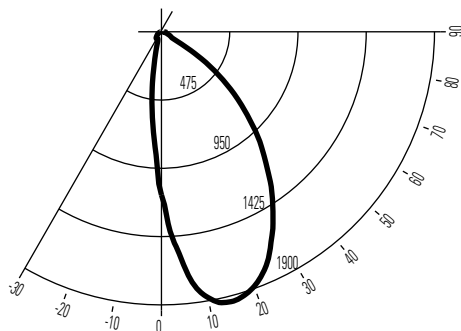

**Report No:** ITL53558  
**Cat No:** PTS82S14  
**Lamps:** 2 F32T8  
**Lumens:** 2950  
**Efficiency:** 31.8%

ZONE DEG.	CANDLEPOWER				
	0	45	90	135	180
180	0	0	0	0	0
175	0	0	0	0	0
165	0	0	0	0	0
155	0	0	0	0	0
145	0	0	0	0	0
135	0	0	0	0	0
125	0	0	0	0	0
115	0	0	0	0	0
105	0	0	0	0	0
95	0	0	0	0	0
90	17	43	0	0	0
85	23	50	12	14	0
75	35	87	54	52	12
65	66	248	101	96	23
55	394	387	163	137	3
45	873	674	292	144	49
35	1337	1104	545	128	59
25	1754	1499	771	142	59
15	1940	1698	971	320	161
5	1587	1460	1115	804	670
0	1135	1135	1135	1135	1135

ROOM CAVITY RATIO	COEFFICIENTS OF UTILIZATION								
	% EFFECTIVE CEILING CAVITY REFLECTANCE								
	80			70			50		
	% WALL REFLECTANCE								
	70			50			30		
0	38	38	38	37	37	37	35	35	35
1	35	34	33	34	33	32	32	31	30
2	33	30	29	32	30	28	29	27	26
3	30	27	25	30	27	25	26	24	23
4	28	25	22	27	24	22	24	22	20
5	26	23	20	26	22	20	22	20	18
6	24	21	18	24	20	18	20	18	16
7	23	19	17	22	19	16	18	16	15
8	21	18	15	21	17	15	17	15	13
9	20	16	14	20	16	14	16	14	12
10	19	15	13	19	15	13	15	13	11

Floor cavity reflectance = 20%

ZONAL LUMEN SUMMARY			
ZONE	LUMENS	% BARELAMP	% LUMINAIRE
0-90	1878	31.8	100.0
90-180	0.0	0.0	0.0
0-180	1878	31.8	100.0

## Sample Run

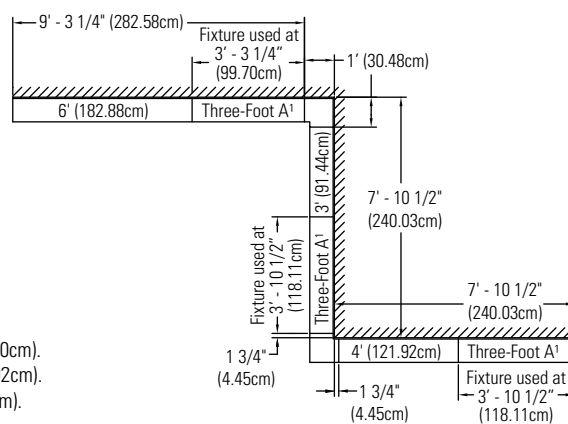
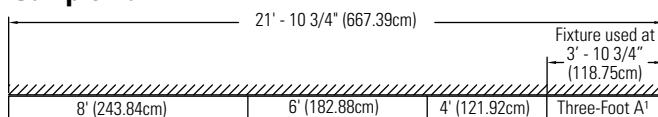

<sup>1</sup> A = Adjustable Fixture or Adjustable Staggered Fixture

### For Fixture Using non-Staggered Lamps

The Four-Foot Adjustable Fixture has a range of 48.75"(123.83cm) - 60"(152.40cm).  
 The Three-Foot Adjustable Fixture has a range of 36.75"(93.35cm) - 48"(121.92cm).  
 The Two-Foot Adjustable Fixture has a range of 24.75"(62.87cm) - 36"(91.44cm).

### For Fixture Using Staggered Lamps

The Four-Foot Adjustable Staggered Fixture has a range of 51"(129.54cm) - 60"(152.40cm).  
 The Three-Foot Adjustable Staggered Fixture has a range of 39"(99.06cm) - 48"(121.92cm).  
 The Two-Foot Adjustable Staggered Fixture has a range of 27"(68.58cm) - 36"(91.44cm).

## End Plate and Corner Block Accessories

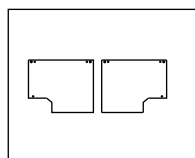

**End Cap Set:**  
PTSEP

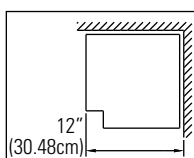

**90° Inside Corner:**  
 PTS90INCO - Open  
 PTS90INCL - Lens  
 PTS90INCS - Straight  
 Blade Louver

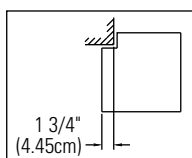

**90° Outside Corner:**  
 PTS90OTCO - Open  
 PTS90OTCL - Lens  
 PTS90OTCS - Straight  
 Blade Louver

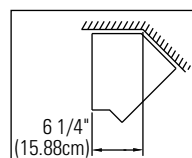

**135° Inside Corner:**  
 PTS135INCO - Open  
 PTS135INCL - Lens  
 PTS135INCS - Straight  
 Blade Louver

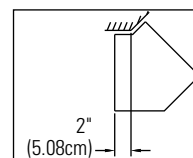

**135° Outside Corner:**  
 PTS135OTCO - Open  
 PTS135OTCL - Lens  
 PTS135OTCS - Straight  
 Blade Louver

Job Information	Type:
-----------------	-------

631 Airport Road, Fall River, MA 02720 • (508) 679-8131 • Fax (508) 674-4710  
 We reserve the right to change details of design, materials and finish.  
 www.lightolier.com © 2008 Philips Group • D1008