

PHILIPS Day-Brite CFI

Recessed

SpecPlus 2x2

T8, T5, or T5HO

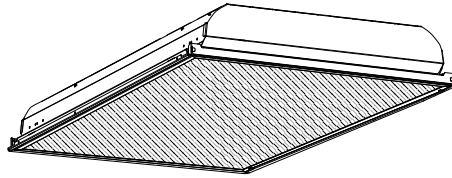

Project: _____
 Location: _____
 Cat.No: _____
 Type: _____
 Lamps: _____ Qty: _____
 Notes: _____

The Philips Day-Brite / CFI SpecPlus recessed offers specification grade quality and features. Built-in grid clips with positive clamping by screws, easy re-lamping, and 475 sq. inch lens area puts this luminaire in the lead on performance, safety and ease of maintenance.

Ordering guide

example: SPS2GFSVA26UUNV-1/2-EB

Family	Air Function	Width	Ceiling Type	Lens Frame	Lens Shielding	Lamp Quantity	Lamp Type	Voltage	Options
SP	S	2						-	
SP SpecPlus Lensed Troffer	S Static	2 2'	G Grid (lay-in T bar) F Flanged (over lap) Z spline and plaster frame	FS Flat steel RA Regressed aluminum FA Flat aluminum	VA Pattern 12 prismatic acrylic, .095" nominal VI Pattern 12, .125" nominal VY K-12, .125" nominal KA Pattern 19, .156" nominal BP 1/2"x1/2"x1/2" silver plastic louver, polystyrene AP 1/2"x1/2"x1/2" silver plastic louver, acrylic MC 1.5"x1.5"x1" silver plastic louver, polystyrene ML 1.5"x1.5"x1" silver plastic louver, acrylic SE 3/4"x3/4"x3/8" silver plastic louver, polystyrene SF 3/4"x3/4"x3/8" silver plastic louver, acrylic	2 2 lamp 3 3 lamp 4 4 lamp	2U* T8, 1-5/8" U lamp 6U** T8, 6" U lamp 14 14WT5 17 17WT8 24 24WT5HO	UNV Universal voltage, 120-277V 120 120V 277 277V 347 347V	1/2 One 2-lamp ballast 1/3 One 3-lamp ballast 1/21 2-lamp & 1-lamp ballasts 1/4 One 4-lamp ballast 2/2 Two 2-lamp ballasts EB Electronic ballast, < 10% THD std. ballast factor EB10R T8 electronic ballast, <10% THD, program rapid start EBHE T8 electronic ballast, high efficiency std. ballast factor EBLHE T8 electronic ballast, high efficiency low ballast factor EBHHE T8 electronic ballast, high efficiency high ballast factor EBD7 Advance Mark 7 dimming ballast, 0-10V (low voltage) control EBDX Advance Mark 10 dimming ballast, phase control EBSD T8 electronic step dimming ballast, .88 ballast factor EBD Electronic dimming ballast, customer specified E1 B100 emerg. ballast, T8, 350-450 lumens, 120/277V E1CAN B100-CAN emerg. ballast, Canada market, T8, 350-450 lumens, 120/347V E7 B60 emerg. ballast, T8, 600-700 lumens, 120/277V E5 B50 emerg. ballast, U.S. or Canada market, T8, 1100-1400 lumens, UNV E5CAN B50-CAN emerg. ballast, Canada market, T8, 1100-1400 lumens, 120/347V E5ST B50ST emerg. ballast w/self test, U.S. or Canada market, T8, 1100-1400 lumens, UNV E7LP LP550 emerg. ballast T5/T5HO, 430-700 lumens, 120/277V E6LP LP600 emerg. ballast U.S. or Canada market, T5/T5HO, 750-1325 lumens, 120/277V F1 3/8" flex, 3 wire 18 gauge 6' F2 3/8" flex, 4 wire 18 gauge 6' F2/5W 3/8" flex, 5 wire 18 gauge 6' GLR Fusing, fast blow LPT830 Installed T8/T5 lamps, 80+ CRI, 3000K LPT835 Installed T8/T5 lamps, 80+ CRI, 3500K LPT841 Installed T8/T5 lamps, 80+ CRI, 4100K LPT830HL Installed T8/T5 hi lumen lamps, 80+ CRI, 3000K LPT835HL Installed T8/T5 hi lumen lamps, 80+ CRI, 3500K LPT841HL Installed T8/T5 hi lumen lamps, 80+ CRI, 4100K 1W 1-way gasketing, between lens & door frame 2W 2-way gasketing, 1W + gasketing between door frame & housing 3W 3-way gasketing, 2W + gasketing for field installation between housing & ceiling PAF Housing painted after fabrication

Accessories (order separately)

- FMA22 – 2'x2' "F" mounting frame for NEMA "F" installations
- Electrical wiring options – consult factory

SPS SpecPlus 2x2

T8, T5, or T5HO

Features

- 5" deep body.
- 3-1/16" lamp to lens for better lamp obscuration.
- 71.6% efficient (2 – 6" U lamp), 67.9% efficient (3 – 1-5/8" U lamp).
- Clean contoured interior, no holes.
- Hemmed over side rails for maximum safety.
- Fixture ends turned-in for safe handling.
- Built-in earthquake clips.
- Slimline door frame with 475 square inch lens opening.
- Door jamb finished black on four sides for positive light stop.
- True mitered corner steel lens frame.
- Spring loaded rooster head latches.
- 18 gauge steel hinges.
- Flat and regressed aluminum doors available.

Specifications

- **Performance:** In an installation of 3 lamp 31W 1-5/8" U lamp luminaires in a room cavity ratio of 1, with reflectance 80% ceiling, 50% wall, 20% floor, the C.U. shall not be less than .72. To prevent glare the VCP shall not be less than 35 either lengthwise or crosswise (at 100fc level) and the average brightness at 65° shall not exceed 3497 candelas per square meter. To control veiling reflections, luminaire output in the 30°-90° zone shall not be less than 66.8%.
In an installation of 2 lamp 31W 6" U lamp luminaires in a room cavity ratio of 1, with reflectance 80% ceiling, 50% wall, 20% floor, the C.U. shall not be less than .75. To prevent glare the VCP shall not be less than 40 either lengthwise or crosswise (at 100fc level) and the average brightness at 65° shall not exceed 2629 candelas per square meter. To control veiling reflections, luminaire output in the 30°-90° zone shall not be less than 67.4%.
- **Materials:** Chassis parts – die-formed code gauge cold rolled steel. Housing with side rails hemmed over and housing ends turned-in for safe handling.
- **Finish:** Chassis exterior – White baked polyester enamel. Cavity – white baked polyester enamel minimum 86% reflectance. Phosphate undercoating.
- **Electrical:** Thermally protected class "P" ballast, non PCB. If K.O. is within 3" of ballast, use wire suitable for at least 90°.
- **Labels:** cULus listed. Suitable for damp locations. Models with emergency ballasts suitable for dry locations.

Dimensions

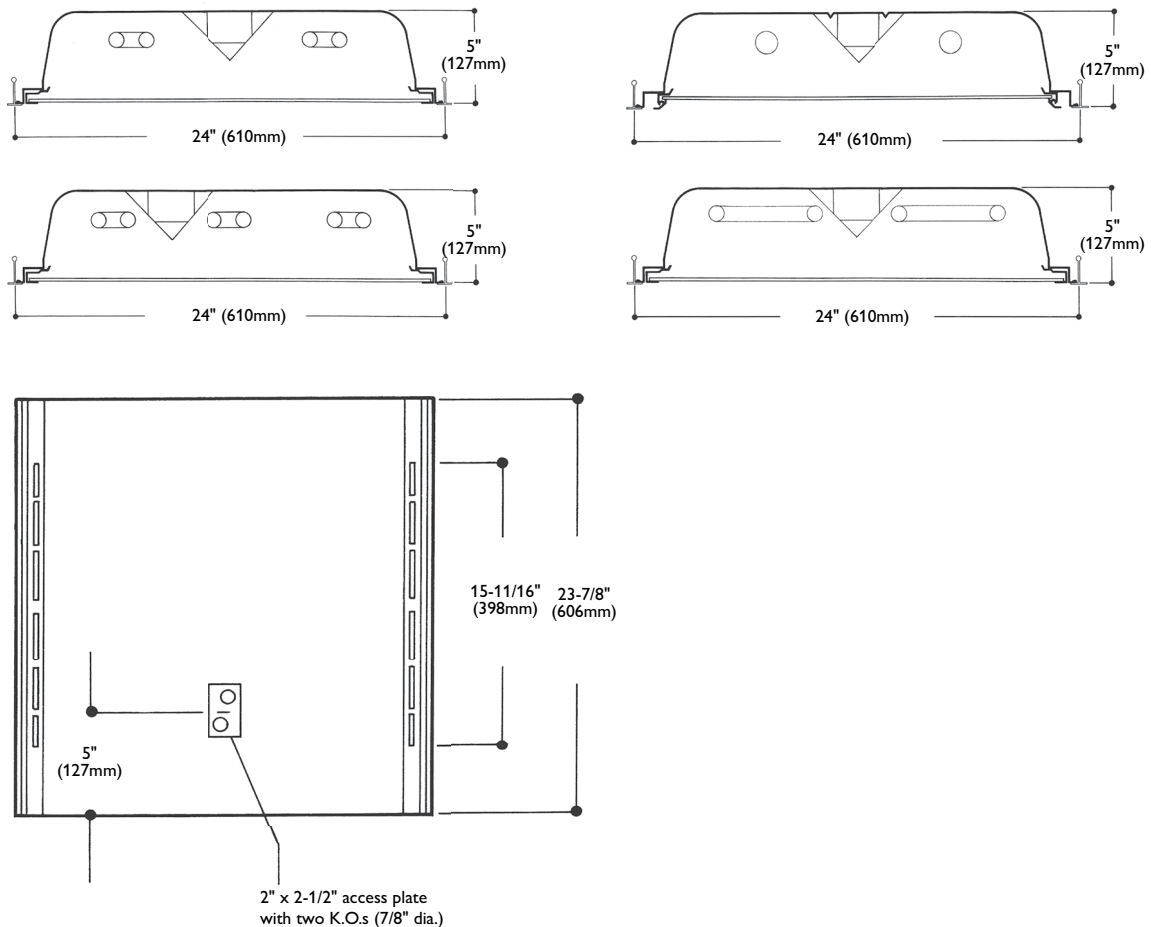

SPS SpecPlus 2x2

T8, T5, or T5HO

Features

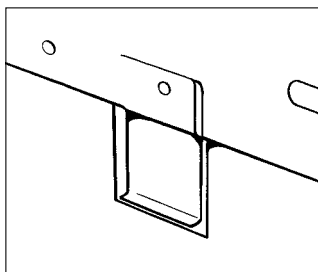

earthquake clip before installation

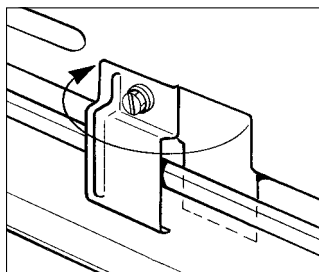

earthquake clip installed (lay-in grid)

Mounting methods

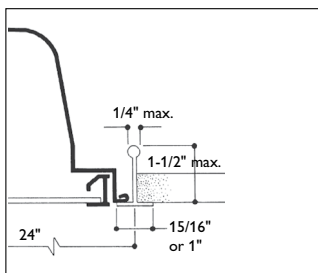

exposed t-grid ceiling (with flat aluminum frame)

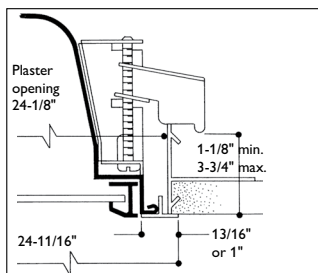

plaster ceiling/flanged (with regressed aluminum frame)

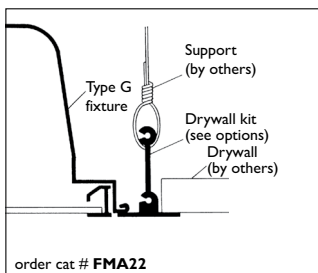

drywall kit (see options)

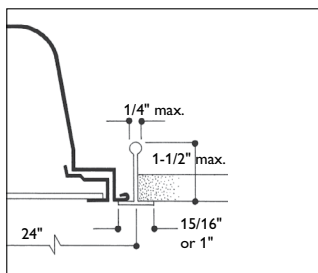

exposed T-grid ceiling (with flat steel frame)



Some luminaires use fluorescent or high intensity discharge (HID) lamps that contain small amounts of mercury. Such lamps are labeled, "Contain Mercury" and/or the symbol "HG". Lamps that contain mercury must be disposed of in accordance with local requirements. Information regarding lamp recycling and disposal can be found at www.lamprecycle.org

SPS SpecPlus 2x2

T8, T5, or T5HO

Photometry

Model No. SPS2GFSVA32U120-1/3-EB

LER = 64.1 IW - 76.2 BF - 0.88
Comparative yearly lighting energy cost per 1000 lumens = \$3.74

Report Number: G00057
Catalog Number: SPS2GFSVA32U120-1/3-EB
Lamps: (3) U6T8
Luminaire: 2' x 2' SpecPlus with regressed aluminum door frame and extruded virgin acrylic shielding .095" nominal thickness (similar to pattern 12).
Ballast: REL-3P32-SC
Report is based on 2725 Lumens per lamp.
Efficiency: 67.9%
CIE Type: Direct
Plane: 0-Deg 90-Deg
Spacing Criteria: 1.2 1.3
Shielding Angles: 90 90
Plane: 0-Deg 90-Deg
Luminous Length: 21.875 21.875

COEFFICIENTS OF UTILIZATION - ZONAL CAVITY METHOD. EFFECTIVE FLOOR CAVITY REFLECTANCE 0.20

RC	80	50	30	10	50	30	10
1	75	72	69	67	65	63	62
2	69	63	59	60	57	54	53
3	63	56	51	53	49	46	45
4	58	51	45	48	44	40	39
5	54	46	40	43	39	35	35
6	50	41	36	39	35	31	31
7	46	38	32	36	31	28	28
8	43	34	29	33	28	25	25
9	40	32	26	31	26	23	23
10	38	29	24	28	24	21	21

CANDELA DISTRIBUTION

	0.0	45.0	90.0	FLUX
0	2391	2391	2391	
5	2376	2376	2382	226
15	2269	2289	2315	647
25	2056	2106	2160	971
35	1728	1799	1877	1126
45	1277	1361	1467	1051
55	786	840	909	755
65	434	411	460	434
75	219	201	264	244
85	82	87	109	98
90	0	0	0	

LUMINANCE DATA IN CANDELA/SQ. METER

AVERAGE IN DEG.	AVERAGE 0-DEG.	AVERAGE 45-DEG.	AVERAGE 90-DEG.
45	5803.	6184.	6666.
55	4403.	4705.	5092.
65	3300.	3125.	3497.
75	2719.	2495.	3277.
85	3023.	3207.	4018.

ZONAL LUMEN SUMMARY

ZONE	LUMENS	% LAMP	% FIXT
0- 30	1844	22.6	33.2
0- 40	2970	36.3	53.5
0- 60	4776	58.4	86.0
0- 90	5552	67.9	100.0

Model No. SPS2GFSVA26U120-1/2-EB

LER = 60.9 IW - 56.3 BF - 0.87
Comparative yearly lighting energy cost per 1000 lumens = \$3.94

Report Number: G00035
Catalog Number: SPS2GFSVA26U120-1/2-EB
Lamps: (2) U6T8
Luminaire: 2' x 2' SpecPlus with regressed aluminum door frame and extruded virgin acrylic shielding .095" nominal thickness (similar to pattern 12).
Ballast: REL-2P32-SC
Report is based on 2750 Lumens per lamp.
Efficiency: 71.5%
CIE Type: Direct
Plane: 0-Deg 90-Deg
Spacing Criteria: 1.2 1.3
Shielding Angles: 90 90
Plane: 0-Deg 90-Deg
Luminous Length: 21.875 21.875

COEFFICIENTS OF UTILIZATION - ZONAL CAVITY METHOD. EFFECTIVE FLOOR CAVITY REFLECTANCE 0.20

RC	80	50	30	10	50	30	10
1	79	75	73	71	69	67	66
2	72	67	62	63	59	56	55
3	66	59	54	56	52	48	47
4	61	53	47	50	46	42	41
5	56	48	42	45	40	37	36
6	52	43	37	41	36	32	32
7	49	39	33	38	33	29	29
8	45	36	30	35	30	26	26
9	42	33	28	32	27	24	23
10	40	31	25	30	25	21	21

CANDELA DISTRIBUTION

	0.0	45.0	90.0	FLUX
0	1669	1669	1669	
5	1659	1658	1661	158
15	1578	1593	1614	451
25	1431	1464	1502	675
35	1212	1249	1309	785
45	913	960	1068	750
55	572	611	673	551
65	318	302	342	319
75	160	146	192	178
85	58	62	78	70
90	0	0	0	

LUMINANCE DATA IN CANDELA/SQ. METER

AVERAGE IN DEG.	AVERAGE 0-DEG.	AVERAGE 45-DEG.	AVERAGE 90-DEG.
45	4164.	4410.	4906.
55	3239.	3460.	3811.
65	2444.	2321.	2629.
75	2008.	1832.	2410.
85	2162.	2311.	2907.

ZONAL LUMEN SUMMARY

ZONE	LUMENS	% LAMP	% FIXT
0- 30	1283	23.3	32.6
0- 40	2069	37.6	52.6
0- 60	3369	61.3	85.6
0- 90	3936	71.6	100.0

