

PHILIPS Day-Brite CFI

Recessed

SpecPlus 2x2

TT5

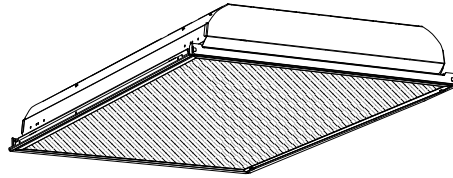

Project: _____
 Location: _____
 Cat.No: _____
 Type: _____
 Lamps: _____ Qty: _____
 Notes: _____

The Philips Day-Brite / CFI SpecPlus recessed offers specification grade quality and features. Built-in grid clips with positive clamping by screws, easy re-lamping, and 475 sq. inch lens area puts this luminaire in the lead on performance, safety and ease of maintenance.

Ordering guide

example: SPS2GFSVA3FTUNV-1/3-EB

Family	Air Function	Width	Ceiling Type	Lens Frame	Lens Shielding	Lamp Quantity	Lamp Type	Voltage	Options
<input type="text" value="SP"/>	<input type="text" value="S"/>	<input type="text" value="2"/>	<input type="text"/>	<input type="text"/>	<input type="text"/>	<input type="text"/>	<input type="text" value="FT"/>	<input type="text"/>	<input type="text"/>
SP SpecPlus Lensed Troffer	S Static	2 2'	G Grid (lay-in T bar) F Flanged (over lap) Z spline and plaster frame	FS Flat steel RA Regressed aluminum FA Flat aluminum	VA Pattern 12 prismatic acrylic, .095" nominal VI Pattern 12, .125" nominal VY K-12, .125" nominal KA Pattern 19, .156" nominal BP 1/2"x1/2"x1/2" silver plastic louver, polystyrene AP 1/2"x1/2"x1/2" silver plastic louver, acrylic MC 1.5"x1.5"x1" silver plastic louver, polystyrene ML 1.5"x1.5"x1" silver plastic louver, acrylic SE 3/4"x3/4"x3/8" silver plastic louver, polystyrene SF 3/4"x3/4"x3/8" silver plastic louver, acrylic	2 2 lamp 3 3 lamp	FT 40WTT5	UNV Universal voltage, 120-277V 120 120V 277 277V 347 347V	1/2 One 2-lamp ballast 1/3 One 3-lamp ballast 1/21 2-lamp & 1-lamp ballasts EB Electronic ballast, < 10% THD std. ballast factor EB101 CF40 electronic ballast, instant start, <10% THD EBD7 Advance Mark 7 dimming ballast, 0-10V (low voltage) control EBDX Advance Mark 10 dimming ballast, phase control EBD Electronic dimming ballast, customer specified E5 B50 emerg. ballast, U.S. or Canada market, 1100-1400 lumens, UNV F1 3/8" flex, 3 wire 18 gauge 6' F2 3/8" flex, 4 wire 18 gauge 6' F2/5W 3/8" flex, 5 wire 18 gauge 6' GLR Fusing, fast blow LPT830 Installed lamps, 80+ CRI, 3000K LPT835 Installed lamps, 80+ CRI, 3500K LPT841 Installed lamps, 80+ CRI, 4100K 1W 1-way gasketing, between lens & door frame 2W 2-way gasketing, 1W + gasketing between door frame & housing 3W 3-way gasketing, 2W + gasketing for field installation between housing & ceiling PAF Housing painted after fabrication

Accessories (order separately)

- **FMA22** – 2'x2' "F" mounting frame for NEMA "F" installations
- **Electrical wiring options** – consult factory

SPS SpecPlus 2x2

TT5

Features

- 5" deep body.
- 3-1/4" lamp to lens for better lamp obscuration.
- 76.8% efficient (3 lamp TT5).
- Clean contoured interior, no holes.
- Hemmed over side rails for maximum safety.
- Fixture ends turned-in for safe handling.
- Built-in earthquake clips.
- Slimline door frame with 475 square inch lens opening.
- Door jamb finished black on four sides for positive light stop.
- True mitered corner steel lens frame.
- Spring loaded rooster head latches.
- 18 gauge steel hinges.
- Flat and regressed aluminum doors available.

Specifications

- **Performance:** In an installation of 3 lamp 40WTT5 luminaires in a room cavity ratio of 1, with reflectance 80% ceiling, 50% wall, 20% floor, the C.U. shall not be less than .81. To prevent glare the VCP shall not be less than 35 either lengthwise or crosswise (at 100fc level) and the average brightness at 65° shall not exceed 4447 candelas per square meter. To control veiling reflections, luminaire output in the 30°-90° zone shall not be less than 66.5%.
- **Materials:** Chassis parts – die-formed code gauge cold rolled steel. Housing with side rails hemmed over and housing ends turned-in for safe handling.
- **Finish:** Chassis exterior – White baked polyester enamel. Cavity – white baked polyester enamel minimum 86% reflectance. Phosphate undercoating.
- **Electrical:** Thermally protected class "P" ballast, non PCB. If K.O. is within 3" of ballast, use wire suitable for at least 90°.
- **Labels:** cULus listed. Suitable for damp locations. Models with emergency ballasts suitable for dry locations.

Dimensions

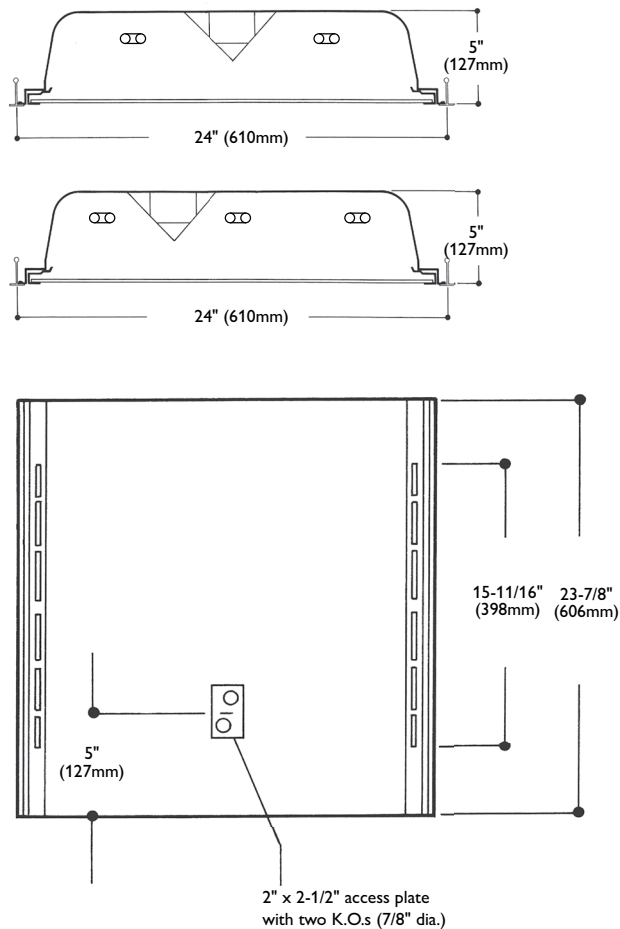

SPS SpecPlus 2x2

TT5

Features

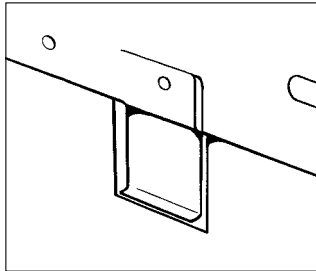

earthquake clip before installation

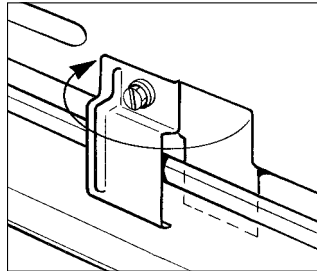

earthquake clip installed (lay-in grid)

Mounting methods

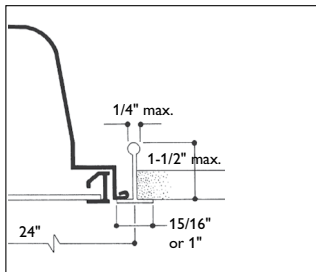

exposed t-grid ceiling (with flat aluminum frame)

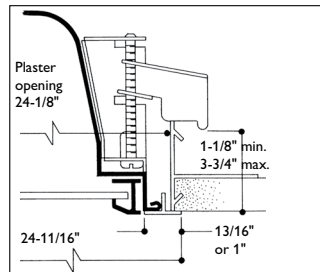

plaster ceiling/flanged (with regressed aluminum frame)

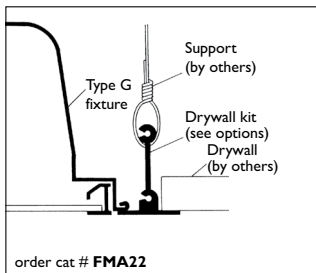

order cat # **FMA22**

drywall kit (see options)

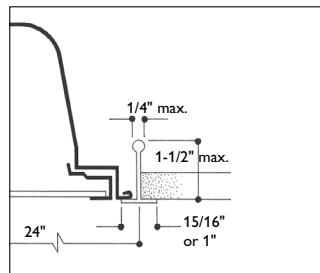

exposed T-grid ceiling (with flat steel frame)



Some luminaires use fluorescent or high intensity discharge (HID) lamps that contain small amounts of mercury. Such lamps are labeled, "Contain Mercury" and/or the symbol "HG". Lamps that contain mercury must be disposed of in accordance with local requirements. Information regarding lamp recycling and disposal can be found at www.lamprecycle.org

SPS SpecPlus 2x2

TT5

Photometry

Model No. SPS2GFSVA3FT120-1/3-EB10I

LER = 64.5 IW - 97.9 BF - 0.87
 Comparative yearly lighting energy cost per
 1000 lumens = \$3.72

Report Number: G00045

Catalog Number: SPS2GFSVA3FT120-1/3-EB10I

Lamps: (3) F40

Luminaire: 2' x 2' SpecPlus with regressed aluminum
 door frame and extruded virgin acrylic shielding .095"
 nominal thickness (similar to pattern 12).

Ballast: C340I120

Report is based on 3150 Lumens per lamp.

Efficiency: 76.8%

CIE Type: Direct

Plane: 0-Deg 90-Deg

Spacing Criteria: 1.2 1.3

Shielding Angles: 90 90

Plane: 0-Deg 90-Deg

Luminous Length: 21.875 21.875

COEFFICIENTS OF UTILIZATION -
 ZONAL CAVITY METHOD. EFFECTIVE
 FLOOR CAVITY REFLECTANCE 0.20

RC	80	50	30	10	50	30	10
RW	70	50	30	10	50	30	10
1	84	81	78	76	74	72	71
2	78	72	67	68	64	61	65
3	71	64	58	61	56	52	58
4	66	57	51	54	49	45	53
5	61	52	45	49	44	40	48
6	56	47	40	45	39	35	44
7	53	43	36	41	36	32	40
8	49	39	33	38	32	28	37
9	46	36	30	35	29	26	34
10	43	33	28	32	27	24	32

CANDELA DISTRIBUTION

	0.0	45.0	90.0	FLUX
0	3132	3132	3132	
5	3115	3117	3135	297
15	2973	3016	3061	852
25	2697	2795	2882	1286
35	2265	2385	2465	1485
45	1677	1773	1880	1367
55	1027	1081	1151	971
65	565	528	585	557
75	285	261	341	316
85	106	113	143	128
90	0	0	0	

LUMINANCE DATA IN CANDELA/SQ. METER

AVERAGE IN DEG.	AVERAGE 0-DEG.	AVERAGE 45-DEG.	AVERAGE 90-DEG.
45	7620.	8056.	8542.
55	5753.	6055.	6448.
65	4295.	4014.	4448.
75	3538.	3240.	4233.
85	3908.	4166.	5272.

ZONAL LUMEN SUMMARY

ZONE	LUMENS	% LAMP	% FIXT
0- 30	2435	25.8	33.5
0- 40	3920	41.5	54.0
0- 60	6258	66.2	86.2
0- 90	7260	76.8	100.0

© 2015 Koninklijke Philips N.V. All rights reserved.
 Philips reserves the right to make changes in specifications
 and/or to discontinue any product at any time without notice
 or obligation and will not be liable for any consequences
 resulting from the use of this publication.
philips.com/luminaires



Philips Lighting, North America Corporation
 200 Franklin Square Drive, Somerset, NJ 08873
 Tel. 855-486-2216

Philips Lighting Canada Ltd.
 281 Hillmount Rd, Markham, ON, Canada L6C 2S3
 Tel. 800-668-9008