

Project name		Type	
Date		Prepared by	

RVM						
Luminaire	Lamp	Optical System	Voltage	Options	Accessory	Finish

RoadView LED Series

RVM

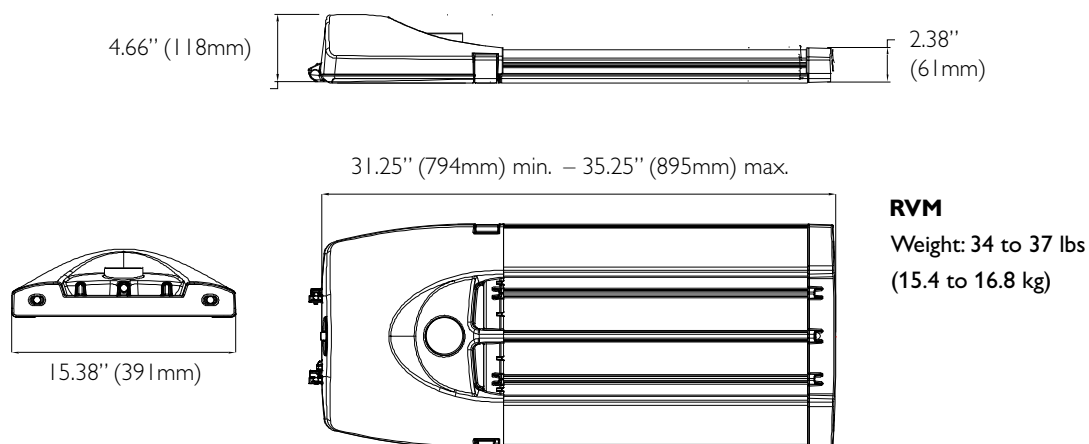

Lamps

LUMINAIRE PERFORMANCE DATA (Nominal 4000K CCT)											
Lamp	Drive		Luminaire Lumens*	System Watts	Max. system current (amps)	Weight		Length		EPA	
	LEDs	Current				lb.	kg.	in.	mm.	sq. ft.	sq. m.
110W96LED4K	96	350	10516	105	0.88	34	15.4	31.25	794	0.71	0.066
160W96LED4K	96	530	15196	160	1.33	34	15.4	31.25	794	0.71	0.066
215W96LED4K	96	700	18646	208	1.73	34	15.4	31.25	794	0.71	0.066
125W112LED4K	112	350	12589	120	1.00	34	15.4	31.25	794	0.71	0.066
190W112LED4K	112	530	18193	183	1.53	34	15.4	31.25	794	0.71	0.066
145W128LED4K	128	350	14150	137	1.14	34	15.4	31.25	794	0.71	0.066
215W128LED4K	128	530	20448	209	1.74	34	15.4	31.25	794	0.71	0.066
160W144LED4K	144	350	15559	154	1.28	37	16.8	35.25	895	0.78	0.072
245W144LED4K	144	530	22484	235	1.96	37	16.8	35.25	895	0.78	0.072
180W160LED4K	160	350	16370	170	1.42	37	16.8	35.25	895	0.78	0.072
270W160LED4K	160	530	23657	260	2.17	37	16.8	35.25	895	0.78	0.072

*For Type III distribution. See photometric files for other distributions.



PHILIPS
LUMEC

Optical systems / LED

LE2	TYPE II / Asymmetrical distribution
LE3	TYPE III / Asymmetrical distribution
LE4	TYPE IV / Asymmetrical distribution
LE5	TYPE V / Symmetrical distribution

Voltage

UNIV (120-277)	347	480
----------------	-----	-----

Driver options**

AST	Driver pre-programmed with progressive lamp starting*
CDMG	Dynadimmer standard dimming program*
CDMGP	Dynadimmer custom dimming program*
CLO	Constant Light Output, driver pre-programmed to achieve the same light intensity for the duration of the lifespan of the lamp*
DALI	Driver compatible with DALI control systems*
DMG	Dimmable driver 0-10 volt
OTL	Over The Life, driver pre-programmed to signal the end of lamp life*
OVR	Dynadimmer override function for use with motion detector or other switching device

*Only available with 120 - 277 volts.

** For all programmable options please consult the factory for details

Luminaire options

API	ANSI/NEMA wattage label
BL	Bubble level
OSL3W	Motion detector (requires DMG or CDMG)
PH8	Photoelectric cell, twistlock type includes receptacle
RC	Receptacle for a twist-lock photocell or shorting cap
SR	Strain relief

Luminaire accessory

SPC*	StarSense Photo-cell Control
-------------	------------------------------

* Luminaire option RC is required with this accessory

Finish options

GY3	Gray	BR	Bronze
WH	White	BK	Black

EXP	Extrusion painted to match cast housing color selected above (standard extrusion color is anodized aluminum).
------------	---

Additional colors are available. Consult factory for complete specifications.

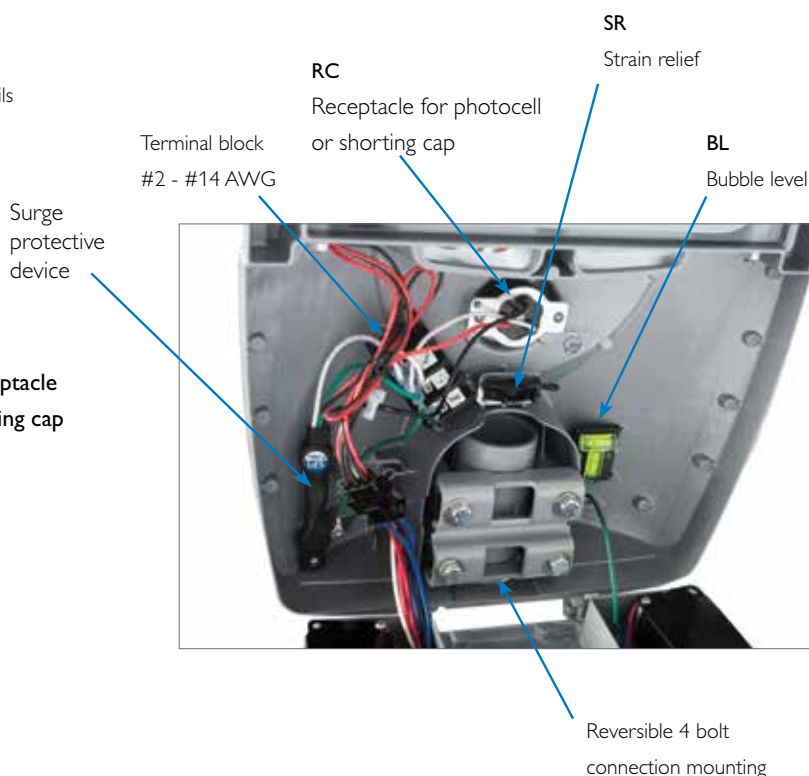

Specifications subject to change without notice.

Consult factory for full details.



LEDGINE

PHILIPS
LUMEC

Lamp

Composed of high performance white LEDs. ANSI Nominal CCT of 4000K, minimum 70 CRI. Ambient operating temperature range -40C (-40F) to +40C (104F). L70 lumen maintenance projected to be greater than 100,000 hours.

Optical system

Composed of high performance lenses, protected by a flat tempered glass lens. System is rated IP66. Photometric performance is tested according to IES LM-79.

Surge protector

Surge protective device provides all phases protection for line-ground, line-neutral, and neutral-ground in accordance with IEEE / ANSI C62.41.2 C High. Surge rating 10 kV, 10 kA and DOE Model Specification for Roadway Luminaires Elevated requirements per Appendix D. Surge protection is standard for all product models 120-480v.

Driver

Electronic driver, operating range 50-60 Hz. Auto-adjusting to input voltage between 120-277 volt AC, or 347-480 volt AC. Minimum power factor 0.90, max THD 20%. UL recognized component. 100,000 hours expected life. Optional dimming (0-10v) and digital driver features available.

Housing

The upper and lower parts of the housing are made of die cast A360 aluminum alloy. The 4-bolt mounting system includes a reversible bracket made of zinc plated steel. Fits on a 1.66" to 2.375" OD by 5" long tenon, fixed by 3/8-16 UNC steel zinc plated bolts. An integral part of the housing permits an adjustment of +/- 5° by steps of 2.5°.

Power door

The housing is complete with a tool-less removable power door including quick disconnects for ease of service. A tool free latch assembly on the power door allows for easy access to the electrical compartment.

Heat sink

The extruded heat sink is made of A6063 aluminum alloy, and is shaped to draw heat away from the LEDs. Product does not use any cooling device with moving parts (has passive cooling device).

LED platform

The LEDGINE LED platform consist of two LED boards with 48, 64, or 80 LUXEON Rebel LEDs each, as required to provide total LEDs from 96 - 160. The LED boards are removable and replaceable.

Wiring

Luminaire wiring is done using a terminal block located inside the housing. Terminal block accepts three wires (#2-14 AWG).

Hardware and seals

All hardware shall be stainless steel or corrosion resistant. All seals and sealing devices are lined with silicone.

Finish

Application of a polyester powder coat paint. (4 mils/100 microns). The chemical composition provides a highly durable UV and salt spray resistant finish in accordance with the ASTM-B117 standard and humidity proof in accordance with the ASTM-D2247 standard. The specially formulated Lumital powder coat finish is available in standard gray. Additional colors are available. Consult factory for complete specifications.

Vibration resistance

Meets the ANSI C136.31-2001 table 2, American National Standard for Roadway Luminaire Vibration specifications for Bridge/overpass applications (3G).

Certifications and Compliance

CSA, UL or cUL. ISO 9001-2008. All electrical components are RoHS compliant. Listed on Design Lights Consortium (DLC) Qualified Products List (QPL).

