

OM475PAR16SQ

4" Square Incandescent Downlights

CAT. NO:

TYPE:

PROJECT:

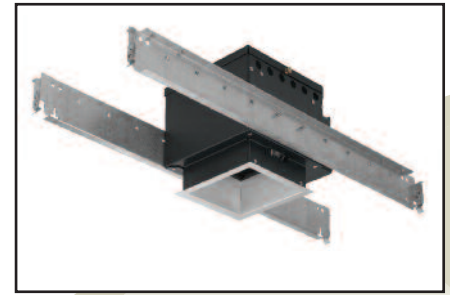

PRODUCT INFORMATION

Applications

Small square reflector downlight for use with economical incandescent lamps. Provides broad, uniform light distribution for areas such as lobbies, reception areas, restaurants and offices.

Specifications

- Housing** - Precision formed heavy duty 20 gauge steel with polyester powder coat matte black to suppress light leaks. Housing top may be removed for servicing unit from above. Upper optic is attached to housing lid for easy access to lamp. Housing throat is 1-1/2" in depth to accommodate extra thick ceilings. Junction box and all electrical components may be accessed below or above ceiling.
- Installation** - Housing has pre-installed Revelation C-channels for vertical and/or horizontal adjustment. Channels are pre-set at factory to center in grid ceiling without adjustments. Preset channels ensure proper alignment when row mounting multiple downlights. For wood construction specify Q1031(ordered separately). Flat bar hanger should install perpendicular to pre-installed bar hangers.
- Optics** - The trim is die-formed of .040 low iridescent aluminum and is self-flanged with a variety of finishes available. Black coating on back of trim provides superior protection against flash and/or light leaks around the flange. White flange is standard. Optional polished flange matching trim finish is available, add FF to catalog number.
- Socket** - Medium base 250V porcelain socket with nickel plated screw shell and 200°C wire positions lamp at optical focal plane of reflector for maximum performance.
- Junction box** - Large 20 gauge galvanized steel with snap-on covers. Approved for through wiring with up to 8 #12 AWG conductors.
- Thermal Protection** - A thermal protection device which meets all U.L. and NEC requirements is standard.
- U.L. Listed** - For use in damp locations only and approved for Through Branch Circuit Wiring. I.B.E.W. union made.

Canadian Specifications may vary from these shown, consult Canadian Division.

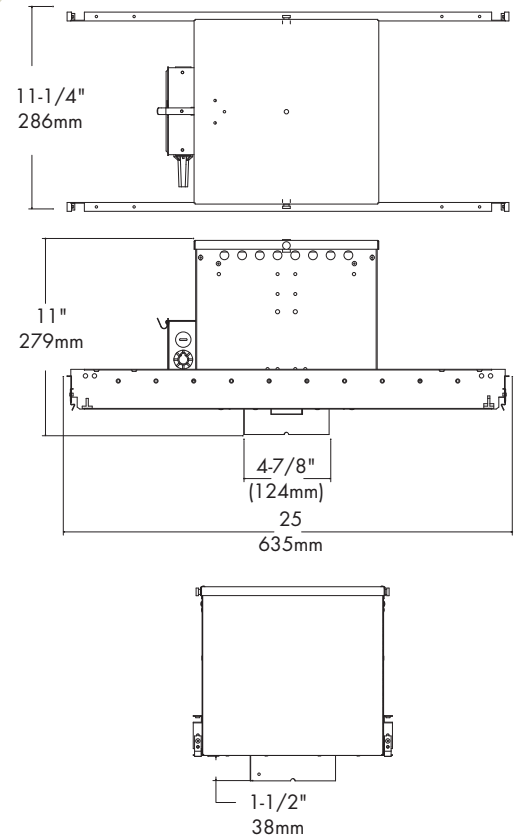

4

CATALOG SYSTEM AND OPTIONS

EXAMPLE OF COMPLETE CATALOG NUMBER: OM475PAR16SQ-CS

OMEGA Aptr.	Lamp (by others)	Square Type	Reflector Finish	Optional Lens
OM4	50 PAR20 75 PAR16	SQ Square	-	
<div>  <p>made with pride in the United States of America</p> </div> <div> <p>FIVE YEAR Warranty</p> </div>				
			CS Clear Specular CSS Clear Semi-Specular GS Gold Specular WT Wheat PW Pewter BK Black BZ Bronze WH White CB Corrugated Baffle FF Finish Flange (as suffix to color)	CL Clear Glass PL Prismatic (C73 Glass) SL Solite Glass

OMEGA LIGHTING: 776 South Green St., Tupelo, MS 38804 Phone 662.842.7212 FAX 662.841.5501

Omega Lighting is a Philips group brand

PHILIPS

OM450PAR20SQ-CS**Clear Specular Reflector**

Report number: 27428

Lamp: (1)50W INC

Fixture Efficiency: 85.0%

S/MH Ratio (0 degree plane): 0.4
(90 degree plane): 0.6

Total Fixture Lumens: 468

IES file: F27428.IES

Beam Angle: 26.79

LIGHTING PERFORMANCE DATA		
CEILING HEIGHT* (FT.)	INITIAL FOOTCANDLES	BEAM DIAMETER (FT.-IN.)
8	52.4	2 - 7
10	28.2	3 - 7
12	17.6	4 - 6
14	12.0	5 - 6
16	8.7	6 - 5

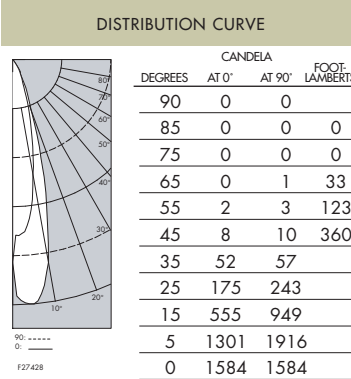
**COEFFICIENTS OF UTILIZATION ZONAL CAVITY METHOD**

Effective Floor Cavity Reflectance 0.20								
RC	80		70		50			
	50	30	50	30	50	30		
0	101	101	101	101	98	98		
1	96	94	93	92	94	93		
2	93	90	88	84	92	89		
3	90	85	81	80	89	84		
4	86	81	78	75	85	81		
5	83	78	73	70	82	77		
6	81	75	70	68	80	73		
7	78	71	68	65	77	70		
8	75	68	65	61	75	68		
9	72	67	63	59	71	66		
10	70	64	59	57	69	64		

OM475PAR16SQ-120**Clear Specular Reflector**

Report number: 27427

Lamp: (1)75W INC

Fixture Efficiency: 95.1%

S/MH Ratio (0 degree plane): 0.6
(90 degree plane): 0.6

Total Fixture Lumens: 856

IES file: F27427.IES

Beam Angle: 35.63

LIGHTING PERFORMANCE DATA		
CEILING HEIGHT* (FT.)	INITIAL FOOTCANDLES	BEAM DIAMETER (FT.-IN.)
8	58.0	3 - 6
10	31.2	4 - 10
12	19.5	6 - 1
14	13.3	7 - 5
16	9.6	8 - 8

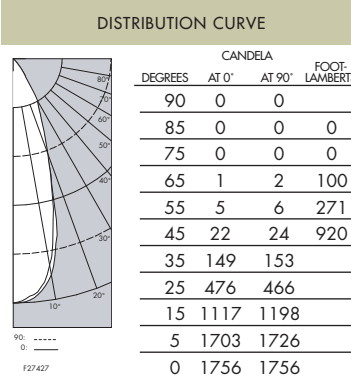
**COEFFICIENTS OF UTILIZATION ZONAL CAVITY METHOD**

Effective Floor Cavity Reflectance 0.20								
RC	80		70		50			
	50	30	50	30	50	30		
0	112	112	112	112	111	111		
1	109	106	104	102	106	104		
2	104	100	95	93	102	97		
3	98	93	90	85	97	93		
4	94	89	83	80	93	88		
5	91	83	79	75	90	82		
6	86	80	75	70	85	79		
7	83	76	70	67	81	75		
8	80	71	67	64	79	71		
9	77	68	64	60	76	68		
10	73	66	60	57	72	66		

*Readings at working plane, 2'6" above floor. Beam Angle and Diameter Cutoff at 50% of max.
Candlepower Coefficients used at effective reflectances of: 70% Ceiling, 50% Walls, 20% Floor

To convert values for optional reflector colors, multiply by:
Gold .90 Bronze .82 Pewter .87

Additional photometric test files are available @ omegalighting.com

OMEGA
LIGHTING

OMEGA LIGHTING:
776 South Green St., Tupelo, MS 38804
Phone 662.842.7212 FAX 662.841.5501

CANADIAN DIVISION:
189 Bullock Drive, Markham, Ontario, Canada L3P 1W4
Phone 905.294.9570 FAX 800.268.0003