

# OM439CMHMR16RADJ45

## 4" CMH MRI6 45° Adjustable Downlight

CAT. NO:

TYPE:

PROJECT:

### PRODUCT INFORMATION

#### Applications

Recessed 45° adjustable downlight well suited for general or accent lighting in sloped ceiling applications, auditoriums, schools, restaurants, hotels, and offices. Full horizontal rotation makes this fixture ideal for highlighting store displays, sculptures, or vertical surfaces. Low brightness reflector matches all other 4" aperture downlights from Omega.

#### Specifications

1. **Housing** - Heavy 20 gauge formed steel housing features a matte black finish to suppress stray light.

2. **Installation** - Mounting pan has pre-installed universal mounting brackets with vertical adjustment. Junction box and mounting brackets are accessible from below ceiling. Housing is accessible from above ceiling through removable top cover. For 24" C-channel hangers (pair), specify Q1032 accessory, ordered separately. For 27" flat bar hangers (pair), specify Q1031 accessory, ordered separately. For adjustable bar hangers, (pair) specify Q1033 accessory, ordered separately.

3. **Ballast** - Totally enclosed, High Power factor; with <10% THD electronic ballast with integral ignitor; thermally protected. Ballast requires a minimum starting temperature of -30° C. Ballast is either 120 volt 60 Hz or 277 volt 60 Hz with a sound rating of "A" for indoor applications.

4. **Socket** - Twist lock GX10.

5. **Junction Box** - Extra large 32-cubic inch 16 gauge galvanized steel designed to meet U.L./NEC requirements. Approved for through branch wiring with up to 6 #12 AWG connectors.

6. **Hot Aim** - Feature that facilitates obstruction-free aiming with a screwdriver.

7. **Aim Locks** - Rotation and tilt adjustments are lockable via thumbscrews, providing tool-less locking. Mechanical locks also prevent misalignment during relamping.

8. **Trim** - Keyed trim assembly with torsion spring ensures proper installation and allows trim to hang hands-free during aiming or relamping. The aperture features a slot opening to limit visibility into the housing. Alzak finish and self-flanged features are standard.

9. **Tilt Mechanism** - Die-cast assembly features indexing for consistent aiming. Shroud extension covers aperture to block view of the inside of the housing.

10. **Lamp Retention System** - Patented lamp retention spring holds the lamp and media captive and simplifies relamping.

11. **Relamping** - Fixture is suitable for top and bottom relamping. Additional relamp label provided for commissioning.

12. **Heat Sink** - Die-cast aluminum lamp and media cartridge dissipates heat to lower operating temperatures and lengthen lamp life.

13. **U.L. Listed** - For use in IC or Non-IC damp locations and approved for Through Branch Circuit Wiring. I.B.E.W. union made.

\* Canadian Specifications may vary from these shown, consult Canadian Division.

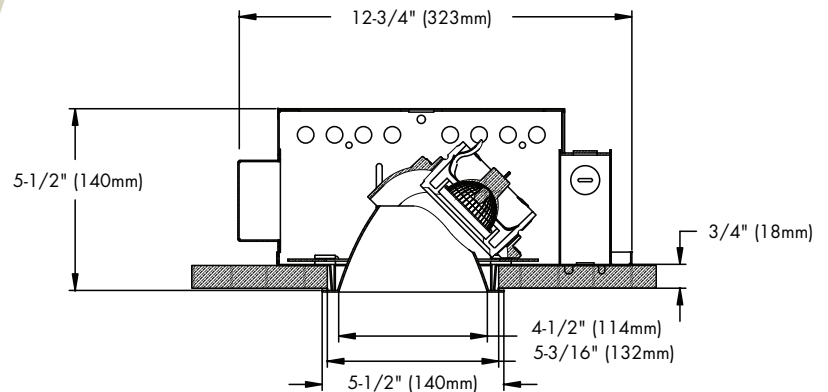
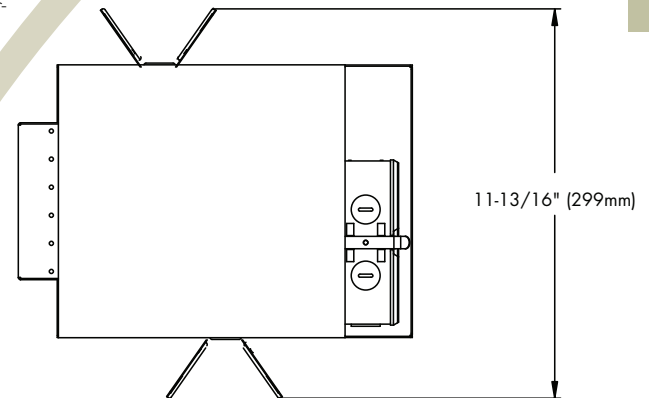

C-Channel not included.

### CATALOG SYSTEM AND OPTIONS

EXAMPLE OF COMPLETE CATALOG NUMBER: OM420CMHMR16RADJ45-CS-ET120

OMEGA Revelation	Max Wattage/ Lamp	Housing Construction	Trim Finish	Flange Option	Supply Voltage	Bar Hanger Accessories	Lens Accessories
OM4	20CMHMR16 39CMHMR16	RADJ45 Recessed Adjustable 45°	SLOT Slot CS Clear Specular CSS Clear Semi-Specular HZ Haze GS Gold Specular WT Wheat PW Pewter BZ Bronze BK Black Alzak WH White WB White Baffle BB Black Baffle	Blank White FF Finish Flange (matches trim)	ET120 Electronic 120vac ET277 Electronic 277vac	Q1031 Flat Bar Hanger Q1032 Channel Bar Hanger Q1033 Adjustable Bar Hanger	OMMR16AF Amber Filter OMMR16BF Blue Filter OMMR16RF Red Filter OMMR16GF Green Filter OMMR16YF Yellow Filter OMMR16LS Linear Spread OMMR16UV Optivex UV Filter OMMR16FL Frosted Lens OMMR16SO Solite Lens OMMR16LR Louver OMMR16PL Prismatic Lens



FIVE YEAR  
Warranty

**OM420CMHMR16RADJ45CSET120****Clear Specular Reflector**

Report Number: 27151

Lamp: (1) 20MHMR16

Total Lumens: 1000

Fixture Efficiency: = 78.4%

IES File: F27151.IES

S/MH Ratio = 2.3, 1.2

Beam Angle: 80.54

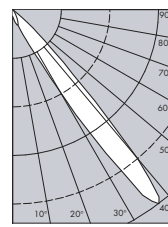
**DISTRIBUTION CURVE**90: -----  
0: -----  
F27151

DEGREES	CANDELA		FOOT-LAMBERTS
	AT 0°	AT 90°	
90	0	5	
85	0	5	1033
75	0	5	348
65	0	3	128
55	25	5	926
45	801	22	20950
35	3437	102	
25	695	336	
15	408	455	
5	260	262	
0	202	20290	

**COEFFICIENTS OF UTILIZATION  
ZONAL CAVITY METHOD**

Effective Floor Cavity Reflectance 0.20

RC	80		70		50	
	50	30	50	30	50	30
0	93	93	93	93	91	91
1	88	85	82	81	85	83
2	82	78	75	70	81	77
3	78	71	67	63	76	69
4	72	66	59	56	70	65
5	68	59	55	51	66	58
6	63	55	48	45	61	54
7	58	51	45	40	57	50
8	56	46	40	36	54	46
9	52	42	38	34	51	42
10	48	40	34	30	47	39

**4****OM420CMHMR16RADJ45CSET120****Clear Specular Reflector**

Report Number: 27149

Lamp: (1) 20MHMR16

Total Lumens: 1000

Fixture Efficiency: = 74.2%

IES File: F27149.IES

S/MH Ratio = 2.0, 0.9

Beam Angle: 71.46

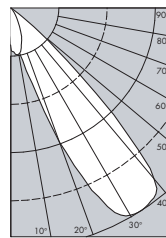
**DISTRIBUTION CURVE**90: -----  
0: -----  
F27149

DEGREES	CANDELA		FOOT-LAMBERTS
	AT 0°	AT 90°	
90	0	3	
85	0	3	620
75	0	4	278
65	1	3	149
55	35	3	1193
45	637	23	16788
35	1271	79	
25	1218	228	
15	537	432	
5	418	474	
0	388	388	

**COEFFICIENTS OF UTILIZATION  
ZONAL CAVITY METHOD**

Effective Floor Cavity Reflectance 0.20

RC	80		70		50	
	50	30	50	30	50	30
0	88	88	88	88	85	85
1	83	81	79	77	81	80
2	79	75	70	68	77	73
3	73	68	65	60	72	68
4	69	63	58	55	68	61
5	65	57	54	50	64	57
6	61	54	48	45	59	53
7	57	50	45	40	56	48
8	54	46	40	38	53	46
9	51	42	38	34	50	42
10	47	40	34	32	47	40

\*Readings at working plane, 2'6" above floor; Beam Angle and Diameter Cutoff at 50% of max.  
Candlepower Coefficients used at effective reflectances of: 70% Ceiling, 50% Walls, 20% Floor

Additional photometric test files are available @ [omega-lighting.com](http://omega-lighting.com)

**OMEGA**  
LIGHTING

OMEGA LIGHTING:  
776 South Green St., Tupelo, MS 38804  
Phone 662.842.7212 FAX 662.841.5501

CANADIAN DIVISION:  
189 Bullock Drive, Markham, Ontario, Canada L3P 1W4  
Phone 905.294.9570 FAX 800.268.0003