



JMX SERIES

Lensed fluorescent High-Bay Wrap

The JMX fixture is designed to maximize efficiency and light distribution, while still remaining cost effective. Applications include manufacturing, warehouses, storage and retail applications.

The JMX series is a versatile lensed fixture that allows flexibility in design. Other options include emergency battery back-up, wire guard and occupancy sensor, which further enhance the usability of this economical fixture series.

Mounting Methods

JMX fixtures offer flexible mounting methods that include standard chain hangers, surface mounting or optional mounting features for 3/4" pendant mounting.

Hanging Options

- Surface Mount [Mounting holes provided in the housing] (Standard)
- Chain Mount [Chain hangers are supplied with the fixture] (Standard)
- Quick Cable [QC – Quick hang cable system] (Optional)
- Junction Box [JB – Slide-on splice box for 3/4" stem] (Optional)
- Pendant Stabilizer [PS – Bracket for stabilizing fixture when single point hanging with a 3/4" stem] (Optional)
- Hook [SPSH – 12" Stem, pendant stabilizer & hook for hanging in loop or eye-bolt] (Optional)
- Quick Toggle [SPST – 12" Stem, pendant stabilizer & quick toggle hanger for hanging in an eye-bolt] (Optional)

Product Construction

The JMX fixture housing and end caps are brake formed from heavy gauge cold rolled steel. 87% reflective white enamel finish is utilized.

Optical Reflector

The system is precision brake formed of the selected aluminum material. The one piece reflector is removable without the use of tools, using 1/4 turn fasteners to secure it in place.

Lampholders

Made of a Polycarbonate material; these locking-style lampholders are utilized to ensure positive lamp retention. Additionally, the material contributes to a longer life product in high temperature applications.

Lens

The standard lens is a durable, 0.118" Clear Lexan.

Ballasts

All ballasts are electronic programmed-start (T5HO) or instant-start (T8) as a standard. Optional ballasts are available, consult factory for available systems and system specifications. Available voltages: 120v, 277v, 347v, voltage sensing 120-277v and 347-480v.

Listings

All fixtures are UL and CUL listed.

Please specify when ordering

Fixture Series	Lens	# of Lamps	Lamp Type	Voltage	# Ballasts	Ballast Type	Reflector	Hanging	Options	Lamp Color	Lamp Options
JMX											

Fixture ordering guide

Fixture Series	Lens	# of Lamps	Lamp Type	Voltage	# Ballasts	Ballast Type	Reflector	Hanging	Options	Lamp Color	Lamp Options*2
JMX	DLI	2	32	12	1	HI	E	BLANK	E ()	BLANK	HP
JMXT*1		3	54	27	2	LI	W	JB	F	830	A
		4		34	3	SI	B	PS	20G	835	ES ()
				UV	4	SI+		QC	OS ()	841	XL
				HV		PS		QC ()	SDT	850	
						PSL		SPSH	PC		
						PSH		SPST	WG		
						PD					
						SDH					
						AX					

*1 JMXT is an 8ft Tandem fixture, # of lamps are for the profile of the fixture.

*2 Consult factory for manufacturing specific ordering codes/availability.

Available fixture selections

Lens Selections	Reflector Selections	Ballast Selections	Hanging Selections	Lamp Color Selections
DLI 0.118" Clear Lexan	E Enhanced Aluminum W Highly Reflective White Aluminum B 95% Reflective Extreme White Aluminum	HI High Ballast Factor (HBF) Electronic* LI Low Ballast Factor (LBF) Electronic* SI Standard Ballast Factor (NBF) Electronic* SI+ I.OBF Electronic* PS Programmed Start (NBF) PSL Programmed Start LBF* PSH Programmed Start HBF* PD Programmed Start Dimming SDH Step Dimming HBF (100% to 60% Dimming)* AX Daylight Harvesting Ballast with remote mount photosensor*	Blank V-Chain Hangers JB Slide-On Junction Box PS Pendant Stabilizer QC Quick Hang Cable (10') QC() Quick Hang Cable (Specify Length) SPSH 12" Stem/PS/Hook SPST 12" Stem/PS/Toggle	BLANK Lamps Not Included 830 80+ CRI, 3000K 835 80+ CRI, 3500K 841 80+ CRI, 4100K 850 80+ CRI, 5000K
Voltage Selections	Options Selections			Lamp Options Selections
12 120V 27 277V 34 347V UV 120-277V HV 347-480V	E() Emergency Pack (# Lumens) F Inline Fuse 20G 20 Gauge OS () Occupancy Sensor (Specify Lamps on Low/Lamps on High) SDT Step Down Transformer (480V to 277V) PC Photocell WG Wire Gaurd	* T8 Only		HP High Performance, Long Life Lamps* A Amalgam Tip Lamps** ES() Energy Saver (Specify Wattage) XL Long Life*
Lamp Type Selections				* T8 Only ** T5HO Only
32 F32T8 System 54 F54T5HO System				

Common fixture selections

Catalog number	System	# of lamps	Wattage (120/277V)*	Initial system lumens*	Mean system lumens*
JMX DLI 254 UV IPS W	T5HO	2	116w / 115w	10,000	9,500
JMX DLI 332 UV ISI W	T8	3	82w / 80w	8,091	7,830
JMX DLI 232 UV IHI W	T8	4	148w / 145w	14,160	13,703
JMX DLI 454 UV IPS E	T5HO	4	232w / 226w	20,000	19,000

*Wattages may vary depending on the ballast manufacturer and lamp type used.

Initial and mean system lumens are the initial/mean lumen output of the lamp/ballast system as rated by lamp and ballast manufacturer and may vary from manufacturer to manufacturer.

Specifications and dimensions subject to change without notice. Contact Philips Optimum for current availability and ordering information

Dimensional drawing

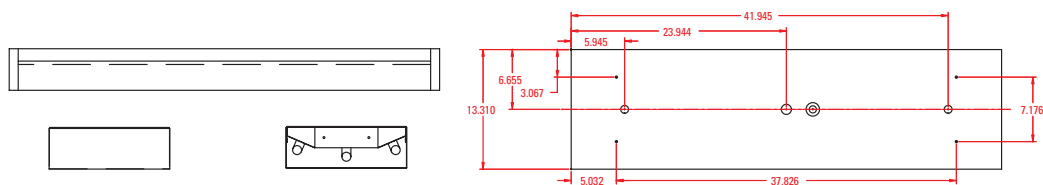

Fixture Type: _____

Catalog #: _____ Quantity: _____

Project: _____