

## WN SERIES

### Narrow style fluorescent Wrap

An efficient fluorescent wrap style fixture that provides an economical solution for exceptional light distribution in general areas in a narrow profile housing.

Applications include classrooms, hallways, warehouses, closets, offices, manufacturing workstations and retail. The WN is often installed in continuous rows to obtain optimal light distribution in hallways and similar areas.

The WN series is a versatile lensed fixture that allows flexibility in design. Other options include emergency battery back-up and occupancy sensor, which further enhance the usability of this economical fixture series.

The Linear Prism design along each side of the lens allows for optimal light output and superior distribution, while minimizing glare.

#### Mounting Methods

WN fixtures offer flexible mounting methods that include: standard chain hangers, pendant mounting, surface mounting or optional cable hanging.

#### Hanging Options

- Surface Mount [Mounting holes provided in the housing] (Standard)
- Chain Mount [Mounting holes provided in the housing] (Standard)
- Quick Cable [QC – Quick hang cable system] (Optional)
- Pendant Mount [Mounting holes provided in the housing] (Standard)

#### Product Construction

The WN fixture housing is brake formed from heavy gauge cold rolled steel. Ends are permanently riveted in place to form a rigid finished product. The housing is white with a durable, highly reflective finish.

#### Optical Reflector

The system is precision brake formed of the selected aluminum material.

#### Lampholders

Made of a Polycarbonate material; these locking-style lampholders are utilized to ensure positive lamp retention. Additionally, the material contributes to a longer life product in high temperature applications.

#### Lens

The standard lens is a high quality acrylic prismatic with linear refractive sides that provides even light distribution. Optional 0.125" prismatic (D125) is also available, for large orders see ordering information.

#### Ballasts

All ballasts are electronic programmed-start (T5HO) or instant-start (T8) as a standard. Optional ballasts are available, consult factory for available systems and system specifications. Available voltages: 120v, 277v, 347v, voltage sensing 120-277v and 347-480v.

#### Listings

All fixtures are UL and CUL listed.

**PHILIPS**

Please specify when ordering

Fixture Series	Lens	# of Lamps	Lamp Type	Voltage	# Ballasts	Ballast Type	Reflector	Hanging	Options	Lamp Color	Lamp Options
WN											

### Fixture ordering guide

Fixture Series	Lens	# of Lamps	Lamp Type	Voltage	# Ballasts	Ballast Type	Reflector	Hanging	Options	Lamp Color	Lamp Options*3
WN	BLANK	1	17	12	1	HI	BLANK	BLANK	E ( )	BLANK	HP
WNT*1	D125*2	2	24	27	2	LI	E		F	830	A
WN6T*1			25	34		SI	W		20G	835	ES ( )
			28T5	UV		SI+	B		OS ( )	841	XL
			32	HV		PS			SDT	850	
			39			PSL			PC		
			54			PSH					
						PD					
						SDH					
						AX					

\*1 WNT is an 8ft Tandem fixtures & WN6T is a 6ft Tandem fixture, # of lamps are for the profile of the fixture.

\*2 D125 lens only available for large fixture orders.

\*3 Consult factory for manufacturing specific ordering codes/availability.

### Available fixture selections

Lens Selections	Reflector Selections	Ballast Selections	Hanging Selections	Lamp Color Selections
BLANK Clear Prismatic Acrylic D125 0.125 Prismatic	BLANK No Reflector (Standard White Covers) E Enhanced Aluminum W Highly Reflective White Aluminum B 95% Reflective Extreme White Aluminum	HI High Ballast Factor (HBF) Electronic* LI Low Ballast Factor (LBF) Electronic* SI Standard Ballast Factor (NBF) Electronic* SI+ I.OBF Electronic* PS Programmed Start (NBF) PSL Programmed Start LBF* PSH Programmed Start HBF* PD Programmed Start Dimming SDH Step Dimming HBF (100% to 60% Dimming)* AX Daylight Harvesting Ballast with remote mount photosensor*	BLANK Surface Mount  <b>Options Selections</b> E ( ) Emergency Pack (# Lumens) F Inline Fuse 20G 20 Gauge OS ( ) Occupancy Sensor (Specify Lamps on Low/Lamps on High) SDT Step Down Transformer (480V to 277V) PC Photocell	BLANK Lamps Not Included 830 80+ CRI, 3000K 835 80+ CRI, 3500K 841 80+ CRI, 4100K 850 80+ CRI, 5000K  <b>Lamp Options Selections</b> HP High Performance, Long Life Lamps* A Amalgam Tip Lamps*** ES ( ) Energy Saver (Specify Wattage)** XL Long Life*
<b>Voltage Selections</b> 12 120V 27 277V 34 347V UV 120-277V HV 347-480V				
<b>Lamp Type Selections</b> 17 F17T8 System 24 F24T5HO System 25 F25T8 System 28 F28T5 System 32 F32T8 System 39 F39T5HO System 54 F54T5HO System		* T8 Only		* T8 Only ** 32w T8, 28w T5 & 54w T5HO Only *** 54w T5HO Only

### Common fixture selections

Catalog number	System	# of lamps	Wattage (120/277V)*	Initial system lumens*	Mean system lumens*
WN 132 UV 1LI W	T8	1	25w / 25w	2,387	2,310
WN 154 UV 1PS E	T5HO	1	71w / 71w	5,600	5,432
WNT 132 UV 1SI W	T8	2	54w / 53w	5,394	5,220
WNT 254 UV 1PS E	T5HO	4	232w / 226w	20,000	19,000

\*Wattages may vary depending on the ballast manufacturer and lamp type used.

Initial and mean system lumens are the initial/mean lumen output of the lamp/ballast system as rated by lamp and ballast manufacturer and may vary from manufacturer to manufacturer.

Specifications and dimensions subject to change without notice. Contact Philips Optimum for current availability and ordering information

### Dimensional drawing

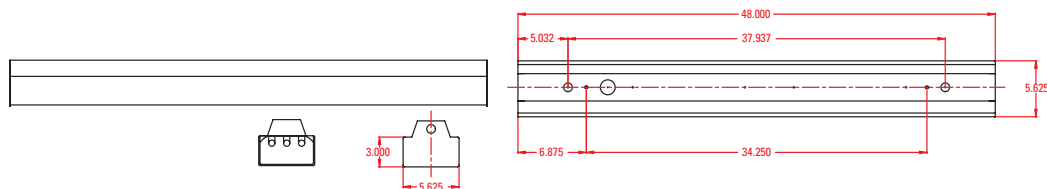

Fixture Type: \_\_\_\_\_

Catalog #: \_\_\_\_\_ Quantity: \_\_\_\_\_

Project: \_\_\_\_\_

**PHILIPS**