

PHILIPS

DESIGNER-STYLE, MICRO-TOUCH
MULTI-SCENE DIGITAL DIMMER
FOR ADVANCE MARK 10 BALLASTS
HIGH-WATTAGE: 600VA-1500VA

(FOR 600VA LOW-WATTAGE SEE MULTISET PRO "MSP" SERIES)

Project:

Location/Type:

Description

The MultiSet Pro High-Wattage Electronic Dimmable Fluorescent Ballast EB Dimmer is a digital, micro-touch preset dimmer, designed for use with high-wattage fluorescent loads from 600VA-1500VA (see chart on back page). The unit is equipped with an automatic fade and LED readout, providing full-function, three-way and multi-location dimming control when used with Lightolier Controls MultiSet Pro Channel Remotes. MultiSet Pro Masters provide up to thirteen preset scenes within a network of up to 30 dimmers and masters. This unit is designed to control permanently installed fluorescent loads equipped with Advance Mark 10 or other direct drive dimmable electronic ballasts at 120V.

NOTE: For low-wattage, 600VA units, look for the MultiSet Pro "MSP" series.

Features

- LED readouts, including:
 - A soft green LED which indicates the current preset.
 - A bright green LED which indicates the current level.
 - A blinking red LED which indicates a fading off process.
 - A glowing red LED which indicates that the dimmer is off.
- As an individual device, the MultiSet Pro High-Wattage electronic dimmable fluorescent ballast EB dimmer has the capability to recall two presets—a user-selected "on" level and full brightness. However, with a MultiSet Pro Master, the dimmer can recall up to thirteen preset scenes.
- Programmable fade rate—The device shall have a total of twelve fade rates, programmable by scene, ranging from one second to one hour.
- 2-Way communication—The device shall be capable of 2-way communication between the master control station and the dimmer so that the system On/Off status is always known.
- Manual override—allows the lights to be adjusted to any level without affecting the preset level(s).
- Automatic fade—gently turns the lights on and off, thereby preserving the unit's lamp life.
- Power failure memory—a feature that returns the dimmer to the level of lighting the unit held before the power failure occurred.
- Full-Function MultiSet Pro Channel Masters take control of up to four devices from multiple locations and permit full-function dimming capabilities.
- Full-Function MultiSet Pro permits total dimming control of up to 30 dimmers and masters on the network. In addition, they allow up to thirteen preset scenes. Please note that MultiSet Pro Masters and devices are not phase-sensitive.

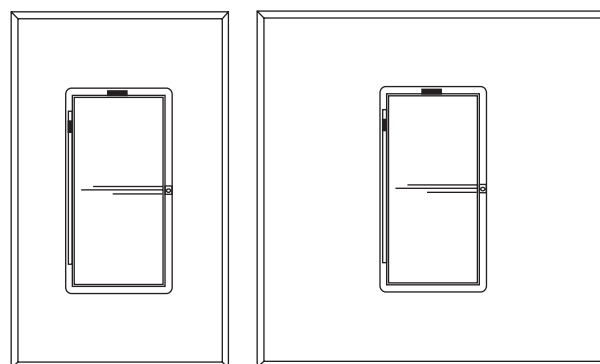

MHP600EB / MHP1000EB

MHP1500EB

Faceplates included
Custom engraved faceplates available.

Description	Model Number	Color Suffix
MultiSet 600VA EB Dimmer	MHP600EB	W I BL
MultiSet 1000VA EB Dimmer	MHP1000EB	W I BL
MultiSet 1500VA EB Dimmer	MHP1500EB	W I BL

W=White, I=Ivory, BL=Black

MultiSet Pro Operation

- Set a preset from the off position (individual):
 - Press and hold down the rocker top located on the device.
 - Release the rocker top at the desired level.
 - Press the "Set" button which is located on the device frame.
- Set a preset (MultiSet Pro Master):
 - Press the desired scene on any MultiSet Pro Master.
 - Press down on the top or bottom of the dimmer rocker and hold.
 - Release the dimmer rocker at the desired level.
 - Press the button labeled "Set" which is located on the device frame.
- Turn a group of lights on to the preset (individual):
 - Tap the rocker top once.
- Turn a group of lights on to the preset (MultiSet Pro Master):
 - Press the desired scene on the network master control, or activate the individual dimmer's "on" preset by touching the rocker top once.
- Turn a group of lights on to full power:
 - Tap the rocker top twice or, in MultiSet Pro Master applications, look on any MultiSet Pro Master and touch the preset labeled "On" twice.
- Adjust the lighting level of an individual dimmer:
 - Hold down the top or bottom of the rocker top.
 - When the desired lighting level is reached, release.
- Adjust the lighting level of a group of dimmers:
 - Hold down the top or bottom of any MultiSet Pro Master Control.
 - When the desired lighting level is reached, release.
- Turn the individual dimmer off:
 - Tap the rocker bottom once for fade to Off or twice for rapid Off.
- Turn a group of dimmers off:
 - Tap the bottom of the MultiSet Pro Master Control.

Made in U.S.A.

For technical/sales assistance, call: 1-800-526-2731

www.philips.com/lightingcontrolsna

P/N 87-0271D

MULTISET PRO HIGH-WATTAGE ELECTRONIC DIMMABLE FLUORESCENT BALLAST EB DIMMER

Product
Specifications

Specifications

The MultiSet Pro High-Wattage electronic dimmable fluorescent ballast EB dimmer is available in White, Ivory, and Black. Each device is UL Listed to U.S. and Canadian safety standards for 20VAC, 60Hz, 600VA, 1kVA and 1.5kVA operations to control direct drive forward phase ballast, Advance Mark 10 or other direct drive dimmable electronic ballasts operating at 120V lighting loads. Device operations include:

- Fade to preset
- Fade to full brightness
- Fade to off

The unit has the capability of storing two presets in its memory—a user-selected preset and full brightness. Twelve additional, hidden scenes may be accessed using a MultiSet Pro Master. The dimmer allows manual override of any preset level, without affecting the level set into memory.

The MultiSet Pro System also permits simultaneous control up to 30 dimmers, switches and masters. It recalls either five or thirteen scenes, in addition to the “off” position and is not phase-sensitive.

Programmable fade rate—The device has a total of twelve fade rates, programmable by scene, ranging from one second to one hour.

2-Way communication—The device is capable of 2-way communication between the master and the dimmer so that the system On/Off status is always known.

Following a power interruption, the MultiSet Pro High-Wattage Electronic Dimmable Fluorescent Ballast EB Dimmer returns to the lighting level it maintained before the interruption. It also accepts full-function commands from an unlimited number of multi-location MultiSet Pro Channel Remotes.

This device is compatible with Lightolier Controls Brilliance II Control Systems. Its toroidal filters are used to suppress RFI and EMI. The unit's air gap is used to open the circuit completely. However, the air gap is unobtrusive and is not required for normal operations.

Dimensions

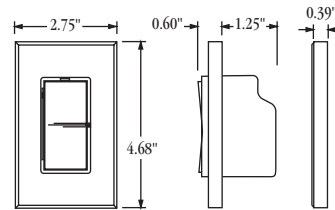

MHP600EB / MHP1000EB

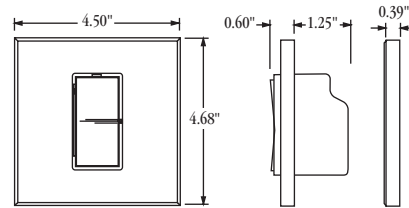

MHP1500EB

Fins Broken De-Rating Chart

Dimmer Rating	600VA	1000VA	*1500VA
1 Side Removed	600VA	800VA	1300VA
2 Sides Removed	600VA	600VA	1100VA

*For noise sensitive areas use optional LM-HIFO to minimize filament sing.

Wiring Diagram

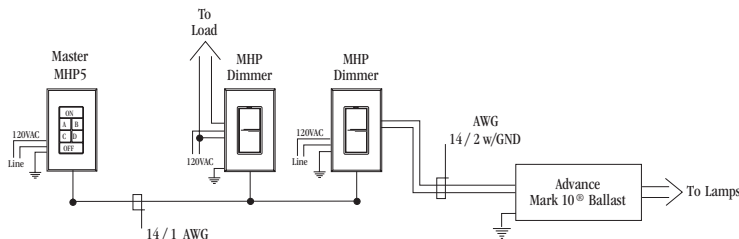

MHP1500EB



NOTICE: MultiSet Pro devices are not intended for use with Arc Fault Circuit Interrupter Breakers (AFCI).

We reserve the right to change details of design, materials and finish in any way that will not alter the installed appearance or reduce function performance.

Philips Lighting Controls
2828 Trade Center Dr., Suite 130B
Carrollton, TX 75007

For technical/sales assistance, call: 1-800-526-2731

Made in U.S.A.

www.philips.com/lightingcontrolsna

P/N 87-0271D