

PHILIPS

DESIGNER-STYLE, MICRO-TOUCH MULTI-SCENE DIGITAL NON-DIM SWITCH 1000VA/2000VA

(FOR 600VA LOW-WATTAGE SEE "MSP" SERIES)

Project: _____

Location/Type: _____

Description

The MultiSet Pro High-Wattage Electronic Universal Switch is a 1000VA/2000VA designer-style switch. It provides on/off, three-way and multi-location control when used with Lightolier Controls MultiSet Pro Channel Remotes. This switch can also be included in a MultiSet Pro mastering configuration with MultiSet Pro dimmers. It can be preset for up to thirteen different scenes and, when used in conjunction with MultiSet Pro Scene Masters and MultiSet Pro dimmers, the unit can be preset to on or off.

Features

- Streamlined appearance and operations.
- LED readouts, including:
 - A bright green LED which indicates the switch is on.
 - A glowing red LED which indicates the switch is off.
- As an individual device, the MultiSet Pro High-Wattage Electronic Universal Switch can recall brightness. However, with a MultiSet Pro Scene Master, the switch can recall up to thirteen preset scenes, either on or off.
- Two-way communication—The device shall be capable of 2-way communication between the master and the switch so that the system On/Off status is always known.
- Power failure memory—a feature that returns the dimmer to the level of lighting the switch held before the power failure occurred.
- Full-Function MultiSet Pro Channel Remotes take control of up to four devices from multiple locations.
- Full-Function MultiSet Pro Masters permit control of up to 30 dimmers, switches and masters. They allow access to up to thirteen preset scenes. Please note that MultiSet Pro Scene Masters are not phase-sensitive.

MultiSet Pro Operation

- Turn switch on:
 - Press the top of the rocker.
- Turn switch off:
 - Press the bottom of the rocker.
- Set a preset (MultiSet Pro Scene Master):
 - Press the desired scene on any MultiSet Pro Scene Master.
 - Turn the switch on or off.
 - Press the "Set" button which is located on the device frame.
- Turn a group of lights on to the preset (MultiSet Pro Scene Master):
 - Press the desired scene on the MultiSet Pro Scene Master.
- Turn a group of switches on:
 - Press the top of the MultiSet Pro Channel Master.
- Turn a group of switches off:
 - Press the bottom of the MultiSet Pro Channel Master.

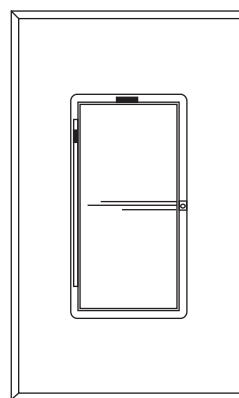

MHP1000ND

Faceplate Included
Custom engraved faceplates available.

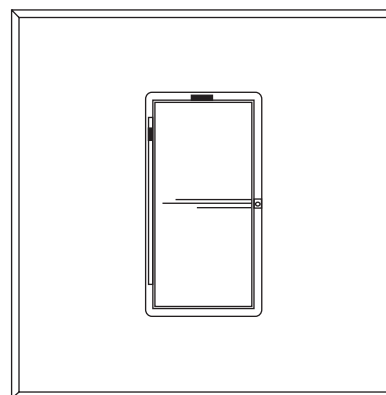

MHP2000ND

Faceplate Included
Custom engraved faceplates available.

Description	Model Number	Color Suffix
MultiSet Pro 1000VA Switch	MHP1000ND	W I BL
MultiSet Pro 2000VA Switch	MHP2000ND	W I BL

W=White, I=Ivory, BL=Black

Made in U.S.A.

For technical/sales assistance, call: 1-800-526-2731

www.philips.com/lightingcontrolsna P/N 87-0186B

MULTISET PRO HIGH-WATTAGE ELECTRONIC UNIVERSAL SWITCH

Product
Specifications

Specifications

The MultiSet Pro High-Wattage Electronic Universal Switch is available in white, ivory, grey, almond, black, and brown. Each device is UL Listed to U.S. and Canadian safety standards for 120VAC, 60Hz, 1000VA and 1920VA operations to control low-voltage, neon, cold cathode, fluorescent and general inductive loads. Device operations include the on and off functions. When using MultiSet Pro Scene Masters, the on and/or off functions may be learned to any one of thirteen scenes.

The MultiSet Pro Scene System also permits simultaneous control up to 30 dimmers, switches, and masters. It recalls either two, five or thirteen scenes, in addition to the "off" position, and is not phase sensitive.

2-Way communication—The device has capable of 2-way communication between the master and the dimmer so that the system On/Off status is always known.

The device is programmable as either a 4- or 5-scene device. As a 5-scene device it can be programmed as either On or Off from the master On preset.

Following a power interruption, the MultiSet Pro High-Wattage Electronic Universal Switch returns to the lighting level it maintained before the interruption. It accepts full-function commands from an unlimited number of multi-location MultiSet Pro Channel Remotes.

This device is compatible with Lightolier Controls Brilliance II Control Systems. The unit's air gap is used to open the circuit completely. However, the air gap is unobtrusive and is not required for normal operations.

Each MultiSet Pro High-Wattage Electronic Universal Switch includes a proprietary, designer-style faceplate.

Dimensions

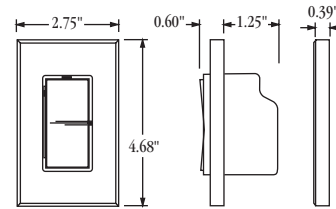

MHP1000ND

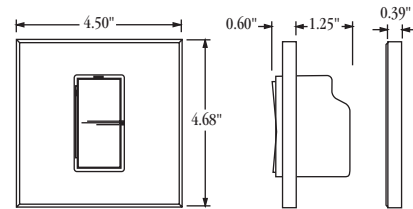

MHP2000ND

Fins Broken De-Rating Chart

Dimmer Rating	1000VA	2000VA
1 Side Removed	800VA	1800VA
2 Sides Removed	600VA	1600VA

Wiring Diagram

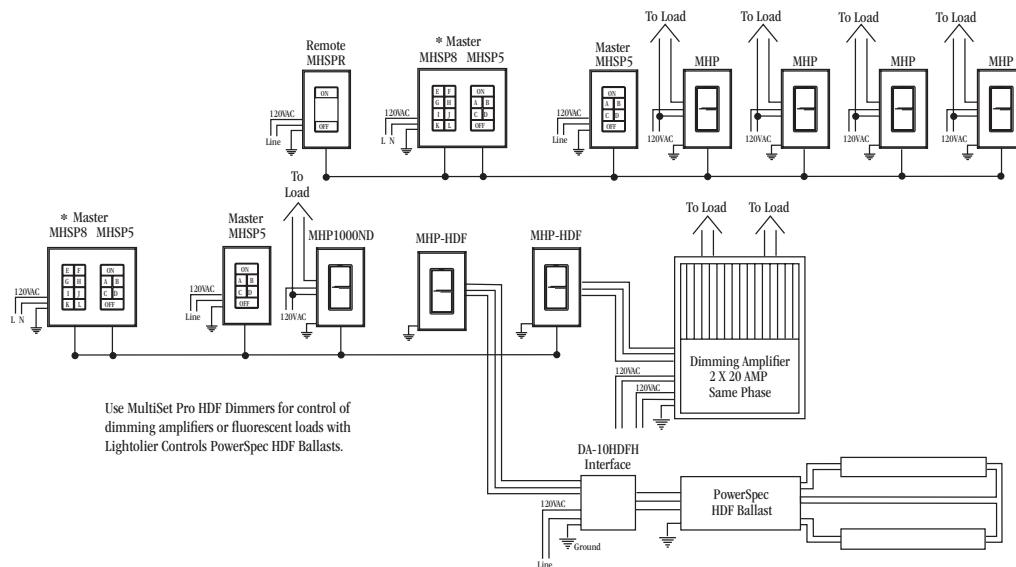

NOTICE: MultiSet Pro devices are not intended for use with Arc Fault Circuit Interrupter Breakers (AFCI).

We reserve the right to change details of design, materials and finish in any way that will not alter the installed appearance or reduce function performance.

Philips Lighting Controls
2828 Trade Center Dr., Suite 130B
Carrollton, TX 75007

For technical/sales assistance, call: 1-800-526-2731

Made in U.S.A.

www.philips.com/lightingcontrolsna P/N 87-0186B