



# LyteSwitch Two

## Programming relay cabinets

### Easy integration into lighting systems

The Philips LyteSwitch Two Relay Solution is a family of high performance programmable relay lighting controllers designed for easy integration with any lighting system. A scalable design allows up to 48 relays to be chained together via CAT5e cable. Cabinets are available in 4, 8, 16 and 32 densities.

- Inexpensive expansion – Easily chain a master relay cabinet with relay enclosures into 'mini-spurs' of relays with CAT5e to increase relay count (up to 48 per control source).
- Small footprint – Allows flush or surface mounting of all cabinet sizes (optional trim ring available).
- Easy programming – Allows contractor or end-user to set-up system.
- Integration options – DMX/DyNet master relay cabinet available for integration with any DMX controller or DyNet devices.
- Analog Option – Allows conventional switches to be integrated.
- Modular approach – Available in 4, 8, 16 & 32 circuit relay panel sizes.
- Control options – Button stations available, providing simple direct control of mini-spurs.

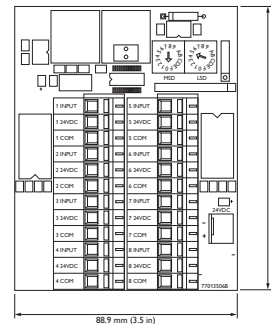

#### Ordering Guide Enclosure<sup>1</sup>

Series	Circuit	Enclosure	347V Option
DC-DRE-1-	<input type="text"/>	<input type="text"/> -001	-347
LyteSwitch Two Relay Solution	4 = 4 Circuit 8 = 8 Circuit 16 = 16 Circuit 32 = 32 Circuit	M = Master MD = Master w/DMX <sup>3</sup> S = Expansion <sup>6</sup>	

#### Additional Relays (Spare)<sup>1</sup>

Series	Relay	Pole
DC-DRE-1-	<input type="text"/>	<input type="text"/> -001
LyteSwitch Two Relay Solution	NO = Normally Open	1 = Single 2 = Dual <sup>4</sup>

#### Interface Modules<sup>2</sup>

Series	Interface Card
DC-DRE-	<input type="text"/> -001
LyteSwitch Two Relay Solution	AIA = Analog Input

#### Ordering Guide Optional Trim Ring

Series	Option	Circuit
DC-DRE-	TR	<input type="text"/> -001
LyteSwitch Two Relay Solution	TR = Trim Ring	4 = 4 Circuit 8 = 8 Circuit 16 = 16 Circuit 32 = 32 Circuit

#### Ordering Guide Optional Simple-P User Interface Control Panels<sup>7</sup>

Series	Option	Circuit
DC-DRE-	SP	<input type="text"/> -001
LyteSwitch Two Relay Solution	SP = Simple-P	1= 1 Button User Control Panel 2= 2 Button User Control Panel 3= 3 Button User Control Panel 4= 4 Button User Control Panel 5= 5 Button User Control Panel 6= 6 Button User Control Panel KM = Key Switch Panel (momentary) KH = Key Switch Panel (held)

#### Ordering Guide Optional Simple-P Accessories

Series	Circuit
DC-DRE-	<input type="text"/> -001
LyteSwitch Two Relay Solution	PCI = Indoor Photo Sensor PCO = Outdoor Photo Sensor OSI = Occupancy Input Interface PSR = Power Supply Repeater

1. Enclosures come fully populated with single pole, normally open relays. Spare relays are available for field change-out. Cabinets can be custom populated on orders with over 50 cabinets and require a lead time of 8 weeks for delivery.

2. Only 1 interface module may be installed per Mini-Spur

3. Integration with DYNALITE requires a single Master Enclosure w/DMX per Mini-Spur and a DDNG485-NA for integration.

4. Dual pole is not available with the 347V configuration.

5. Simple-P panels and accessories are for control of DRE cabinet Mini-Spurs only. They do not communicate with DyNet devices or networks.

6. The 32 circuit option is not available as an expansion cabinet.

7. Simple-P user control panels are available in White only.



## Specifications

Due to continuous improvements and innovations, specifications may change without notice.

Item	Specification	Details
Electrical	Input Voltage	120 or 277 VAC (field changeable) @ 1 A
	Relay Control	Single pole relays control 120, 277 or 347 VAC @ 20 A for lighting or plug load control 2 pole relays with the same footprint control up to 277 VAC per pole @ 20 A for ballasts, resistive and general loads
	Safeguards	Power surge and spike suppression up to 123 V on the 24 VAC power input Memory retention for firmware and programming up to 50 years Real-time clock time retention 45 days or greater without power
General	Programming	Integrated keypad with 4-line LCD display on Master Relay controllers (slave controllers are programmed from the connected master).
	Load Grouping / Presets	Groups relays to be controlled by any timer, switch, or other external commands. Connect up to 48 relays via CAT5e cabling across multiple slave relay enclosures. Presets can be programmed from any relay ON/OFF patterns.
	Clock Functions	Timer Scheduling for 48 available timers that can turn relays ON or OFF based on time-of-day or astronomical time. Unique Open/Close functionality allowing programming of store opening and closing hours and triggerings of timed functions based on these hours. Automatic astronomical calculation of sunrise and sunset and adjustable daylight saving time and enable/disable.
	Switch Input Module (optional)	Switching inputs allow for momentary or maintained, 2 or 3-wire switching from third party devices.
Physical	Dimensions (H x W x D)	4 relay: 12" x 14" x 4" (305 mm x 356 mm x 102 mm) 8 relay: 16" x 14" x 4" (406 mm x 356 mm x 102 mm) 16 relay: 24" x 14" x 4" (610 mm x 356 mm x 102 mm) 32 relay: 42" x 14" x 4" (107 cm x 356 mm x 102 mm)
	Packed Weight	4 relay master enclosure 16 lbs (7.27 kg) 8 relay Master Enclosure 20 lbs (9.09 kg) 16 relay Master Enclosure 27 lbs (12.27 kg) 32 relay Master Enclosure 51 lbs (23.18 kg)
	Construction	4, 8, and 16 relay versions: 16GA CRS galvanized enclosure, 18GA CRS painted door w/ 2 hinges and 1 lock 32 relay version: 16GA CRS galvanized enclosure, 16GA CRS painted door w/ 2 hinges and 1 lock
	Mechanical	Double sided construction for wiring on both sides Provided with pre-drilled mounting holes Provided with removable hinged locking door for flush or surface mounting High voltage barriers separate Normal/Emergency and Class 1/Class 2 wiring
	Operating Conditions	Location: Interior space Temperature: 32 to 104° F (0 to 40° C) ambient Humidity: 10 to 90% non-condensing Vibration: stationary

## Ordering

Code	Details	Philips 12NC
DC-DRE-I-4M-001	LS2 4 Master Enclosure 120/277V	912400518681
DC-DRE-I-8M-001	LS2 8 Master Enclosure 120/277V	912400518683
DC-DRE-I-16M-001	LS2 16 Master Enclosure 120/277V	912400519015
DC-DRE-I-32M-001	LS2 32 Master Enclosure 120/277V	913701263001
DC-DRE-I-4M-001-347	LS2 4 Master Enclosure 347V	913701263401
DC-DRE-I-8M-001-347	LS2 8 Master Enclosure 347V	913701263701
DC-DRE-I-16M-001-347	LS2 16 Master Enclosure 347V	913701262701
DC-DRE-I-32M-001-347	LS2 32 Master Enclosure 347V	913701263101
DC-DRE-I-4S-001	LS2 4 Slave Relay Enclosure 120/277V	912400518682
DC-DRE-I-8S-001	LS2 8 Slave Relay Enclosure 120/277V	912400518684
DC-DRE-I-16S-001	LS2 16 Slave Relay Enclosure 120/277V	912400519016
DC-DRE-I-4S-001-347	LS2 4 Slave Relay Enclosure 347V	913701263601
DC-DRE-I-8S-001-347	LS2 8 Slave Relay Enclosure 347V	913701263901
DC-DRE-I-16S-001-347	LS2 16 Slave Relay Enclosure 347V	913701262901
DC-DRE-I-4MD-001	LS2 4 Master Enclosure wDMX 120/277V	912400519017
DC-DRE-I-8MD-001	LS2 8 Master Enclosure wDMX 120/277V	912400519018
DC-DRE-I-16MD-001	LS2 16 Master Enclosure wDMX 120/277V	912400519188
DC-DRE-I-32MD-001	LS2 32 Master Enclosure wDMX 120/277V	913701263201
DC-DRE-I-4MD-001-347	LS2 4 Master Enclosure wDMX 347V	913701263501
DC-DRE-I-8MD-001-347	LS2 8 Master Enclosure wDMX 347V	913701263801
DC-DRE-I-16MD-001-347	LS2 16 Master Enclosure wDMX 347V	913701262801
DC-DRE-I-32MD-001-347	LS2 32 Master Enclosure wDMX 347V	913701263301
DC-DRE-AIA-001	LS2 Analog Input Option Card	912400518489
DC-DRE-BCIP-001	BACnet IP Module	912400529648
DC-DRE-I-NO1-001	LS2 1 Pole Normally Open Relay	912400519020
DC-DRE-I-NO2-001	LS2 2 Pole Normally Open Relay	912400519021
DC-DRE-IP-001	TCP / IP Module	912400531260
DC-DRE-TR-004	LS2 4 Flush Trim Ring	912400518412
DC-DRE-TR-008	LS2 8 Flush Trim Ring	912400518413
DC-DRE-TR-016	LS2 16 Flush Trim Ring	912400518414
DC-DRE-TR-032	LS2 32 Flush Trim Ring	912400531502



**UL and cUL Listed, FCC Part 16, FCC Part 68, Title 2, ASHRAE compliant**



**Philips Lighting North America**  
200 Franklin Square Dr  
Somerset, NJ, United States  
Tel: 1-800-526-2731  
Email: controls.support@philips.com  
Web: www.philips.com/lightingcontrolsna

**Philips Lighting Canada**  
281 Hillmount Road  
Markham, Ontario L6C 2S3  
Canada

© 2015 Koninklijke Philips N.V. (Royal Philips). All rights reserved. Specifications are subject to change without notice. Trademarks are the property of Koninklijke Philips N.V. (Royal Philips) or their respective owners.