



OccuSwitch Wireless

Wall Dimmer with Wireless Communication LRD1730

Philips OccuSwitch Wireless control system is a simple, easy, and effortless way to create a more sustainable work environment.

This wall dimmer is part of the OccuSwitch Wireless Lighting Control family of products that provide automatic lighting control for energy management without sacrificing task appropriate lighting. The wireless feature adapts well to retrofit installations where pulling wires across existing ceilings is cost prohibitive.

The OccuSwitch Wireless wall dimmer can be installed with other OccuSwitch Wireless products to create a complete wireless lighting control system for a single space. Up to 16 devices (switches, dimmers, occupancy sensors and multi-sensors), can be linked for manual and automatic control of the lights.

Features

- Wireless controls eliminate the need for ceiling mounted power packs.
- Attractive decorator style switch with easy to operate on/off and raise/lower operation.
- Self adaptive time delay tunes sensor to common activities in the space.
- Daylight configuration establishes the desired light level from the floor without accessing the sensor.
- Up to 16 devices can be linked together to control one space.
- Multi-way groups—two or more dimmers can be linked to form a group for multi-way operation.
- Several groups can be linked to the same set of sensors for code compliant energy management.
- Convenient dimmer based recalibration allows end-user to recalibrate at any time without accessing the sensor.
- Processor based logic reduces false triggers to optimize energy savings and potentially helps extend lamp life.
- White LED bar graphic clearly indicates dimming level and provides visual indication for some features during set-up.
- Maximum level (task tuning) can be set at the dimmer.
- Manual on/auto off mode available to meet new energy codes.
- Manual dimming override sets special light levels while the room is occupied.

Compatibility

- Compatible with Philips Advance Mark 10 Powerline and Essentialine Powerline ballasts.

Applications

- Classrooms, conference rooms, offices, restrooms (fan and lights), multi-media rooms, lounges, break rooms, lab spaces, storage areas, etc.

Job Information	Device Type #: _____
Job Name: _____	
Cat. No.: _____	
Notes: _____	

PHILIPS

OccuSwitch Wireless

Wall Dimmer with Wireless Communication (LRD1730)

Technical data*

Operating voltage: Universal—120VAC or 277VAC, 60Hz

Load rating: Electronic fluorescent ballast 120V/800VA 277V/1600VA
Incandescent lamps 120V/800W Motor load 120V/0.25HP

Compatible ballasts: Philips Advance Mark 10 Powerline—All models
EssentialLine Powerline—All models

Compatible lamps: For best dimming performance use Philips lamps

Wireless network protocol: ZigBee Pro 2.4GHz
Universal license free band

Wireless compatibility: Multiple devices can be connected: Switches (LRA1721) Dimmers (LRD1730) Occupancy Sensors (LRM1743)
Multi-Sensors (LRM1760) OSW Access Controller (OSWAC)

Colors: White and ivory

Regulatory compliance: UL, CSA, FCC, RoHS, California Title 24

Operating conditions: For Indoor use only. Temperature 41°F to 104°F (5°C to 40°C) Humidity 20% to 85% (Non-condensing)

Physical dimensions:

Length x Width x Depth: 4.13" x 2.56" x 1.79" (105 x 65 x 45 mm)

Fits in a standard single-gang wall box

Can also be installed in a multi-gang configuration if fins are removed.
Broken fin dimmers must be de-rated to 500W.

Stand alone or multi-way dimming: Each wireless dimmer can be configured to operate as a stand-alone dimmer or multi-way. By default the dimmers will act as a stand-alone device: the dimmer only controls the load that is connected to it. When configured as a multi-way dimmer, all loads are controlled from any dimmer.

Group configuration: Any set of dimmers can be linked to mimic one-another. They all can also be linked to the sensors in the room for automatic operation.

*Subject to change without notice.

Wiring diagrams

Switch

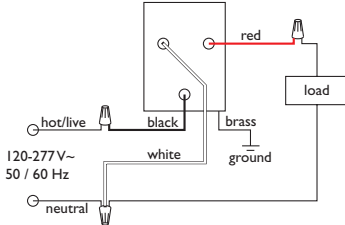

Remote Switch (3-way)

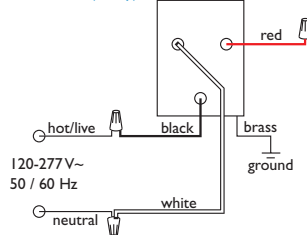

Multigang Wall Box

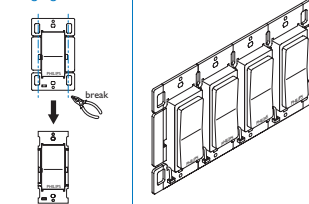

Multiple device configuration

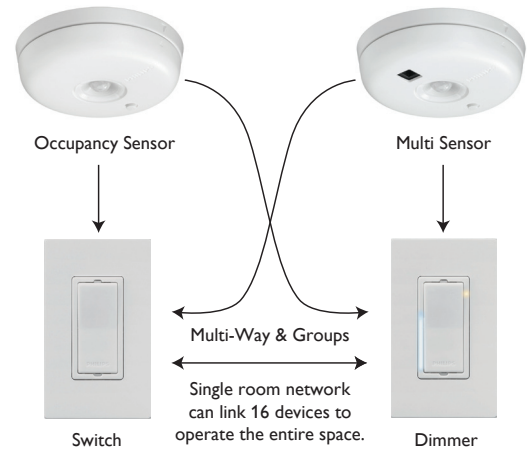

Ordering information

Ordering Code	Description
LRD1730-00	OccuSwitch Wireless Wall Dimmer; 120/277 V (White)
LRD1730-01	OccuSwitch Wireless Wall Dimmer; 120/277 V (Ivory)



©2013 Philips Lighting Electronics N.A.
A Division of Philips Electronics North America Corporation.

All rights reserved.
Published and printed in USA January 2013

Form number: DS.LRD1730.5.01092013

Philips Lighting
Customer Support: +1-855-512-8791
www.philips.com/lightingcontrolsna