



OccuSwitch Wireless

Wireless Occupancy Sensor

LRM1743

Philips OccuSwitch Wireless control system is a simple, easy, and effortless way to create a more sustainable work environment.

This ceiling mount occupancy sensor is part of the OccuSwitch Wireless Lighting Control family of products that provide automatic lighting control for energy management. The wireless feature adapts well to retrofit installations where pulling wires across existing ceilings is cost prohibitive.

The OccuSwitch Wireless occupancy sensor can be installed with the other OccuSwitch Wireless products to create a complete wireless lighting control system for a single space. Up to 16 devices (switches, dimmers, occupancy sensors and multi-sensors) can be linked to automatically control the lighting.

Features

- Passive Infrared (PIR) sensing technology coupled with high-tech logic delivers advanced occupancy detection.
- Micro controller based logic reduces false triggers to help optimize energy savings and potentially extend lamp life.
- Self adaptive time delay—manual knob sets minimum time delay only, if longer time delay is needed, the sensor self adapts to improve performance.
- Robust wireless communication with ZigBee Pro 2.4 protocol at 2.4GHz. range.
- Wireless controls eliminates the need to open the ceiling to install sensor.
- Easy to install retrofit sensor easily links to wall mount switch or dimmer.
- Meets energy codes device requirements: ANSI/ASHRAE/IESNA Standard 90.1-2010 & 189.1-2009, 2009 & 2012 IECC (International Energy Conservation Code), CEC Title 24-2010.

- Designed for 10-year no-maintenance operation with a heavy duty long life Lithium-thionyl chloride battery.
- Sleek low-profile design easily blends into any office or other professional setting.

Compatibility

- Compatible with Philips Advance Optanium programmed start and Centium ballasts and Xitanium LED drivers.

Applications

- Classrooms, conference rooms, offices, restrooms (fan and lights), multi-media rooms, lounges, break rooms, lab spaces, storage areas, etc.

Job Information	Device Type #: _____
Job Name: _____	
Cat. No.: _____	
Notes: _____	

PHILIPS

OccuSwitch Wireless

Wireless Occupancy Sensor (LRM1743)

Technical data*

Detection technology: Passive Infrared (PIR)

Intelligent delay timer: The switch-off delay minimum can be manually set between 1 and 30 minutes. Initial setting is automatically adjusted to the occupancy pattern, but never less than the manual setting.

Wireless network protocol: ZigBee Pro 2.4GHz
Universal license free band.

Wireless range:

Switch to sensor: 50' (17 m)—In office buildings.

Switch to switch (same plane): 18' (6 m).

Switch to switch (line of sight): 50' (17 m).

Wireless compatibility: Multiple devices can be connected—
Switches (LRA1721) Dimmers (LRD1730) Occupancy Sensors (LRM1743) Multi-Sensors (LRM1760) OSW Access Controller (OSWAC).

Battery: Standard AA size 3.6V DC Lithium-thionyl chloride
(Included) 10-year plus lifetime rating under normal operation.

Operating conditions: For Indoor use only. Temperature 41°F to 104°F (5°C to 40°C) Humidity 20% to 85%, (Non-condensing).

Regulatory compliance: UL, CSA, FCC, RoHS, California Title 24.

Physical dimensions:

Diameter x Depth: 3.3" x 0.98" (83 x 25 mm)

Weight: 18 oz. (0.5 kg)

Colors: Ceiling off-white.

Mounting height: Can be installed for up to 12' ceiling height.

*Subject to change without notice.

Mounting

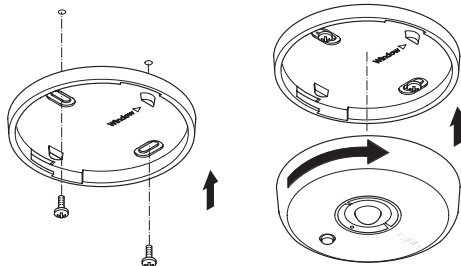

Rotating shade

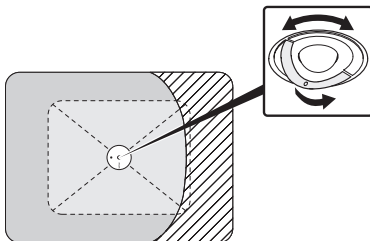

Detection area

Will vary based on ceiling height.
For a typical ceiling height of 8' (2.4 m):

Major motion 17.7' x 23.6' (5.40 m x 7.20 m)

Minor motion 11.8' x 17.7' (3.60 m x 5.40 m)

Larger areas will require multiple sensors. Up to 16 devices can be linked for one space. The retractable sensor shield can be rotated to partially mask the sensor's field of view and prevent unwanted movement detection.

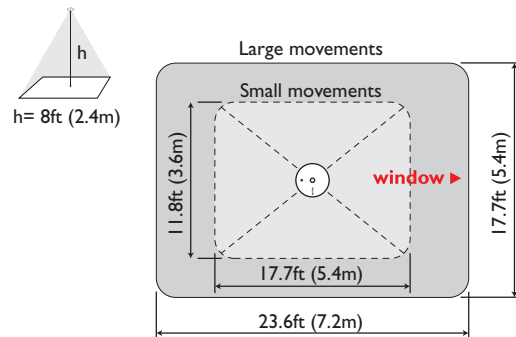

Ordering information

Ordering Code	Description
LRM1743-00	OccuSwitch Wireless Occupancy Sensor (White)



©2013 Philips Lighting Electronics N.A.
A Division of Philips Electronics North America Corporation.

All rights reserved.
Published and printed in USA January 2013

Form number: DS.LRM1743.4.01092013

Philips Lighting
Customer Support: +1-855-512-8791
www.philips.com/lightingcontrolsna