

CATALOG NO. \_\_\_\_\_

TYPE NO. \_\_\_\_\_ JOB NAME \_\_\_\_\_

# EvoScapes WallPack Series 1

## Featuring Philips LED Technology



### ORDERING INFORMATION

Catalog Number: Example: ES108UB0546KH3

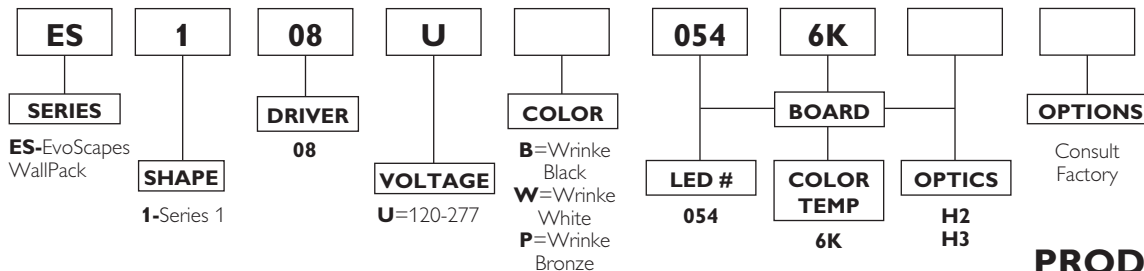

**NOTE:** Not for use in car washes.

### TECHNICAL INFORMATION

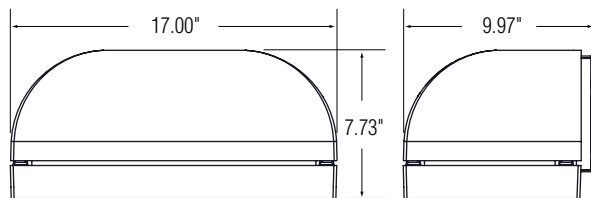

### PRODUCT SPECIFICATIONS

- Ideal for Schools, Malls, Office Buildings, Industrial Parks, Hospitals, Sports Complexes, and Commercial Centers.
- Functions in environments with temperatures that range from -30°C to 40°C.
- Heavy duty die cast aluminum housing.
- Corrosion resistant Duraplex II wrinkle bronze polyester powder coated finish standard.
- Fully tempered soda lime glass lens.
- Optional designer finishes available. (Consult factory)
- Electronic Class II LED driver accepts 120-277v, 50/60hz input (constant current).
- High-output LEDs.
- Individual precision optics collect and redirect light to optimize performance.
- Patented Philips LED Optical System individually controls the placement of light in the target area minimizing glare.
- LEDs have an average rated life of 60,000 hours.
- Integral cast aluminum heat sink ensures cool operation.
- Pre-mountable wall box with integral splice chamber. (No J-Box needed)
- Built-in bubble level for accuracy.
- Hands-free fixture to wall positioning for easy wiring.
- UL 1598 wet location listed.



UL Wet Location Listed  
Suitable for ground mounting



# EvoScapes Series 1 LED

## PHOTOMETRICS

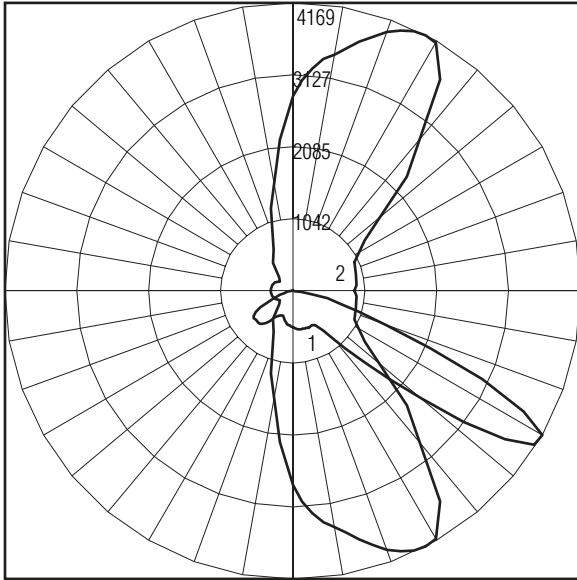

EVOSCAPE ARCHITECTURAL WALLPACK LED - TYPE II  
WITH INDIVIDUAL LED LENS OPTICS AND CLEAR FLAT GLASS LENS  
54 WHITE LEDS. LUMEN OUTPUT = 4170 LMS.

### Characteristics

IES Classification	Type II
Longitudinal Classification	Short
Cutoff Classification (deprecated)	Full Cutoff
Total Rated Lamp Lumens	4170
Maximum Candela	4169
Maximum Candela Angle	62.5H 60V
Maximum Candela At 90 Degrees Vertical	0 (0.0% Lamp Lms)
Maximum Candela from 80 to <90 Degrees Vertical	361 (8.7% Lamp Lms)
Downward Total Efficiency	100.9%
Total Luminaire Watts	87
Ballast Factor	1.00

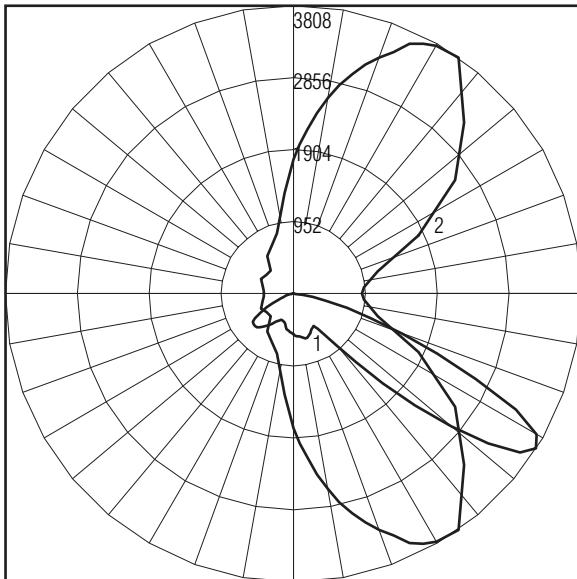

EVOSCAPE ARCHITECTURAL WALLPACK LED - TYPE III  
WITH INDIVIDUAL LED LENS OPTICS AND CLEAR FLAT GLASS LENS  
54 WHITE LEDS. LUMEN OUTPUT = 4199 LMS.

### Characteristics

IES Classification	Type III
Longitudinal Classification	Short
Cutoff Classification (deprecated)	Full Cutoff
Total Rated Lamp Lumens	4199
Maximum Candela	3808
Maximum Candela Angle	55H 57.5V
Maximum Candela At 90 Degrees Vertical	0 (0.0% Lamp Lms)
Maximum Candela from 80 to <90 Degrees Vertical	337 (8.0% Lamp Lms)
Downward Total Efficiency	100.1%
Total Luminaire Watts	87
Ballast Factor	1.00



© 2013 Koninklijke Philips N.V. (Royal Philips). All rights reserved.  
Specifications are subject to change without notice.  
[www.philips.com/luminaires](http://www.philips.com/luminaires)

05/13

Philips Lighting Company  
200 Franklin Square Drive  
Somerset, NJ 08873  
Phone: 855-486-2216

Philips Lighting Company  
281 Hillmount Road  
Markham ON, Canada L6C 2S3  
Phone: 800-668-9008