

CATALOG NO. \_\_\_\_\_

TYPE NO. \_\_\_\_\_ JOB NAME \_\_\_\_\_

# LCQ Lyte Cube

## Featuring Philips LED Technology



### ORDERING INFORMATION

Catalog Number: Example: LCQ08UB0546KT5S

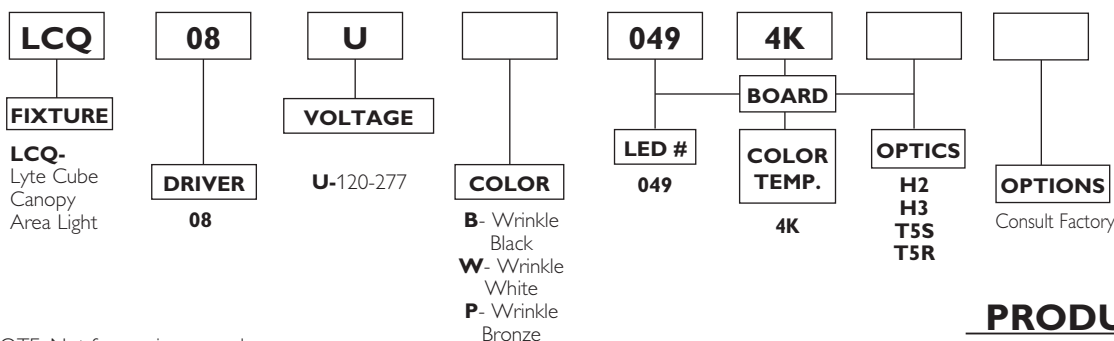

NOTE: Not for use in car washes.

### TECHNICAL INFORMATION

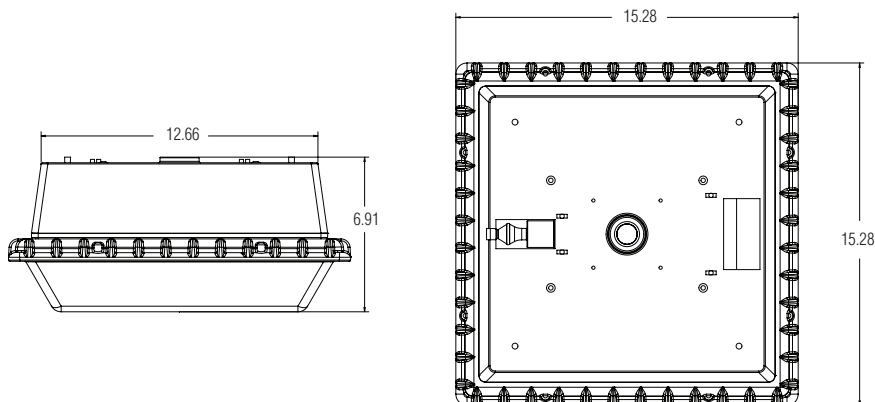

UL Wet Location Listed.  
UL File Number: E86021

### PRODUCT SPECIFICATIONS

- LCQ Canopy/Area lights are recommended for ceiling or canopy mounted installations where heights do not exceed 15 feet. Typical areas include parking garages, strip shopping mall walkways, maintenance areas, industrial corridors, low ceiling warehouses, freezers, storage areas and walk-up windows.
- Functions in environments with temperatures that range from -30°C to 40°C.
- Precision die-cast aluminum housing, finished in Duraplex II wrinkle bronze polyester, acts as a heat sink for maximum heat dissipation.
- Quick-mount plate permits easy mounting over most steel or aluminum recessed boxes, pendant or ceiling mounting.
- Electronic Class II LED driver accepts 120-277v, 50/60hz input (constant current).
- High-output LEDs.
- Individual precision optics collect and redirect light to optimize performance.
- LED Optical System individually controls the placement of light in the target area minimizing glare.
- LEDs have an average rated life of 60,000 hours.
- Fixture hinges on mounting plate allowing both hands free for wiring.
- Polycarbonate lens.



# LCQ Lyte Cube LED

## PHOTOMETRICS

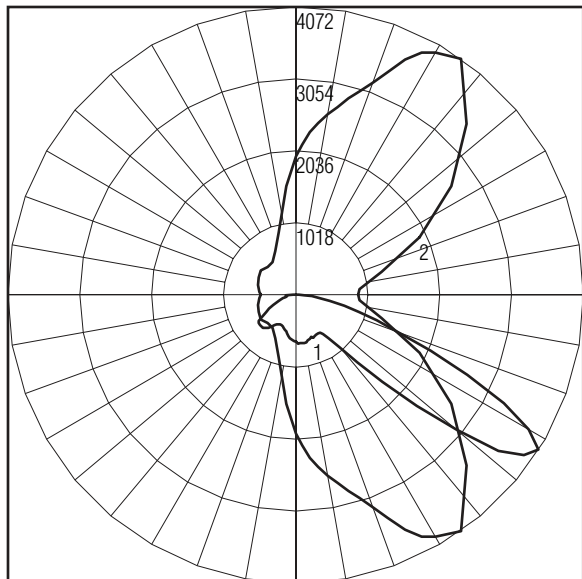

SQUARE CANOPY LIGHT - 49 LED BOARD - TYPE 2  
WITH TYPE 3 LED FREEFORM LENS OPTICS AND CLEAR PRISMATIC  
POLYCARBONATE DOME LENS  
49 WHITE LEDS. LUMEN OUTPUT = 4930 LMS.

### Characteristics

IES Classification	Type II
Longitudinal Classification	Short
Cutoff Classification (deprecated)	Semi-Cutoff
Total Rated Lamp Lumens	4930
Maximum Candela	4072
Maximum Candela Angle	55H 57.5V
Maximum Candela At 90 Degrees Vertical	71 (1.4% Lamp Lms)
Maximum Candela from 80 to <90 Degrees Vertical	760 (15.4% Lamp Lms)
Downward Total Efficiency	99.7%
Total Luminaire Watts	95
Ballast Factor	1.00

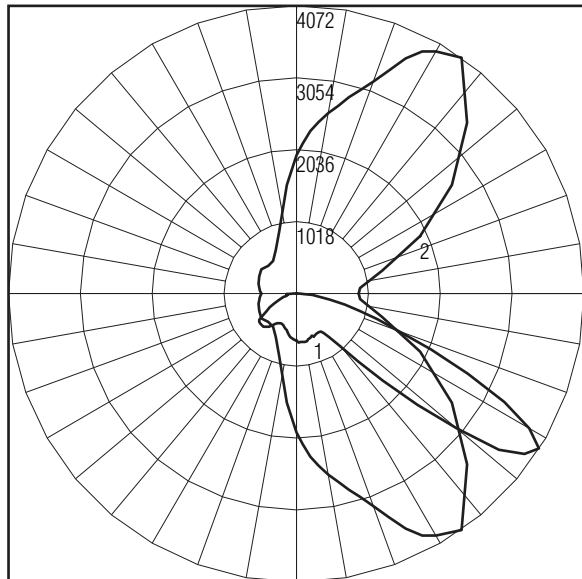

SQUARE CANOPY LIGHT - 49 LED BOARD - TYPE 3  
WITH INDIVIDUAL LED FREEFORM LENS OPTICS AND CLEAR PRISMATIC  
POLYCARBONATE DOME LENS  
49 WHITE LEDS. LUMEN OUTPUT = 4891 LMS.

### Characteristics

IES Classification	Type III
Longitudinal Classification	Short
Cutoff Classification (deprecated)	Cutoff
Total Rated Lamp Lumens	4891
Maximum Candela	1984
Maximum Candela Angle	45H 62.5V
Maximum Candela At 90 Degrees Vertical	37 (0.8% Lamp Lms)
Maximum Candela from 80 to <90 Degrees Vertical	325 (6.6% Lamp Lms)
Downward Total Efficiency	99.4%
Total Luminaire Watts	94
Ballast Factor	1.00



© 2014 Koninklijke Philips N.V. All rights reserved.  
Specifications are subject to change without notice.  
[www.philips.com/luminaires](http://www.philips.com/luminaires)

03/14

Philips Lighting  
North America Corporation  
200 Franklin Square Drive  
Somerset, NJ 08873  
Phone: 855-486-2216

Philips Lighting Company  
281 Hillmount Road  
Markham ON, Canada L6C 2S3  
Phone: 800-668-9008