

MOT

Translite Systems, Moto

Page 1 of 2

System Options

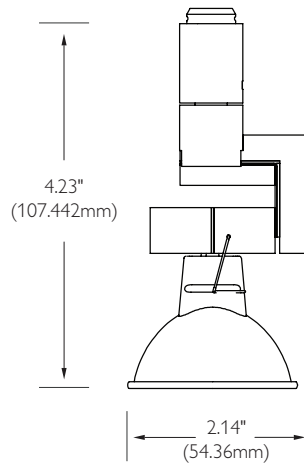
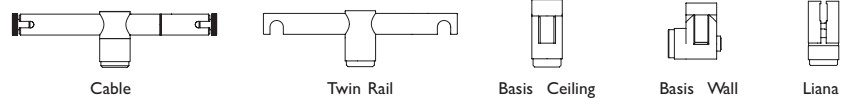

Ordering Information

Fixture	System	Overall Length	Optional Lamping	Metal Finish
MOT - Moto	CA4 – Cable 4" CA6 – Cable 6" TR4 – Twin Rail 4" TR6 – Twin Rail 6" BTC - Basis Ceiling BTW - Basis Wall (max. 16") LT - Liana NS - No System Connector*	Stem: ST - Standard 5" 6" - 72" – Specify Length (in 6" increments) (When ordering a non-standard length, use whole numbers only - no fractional inches.)	27F Philips EnduraLED 7 watt 2700K 24° flood 30F Philips EnduraLED 7 watt 3000K 24° flood	AL - Satin Aluminum PN - Polished Nickel RB - Rubbed Bronze (Rubbed Bronze is not available for Twin Rail)

Job Information Type:

Job Name:

Cat. No.:

Notes:

PHILIPS
LIGHTOLIER

MOT

Translite Systems, Moto

Page 2 of 2

System Options

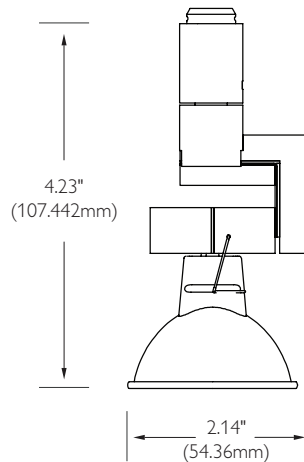
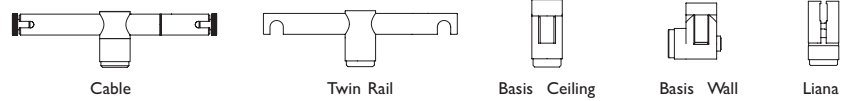

Features

- Description:** Precision machined, monolithic wireless conductive, adjustable luminaire.
- System Options:** Moto is available for Cable 4" & 6", Twin Rail 4" & 6", Basis Ceiling Mount, Basis Wall Mount, Liana and low voltage monopoints.
- Lamping:** MR16 50w max. For use with open fixture rated lamp only.
- Electrical:** Transjack connector contacts utilize 24kt gold plated brass pin and sleeve connectors housed in aluminum.
- Function:** Rotates 360 degrees and pivots 250 degrees at socket lockable orientation. Overall length not field adjustable.
- Net weight:** .25 lbs.

Accessories

Lens clip, single and double accessory holder, shields, snoot and barn doors, lenses, louver and filters.

Metal Finishes

- Satin Aluminum
- Polished Nickel
- Rubbed Bronze - finish is crafted with a solid brass substrate and buffed by hand to create an authentic rubbed bronze finish. Due to this hand-applied process, finish may vary.

Labels

UL and cUL listed for dry locations.



Philips Lightolier
e: lol.webmaster@philips.com
t: (508) 679-8131
w: www.lightolier.com

MOT October 31, 2011

Specifications are subject to change without notice.
© Koninklijke Philips Electronics N.V., 2011. All rights reserved.

Job Information Type: