

# DFS1 Series

## DecoFlood Mini-Spot - 22-39W HID (Mini MasterColor)

Type:	Job:										Approvals:	
Catalog Number:												
- - <b>E - 120</b> - - - -												
Series/Source-Wattage	Distribution	Ballast	Voltage	Style	Mounting	Options	Lens	Option(s)	Finish	Accessories (Field Installed)	Date: Page 1 of 8	

Date:  
Page 1 of 8

### Overall Dimensions *For Reference Only* See Style and Mounting Details.

#### DFS1 Mini-Spot

Weight:  
9.0 lbs (4.08 kgs)  
EPA (sq ft):  
0.5

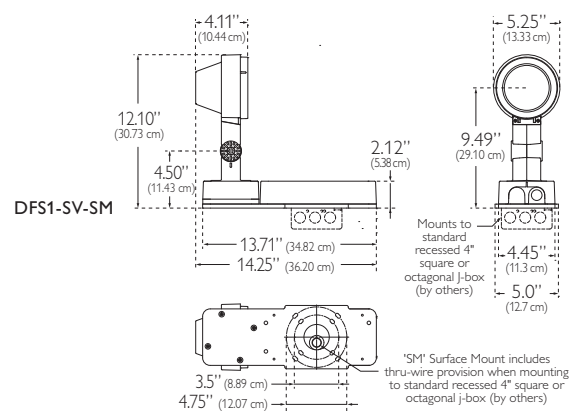
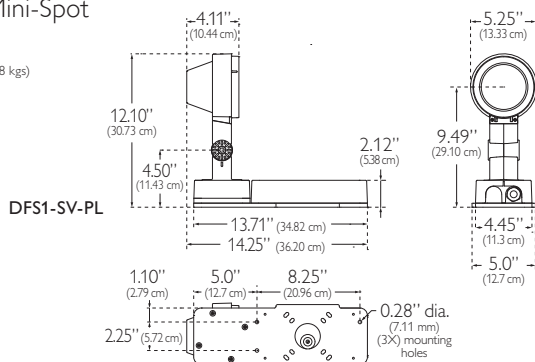

### Specifications

#### Optical System / Available Distributions

- NB Narrow Beam
  - MB Medium Beam
  - WB Wide Beam
- See optical data for details.

#### Housing / Construction

Die-cast aluminum housing and silicone gasket.  
Optic chamber constructed to IP65.

#### Lamp / Socket

DFS1 utilizes Philips Mini MasterColor ceramic metal halide CDM-Tm lamps with PGJ5 base.  
CCT: 3000 K.  
See distribution guide for details.

#### Ballast / Voltage

The electronic ballast shall operate from a nominal line voltage of 120V, +/- 10%, 50/60 Hz.  
Input current total harmonic distortion (THD) < 15%. Power factor > 90%.  
Lamp end-of-life detection and shutdown circuit.  
Sound rated A. Output frequency to the lamps < 200 Hz to prevent acoustic resonance inside the lamp arc tube to minimize visible flicker.  
Lamp current crest factor < 1.5.  
Ballast is thermally protected to shut off when operating temperatures reach unacceptable levels.  
Furnished with integral, color-coded leads.  
Maximum rated case temperature 90°C (194°F).  
Maximum lamp to ballast distance: 6 ft (2 m).  
See distribution guide for details.

#### Style

- SV Swivel Attached Box (anchors by others)
- SVRB Swivel Remote Box (anchors by others)

#### Mounting

- PL Plate Mount (anchors by others)
- SM Surface Mount (to 4" J-box by others) (anchors by others)

#### Options (pre-attached)

**Internal Shielding:**  
Internal Half Round Louver 'HRL' and Internal Full Round Louver 'RL' options are available. (Shielding is black unless otherwise specified).

#### Lens Options

Lens options includes a pre-attached lens holder that can hold up to two lenses.

#### Spread Lenses:

- BSO Beam Softener
- HLBSP Beam Spreader Horizontal
- VLBSP Beam Spreader Vertical

#### Color Lenses:

- SGFBL Solgel Blue Filter
- SGFLB Solgel Light Blue Filter
- SGFYE Solgel Yellow Filter
- SGFGN Solgel Green Filter
- SGFMG Solgel Magenta Filter

#### Color Temp Lenses:

- WAF1 Warm n°1 Solgel Filter
- WAF2 Warm n°2 Solgel Filter
- WAF3 Warm n°3 Solgel Filter
- COF2 Cool n°2 Solgel Filter
- COF3 Cool n°3 Solgel Filter
- COF4 Cool n°4 Solgel Filter

#### Finish

##### Standard finishes:

- TWO Two-Tone (dark gray, silver)
  - TBK Textured Black
  - TDB Textured Dark Bronze
  - TSA Textured Satin Aluminum
  - TWHT Textured White
  - TGN Textured Green
  - TGR Textured Gray
  - TPG Textured Philips Gray
- Custom RAL colors may be specified.

#### Accessories (ordered separately)

##### External Shielding:

Glare shield (visor) 'GS-DFS1' accessory available. (Shielding is black unless otherwise specified).

#### Aiming (when mounted to horizontal surface)

DFS1 can be aimed 67.5° up or 67.5° down.  
See Aiming Diagrams.

#### Listings

ETL/cETL Listed luminaire, to the UL 1598 standard, suitable for Wet Locations. The quality systems of this facility have been registered by UL to the ISO 9001 Series Standards.

#### Warranty / Terms and Conditions

Philips Gardco luminaires feature a 5 year limited warranty. See Warranty Information on [www.sitelighting.com](http://www.sitelighting.com) for complete details and exclusions. Polycarbonate lenses carry a 1 year warranty only.

**Hg** Some luminaires use fluorescent or high intensity discharge (HID) lamps that contain small amounts of mercury. Such lamps are labeled 'Contain Mercury' and/or with the symbol 'Hg'. Lamps that contain mercury must be disposed of in accordance with local requirements. Information regarding lamp recycle and disposal can be found at [www.lamprecycle.org](http://www.lamprecycle.org).

**PHILIPS**

**GARDCO**

# DFS1 Series

## DecoFlood Mini-Spot - 22-39W HID (Mini MasterColor)

Type:	Job:	Page 2 of 8
-------	------	-------------



DFS1-SV



DFS1-SVRB



Series	Distribution	Ballast	Voltage	Style	Mounting	Options
Mini MasterColor						Internal Shielding (pre-installed)
<input type="checkbox"/> <b>DFS1P-22</b>	<input type="checkbox"/> <b>NB</b> Narrow Beam	<input checked="" type="checkbox"/> <b>E</b> Electronic	<input checked="" type="checkbox"/> <b>120</b>	<input type="checkbox"/> <b>SV</b> Swivel Attached Box (anchors by others)	<input type="checkbox"/> <b>PL</b> Plate Mount (anchors by others)	<input type="checkbox"/> <b>HRL</b> Half Round Louver
<input type="checkbox"/> <b>DFS1P-39</b>	<input type="checkbox"/> <b>MB</b> Medium Beam			<input type="checkbox"/> <b>SVRB</b> Swivel Remote Box (anchors by others)	<input type="checkbox"/> <b>SM</b> Surface Mount (to 4" J-Box by others) (anchors by others)	<input type="checkbox"/> <b>RL</b> Full Round Louver
	<input type="checkbox"/> <b>WB</b> Wide Beam <small>See optical data tables for specific beam and candela information.</small>					
Notes: 1. Lens options include lens holder that can hold up to two lenses. Lens holder comes pre-attached to the fixture. Photometry for the 'BSO' lens should be used for reference only. Lens performance can vary slightly due to manufacturing tolerances.						

Lens Options (includes lens holder, holds up to two lenses)			Finish	Accessories (must be ordered separately)
<b>Spread Lenses<sup>1</sup></b> <input type="checkbox"/> <b>BSO</b> Beam Softener <input type="checkbox"/> <b>HLBSP</b> Beam Spreader Horizontal <input type="checkbox"/> <b>VLBSP</b> Beam Spreader Vertical	<b>Color Temp Lenses<sup>1</sup></b> <input type="checkbox"/> <b>WAF1</b> Warm n°1 Solgel Filter <input type="checkbox"/> <b>WAF2</b> Warm n°2 Solgel Filter <input type="checkbox"/> <b>WAF3</b> Warm n°3 Solgel Filter <input type="checkbox"/> <b>COF2</b> Cool n°2 Solgel Filter <input type="checkbox"/> <b>COF3</b> Cool n°3 Solgel Filter <input type="checkbox"/> <b>COF4</b> Cool n°4 Solgel Filter	<b>Color Lenses<sup>1</sup></b> <input type="checkbox"/> <b>SGFBL</b> Solgel Blue Filter <input type="checkbox"/> <b>SGFLB</b> Solgel Light Blue Filter <input type="checkbox"/> <b>SGFYE</b> Solgel Yellow Filter <input type="checkbox"/> <b>SGFGN</b> Solgel Green Filter <input type="checkbox"/> <b>SGFMG</b> Solgel Magenta Filter	<input type="checkbox"/> <b>TWO</b> Two-Tone (dark gray, silver) <input type="checkbox"/> <b>TBK</b> Textured Black <input type="checkbox"/> <b>TDB</b> Textured Dark Bronze <input type="checkbox"/> <b>TSA</b> Textured Satin Aluminum <input type="checkbox"/> <b>TWHT</b> Textured White <input type="checkbox"/> <b>TGN</b> Textured Green <input type="checkbox"/> <b>TGR</b> Textured Gray <input type="checkbox"/> <b>TPG</b> Textured Philips Gray <input type="checkbox"/> <b>RAL(*)</b> Specify Custom RAL color number	<b>External Shielding</b> (shielding is black unless otherwise specified) <input type="checkbox"/> <b>GS-DFS1</b> Glare Shield (visor)

# DFS1 Series

## DecoFlood Mini-Spot - 22-39W HID (Mini MasterColor)

Type:	Job:	Page 3 of 8
-------	------	-------------

### Distribution Guide and Ballast Data <sup>1</sup>

Mini MasterColor Series/Source-Wattage	Lamp <sup>2</sup> / Base Axial orientation	Ballast Type	ANSI Code	Initial Lamp Lumens	Rated Life (hrs)	Line Current 120V	Line Watts
DFS1P-22	T3.5 / PGJ5	Electronic	C175/E	1,650	12,000	0.23	26
DFS1P-39	T3.5 / PGJ5	Electronic	C179/E	3,000	12,000	0.40	45

#### Notes

1) Photometry available online. IES file names reflect catalog logic.

2) Mini MasterColor CMH lamps ordering code:

22W: CDM20/TM/830 (CDM-Tm 20W/830)  
with CCT of 3000 K and CRI of 85,

39W: CDM35/TM/930 (CDM-Tm 35W/930)  
with CCT of 3000 K and CRI of 90.

(Lamp envelope BT5 has been replaced with T3.5)

### Optical Data

Cat No.	Optic	Initial Lamp Lumens	Max CD	50% Main Beam (hor.)	50% Main Beam (vert.)	10% Field Beam (hor.)	10% Field Beam (vert.)	NEMA Beam (hor.)	NEMA Beam (vert.)	Lamp Type	Base	Lamp Axis	IES File #
Mini MasterColor (CMH Pulse Start)													
DFS1P-22	NB	1,650	34,658	6.6°	6.6°	17.1°	17.1°	1H	1V	T3.5	PGJ5	Axial	DFS1P-22-NB.IES
	MB	1,650	8,097	16.0°	16.0°	35.9°	35.9°	3H	3V	T3.5	PGJ5	Axial	DFS1P-22-MB.IES
	WB	1,650	3,736	22.0°	22.0°	58.0°	58.0°	4H	4V	T3.5	PGJ5	Axial	DFS1P-22-WB.IES
DFS1P-39	NB	3,000	63,014	6.6°	6.6°	17.1°	17.1°	1H	1V	T3.5	PGJ5	Axial	DFS1P-39-NB.IES
	MB	3,000	14,721	16.0°	16.0°	35.9°	35.9°	3H	3V	T3.5	PGJ5	Axial	DFS1P-39-MB.IES
	WB	3,000	6,793	22.0°	22.0°	58.0°	58.0°	4H	4V	T3.5	PGJ5	Axial	DFS1P-39-WB.IES

### Aiming Diagrams (when mounted to a horizontal surface)

#### DFS1

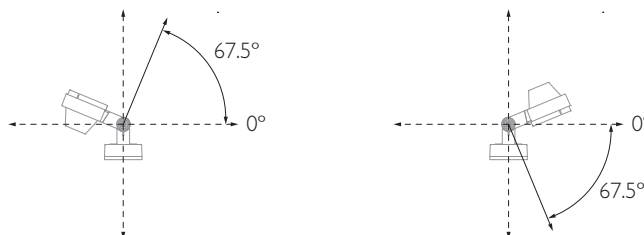

# DFS1 Series

## DecoFlood Mini-Spot - 22-39W HID (Mini MasterColor)

Type:	Job:	Page 4 of 8
-------	------	-------------

### Style and Mounting Details

#### DFS1-SV-PL

- DFS1 DecoFlood Mini-Spot
- 'SV' Swivel attached box
- 'PL' Plate mount

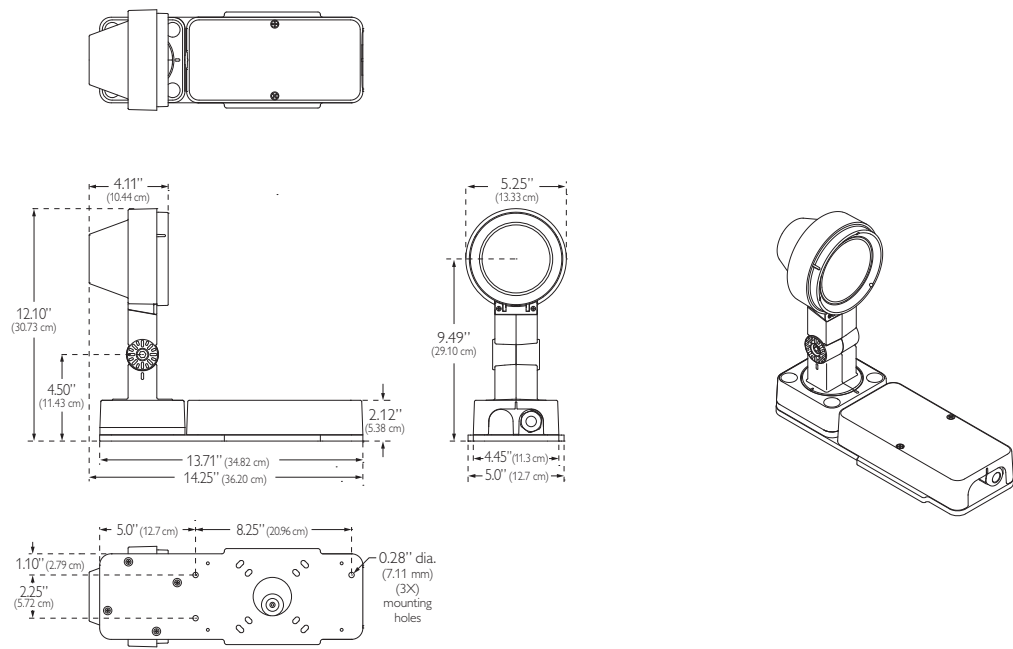

#### DFS1-SV-SM

- DFS1 DecoFlood Mini-Spot
- 'SV' Swivel attached box
- 'SM' Surface mount

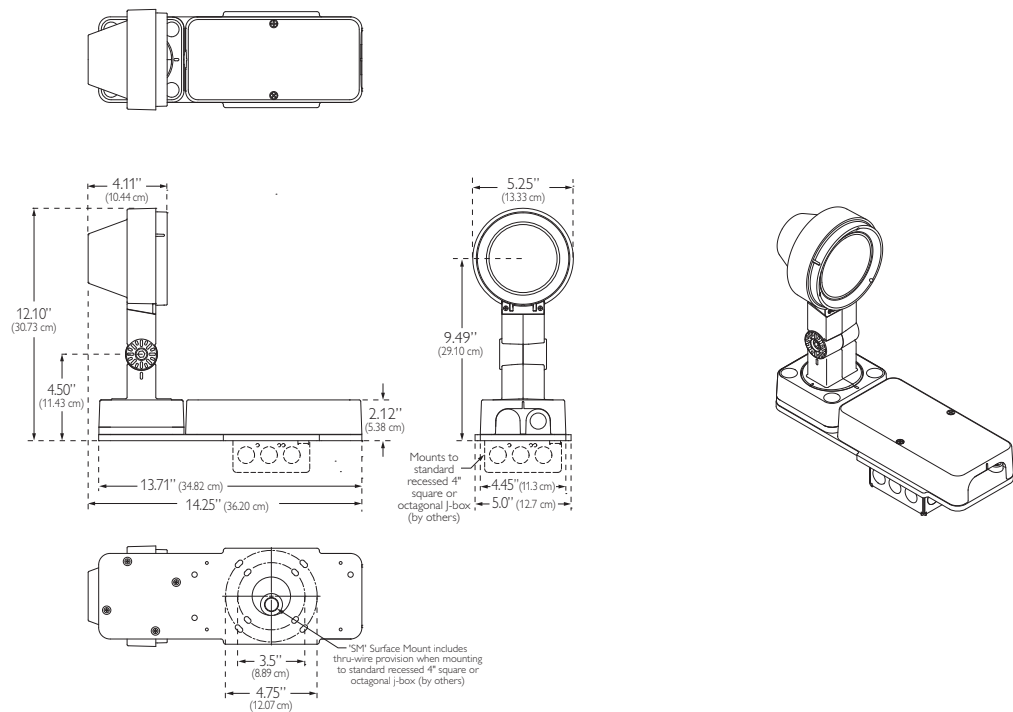

# DFS1 Series

## DecoFlood Mini-Spot - 22-39W HID (Mini MasterColor)

Type:	Job:	Page 5 of 8
-------	------	-------------

### Style and Mounting Details (continued)

#### DFS1-SVRB-PL

DFS1 DecoFlood Mini-Spot

'SVRB' Swivel remote box

'PL' Plate mount

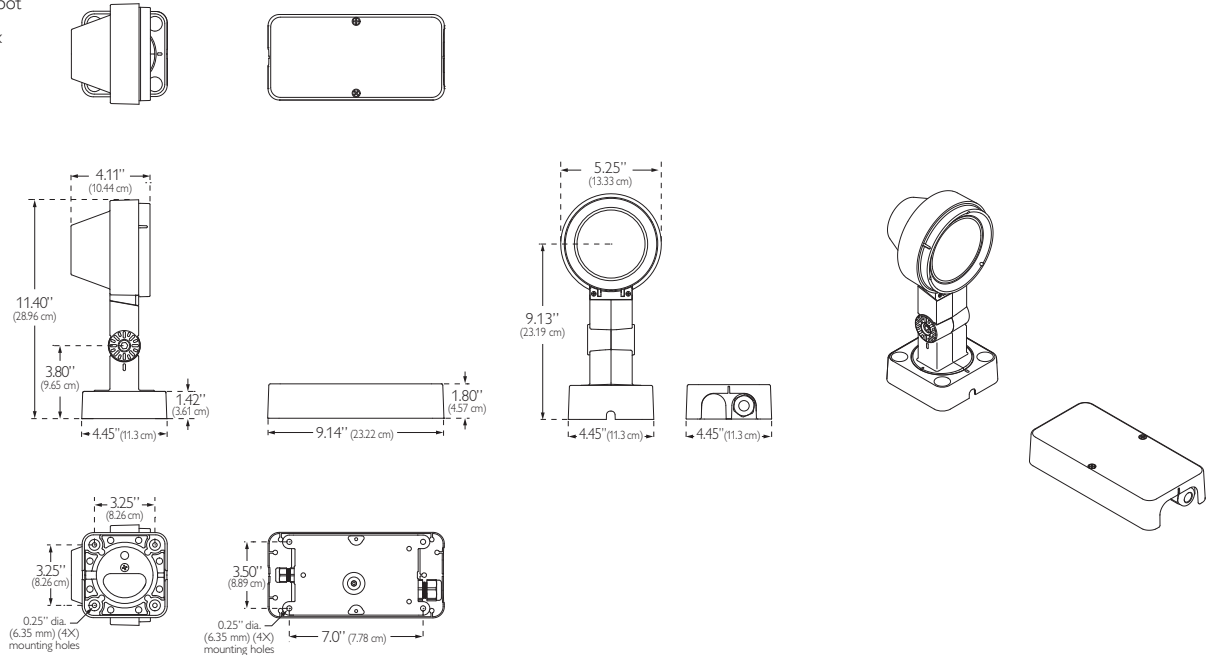

#### DFS1-SVRB-SM

DFS1 DecoFlood Mini-Spot

'SVRB' Swivel remote box

'SM' Surface mount

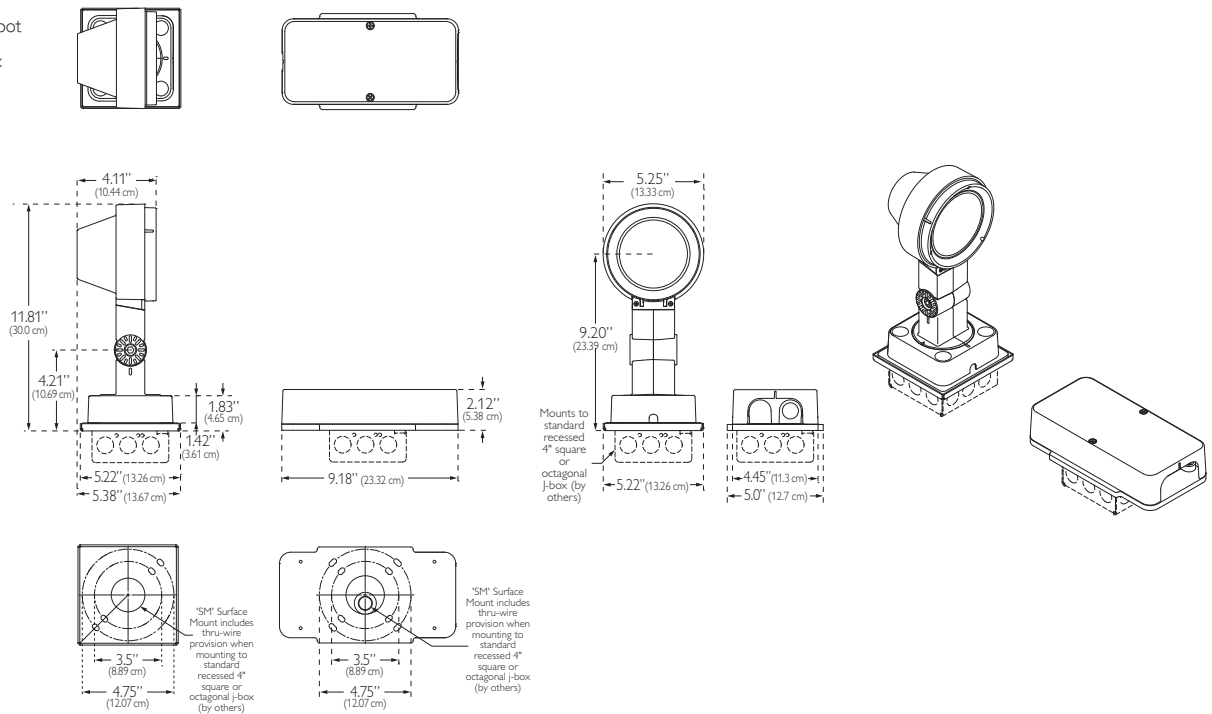

# DFS1 Series



## DecoFlood Mini-Spot - 22-39W HID (Mini MasterColor)

Type:	Job:	Page 6 of 8
-------	------	-------------

Option Details (factory installed)

Internal Shielding options Pre-attached

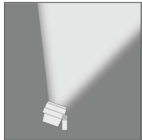
**HRL**  
Internal Half Round Louver  
(ships installed)

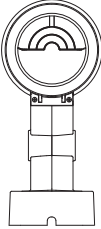

Helps to limit glare and spill light in one direction

**RL**  
Internal Full Round Louver  
(ships installed)

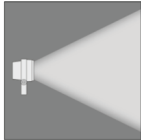
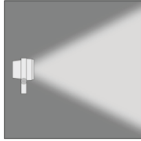
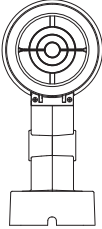

Helps to limit glare and spill light in all directions

Lens Option Details (Includes factory installed lens holder that can hold up to two lenses, or one lens option and the stone guard option.)

External Lens Holder

(included with any lens option or stone guard option)  
(ships installed)

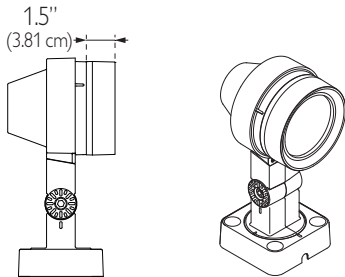

Spread Lenses

May be combined with a color or color temp lens. Beam images are for reference only.



**Clear Glass**  
(standard) beam is unchanged



**BSO**  
Beam Softener  
softens beam in both directions



**HLBSP**  
Beam Spreader Horizontal  
unidirectional horizontal beam spreader



**VLBSP**  
Beam Spreader Vertical  
unidirectional vertical beam spreader

Color Lenses

<b>SGFBL</b>	Solgel Blue Filter	Lee/Rosco equivalent:	Medium blue 132
<b>SGFLB</b>	Solgel Light Blue Filter	Lee/Rosco equivalent:	Marine blue 131
<b>SGFYE</b>	Solgel Yellow Filter	Lee/Rosco equivalent:	Yellow 101
<b>SGFGN</b>	Solgel Green Filter	Lee/Rosco equivalent:	Primary green 139
<b>SGFMG</b>	Solgel Magenta Filter	Lee/Rosco equivalent:	Calcolor Pink 4890

Color Temp Lenses

		installed lamp CCT (no filter)	approx. % change with filter	resulting CCT with filter
<b>WAF1</b>	Warm n°1 Solgel Filter	3000 K	-23.3%	2300 K
<b>WAF2</b>	Warm n°2 Solgel Filter	3000 K	-16.7%	2500 K
<b>WAF3</b>	Warm n°3 Solgel Filter	3000 K	-10.0%	2700 K
<b>COF2</b>	Cool n°2 Solgel Filter	3000 K	+26.7%	3800 K
<b>COF3</b>	Cool n°3 Solgel Filter	3000 K	+16.7%	3500 K
<b>COF4</b>	Cool n°4 Solgel Filter	3000 K	+10.0%	3300 K

Color Temp Lenses are used to adjust the color temperature of the existing lamp to a warmer or cooler CCT depending on the surface to be illuminated. Approximate percentage change in CCT (warmer or cooler) with filter is shown. Results can vary by lamp type, source, and optical distribution.

# DFS1 Series

## DecoFlood Mini-Spot - 22-39W HID (Mini MasterColor)

Type:	Job:	Page 7 of 8
-------	------	-------------

External Shielding Accessory Details (black unless otherwise specified) (must be ordered separately) (beam images are for reference only)

### GS-DFS1

Glare Shield (visor)

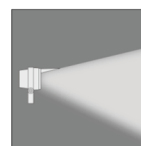
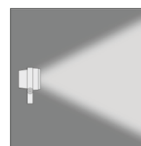
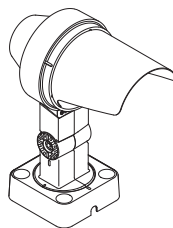
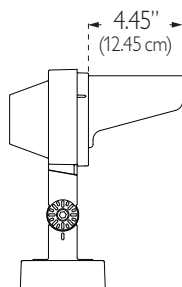

Helps to increase visual comfort from certain viewing angles without impairing the main distribution.

Notes



ISO 9001  
Certified



© 2014 Koninklijke Philips N.V. All rights reserved.

Philips reserves the right to make changes in specifications and/or to discontinue any product at any time without notice or obligation and will not be liable for any consequences resulting from the use of this publication.

Philips Lighting  
North America Corporation  
200 Franklin Square Drive  
Somerset, NJ 08873  
Tel. 855-486-2216

Imported by: Philips Lighting,  
A division of Philips Electronics Ltd.  
281 Hillmount Rd,  
Markham, ON, Canada L6C 2S3  
Tel. 800-668-9008